



Perfect performance and maximum Safety.

Reliable, flexible and optimized costs.



Product catalogue | entire product range

+ Hot Tapping + Bag-positioning devices + Stopple technology + Flow-stop bags + Service line-locksystems + Pipe plugs + Accessories + Pipe joint tester + Inflatable pipeline stoppers + Service-line test equipment + Measurement technology for leakage tests + Mechanical Stoppers + Accessories



Perfect performance and maximum Safety.

Reliable, flexible and optimized costs.





Dennis Wolff
Business Manager

Quality from practical knowledge

Städtler + Beck is a medium-sized craft enterprise with years of experience in development and manufacturing of Testing and Line Stopping Technology for Sewer- and Gas pipelines. As a traditional family business, we are proud to manufacture our products locally in Speyer by ourselves and improving these even further. Our customers from Germany and worldwide are convinced with these certificated products and services.

More than standard

We do not claim to be the greatest, but provide consistently high quality with maximum safety. Orders are usually mounted exactly as required by hand. Because of our great number of practical experience and unbureaucratic ways we always find reasonable solutions that benefit everyone involved in a same-level partnership. Also in the growing international business, we remain true to our values and offer solid quality "Made in Germany".

Partnership on a level playing field

As a responsible medium-sized company an open and honest relationship is self-evident for us – whether with our employees or customers.

We do not promise more than we can keep. We stand by our social responsibilities as a training company and are committed to the city and region. Our employees are working preferably self-sufficient and responsibly. They invest their experience with heart and mind by manufacturing our products which are simple and innovative.

 **+49 (0) 6232. 3189-0**

Your contact details

company: _____

street address: _____

ZIP/city: _____

contact person: _____

phone/fax: _____

e-mail: _____

- ☐ **Free device and application demonstration / comparison of operating costs**
- ☐ Contact regarding **checking our flow stop technology**
- ☐ Contact for a free **consultation regarding training of our employees**
- ☐ Contact for a free **consultation regarding testing our flow stop equipment / flow stop bags**

Our flow stop technology is from the following manufacturer:

- ☐ Städtler + Beck
- ☐ Other manufacturer: _____
- ☐ Send the **current product catalog** by e-mail.
- ☐ Registration for the e-mail **newsletter** of the Städtler + Beck GmbH.

Please reply this form by fax **+49 (0) 6232. 3189-20** or by e-mail **vertrieb@subgas.de**

date _____ signature _____

You can download our **current price list** on **www.subgas.de**

Inhalt

Hot Tapping and Stopples Devices	8	Pipe joint tester	86
• Hot Tapping Device	9	• MPG - Pipe joint tester	88
• Hot Tapping Device TITAN	11	» MPG MINI	88
• Stopples device – HSE	13	» MPG MAXI	89
Bag-positioning Equipment	25	• KOMUP / KOMUP DUO	92
• Bag-positioning device for double-bags DN 80 bis DN 300 with gap-venting	26	• MPG Powerline	94
• Bag-Positioning device DN 300 bis DN 600 with pre-pressure Measurement	30	• MUPP UNO/DUO	96
• MDA™ 1 bar – Multi-Diameter-Gas Bags	33	• MB - Multi-size pipe joint tester	99
• Gas bag with textile Cover for bag-positioning Devices	35	• Customized joint tester	101
• Gas bags from other manufactures	37	Manhole-pipe joint tester	102
• Gas locks for Pipe-cameras	38	Service-line/house-connection (HC) test equipment	103
• Accessories for Bag-positioning devices	39	• Leakage test set for HC- service line systems	103
» Pressure- and Suction Pump	39	• MDA double-bag test system	105
» Weld-on Sockets and Plugs	41	Sewer bags	107
» Tapping sleeves	42	• MDA 1 bar - flow-stop bags	108
» Fittings, Adapters, Valves	43	• MD - flow-stop bags	110
» Lock systems	44	» Flow-stop bags	110
» Bypass sets	46	» MD - Passage- and Bypass-flow-stop bags	114
Manual flow-stop bags	47	• S+B MD- flow-stop bags	118
• Manual bags with conical plug	49	» Flow-stop bags	118
• Manual bags with conical plug and pre-pressure measurement	51	» Test and bypass flow-stop bags	119
• Manual double bags with extra strong Cover	52	Accessories	121
• Manual push-bags	53	• Pipe-cleaning equipment	121
• Manual bags for forming gas welding	55		
• Replacement covers and rubber bladders	57		
House connection equipment (HC)	62		
• HC - Glove lock	62		
• Gas lock for main shut-off units	63		
• HC gas bags	64		
Pipe plugs	67		
• Overview for all plugs	67		
• Mechanical	68		
• Pneumatical	80		
Accessories	84		
• Repair patches	84		
• Jumper cable	85		

Hot Tapping and Stopple Devices

All Städtler + Beck tapping and stopple devices allow a leaking-free drilling and line stopping of in-use gas and water pipes.

Our devices have the following advantages:

You save a lot of money and space, because you can **drill all nominal diameter of pipes up to an operating pressure of 16 bar with only one tapping device.**

In addition, **the operating costs can be kept as low as possible**, because of our special designed power transmission with spring pre-load. During tapping the drill rod will be forced continuously, shock-free and steadily even at high speeds. This **allows the use of economical hole saws, reduces tool wear, maximizes the tool life and the availability of your tapping device.** In comparison to other equipment **time savings up to 50%** can be achieved.

Due to the spring-biased feed the **drillings can be carried out easily and quickly by hand.**

To make the tapping unit extremely durable, **all parts are delivered from factory with a technical surface treatment with a long-lasting protective coating against corrosion.**



Hot Tapping Device

The tapping tool is suitable for drilling pipes made of metal and plastic with a **bore diameter of 1 to 6 inches**.

In order to achieve satisfactory drilling results there are different drill bits available to choose from.

In-use gas and water pipelines can be tapped up to an operating pressure of **16 bar** without any leakage.

The devices are available in four different sizes with a travel from **130 mm to 700 mm**.

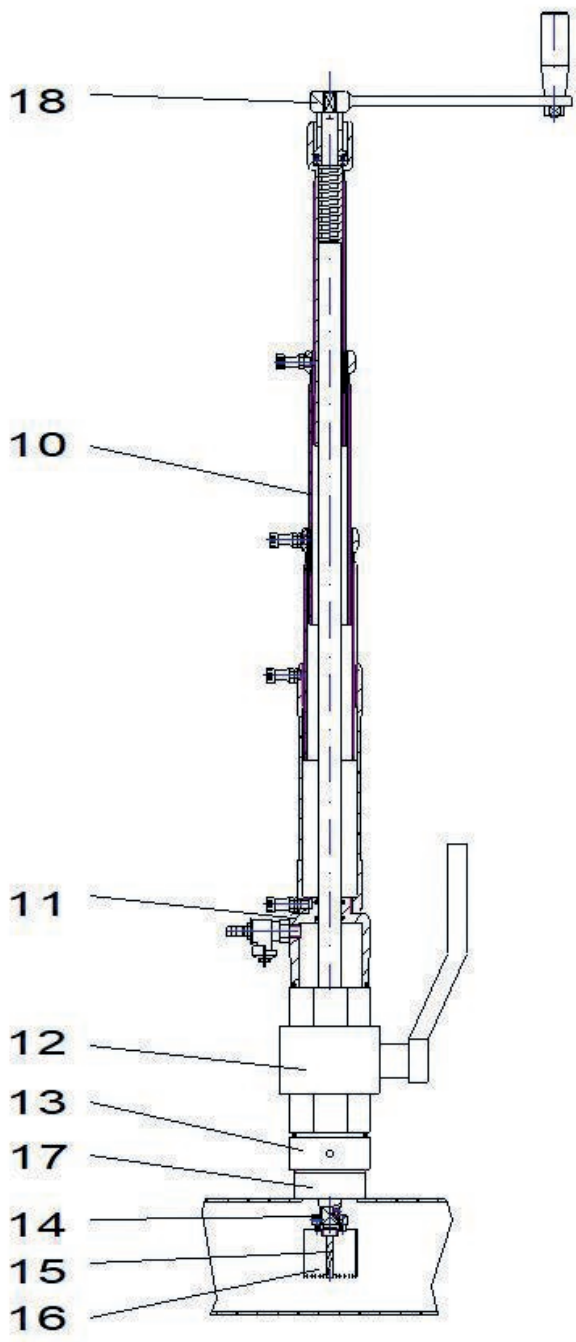

Construction

Pos.	Product	Order no.
10	Tapping device MAXI	20020001
11	Tapping dome	20050018
12	Adapter	00800140
13	Ball valve	00800119
14	Tool carrier	20040006
15	Pilot drill with barb	20040001
16	Bi-metal hole saw	20060005
17	Weld-on socket	00870127
18	Freewheel crank with 13mm square	20040009



Versions

Order no.	Product
20010001	Tapping device MAXI, max. travel 250 mm, 16 bar
02810020	Stopple device, max. travel 480 mm, [U_KAS_Gegendruck]
02810019	Stopple device, max. travel 700 mm, [U_KAS_Gegendruck]
20070002	Tapping device MAXI, max. travel 1000 mm, 16 bar

Delivery

- One drilling or Stopple device with integrated drilling rod
- Two pin punches
- One Allen key

In addition, all devices will be adapted to your application and equipped to your requirements from an extensive range of accessories. We will advise you on the selection and will support you to get your job perfectly done.

TITAN 8plus Hot Tapping and Line Stopping Device

The TITAN 8plus Hot Tapping and Line Stopping device is suitable for fast and safe stopping of gas and water pipelines without interrupting the operation up to an operating pressure of **8 bar**. It does not rely on conventional gas bags, but on a **very robust** rubber stopper.

This is centrally pressed into the tapped pipe, where it provides a **secure seal**.

The advantages of the TITAN 8plus Tapping and Line Stopping system are:

- Maximum operational safety and low wear due to the use of a special-Stopple (stop plug) to shut off lines with an operating pressure up to 8 bar
- Low material costs, because only the welded two-piece tees with flange, the screw plug and the blind flange have to remain permanently on the construction site
- Our special designed power transmission allows a shock-free and steadily tapping of the pipeline even at high speeds, thereby the device and tool are equally protected, which results in longer tool life and availability

We are glad to advise you on the use and configuration of your individual device.



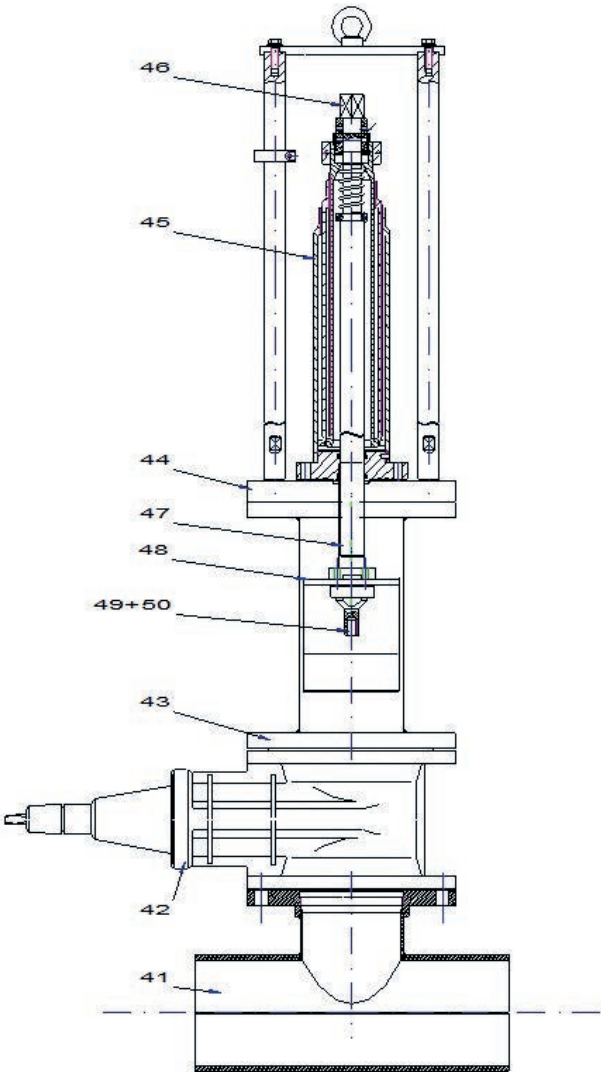

Construction

Pos.	Product	Order no.
41	Tee, 2-parts	69000015
42	Gate valve	69000023
43	Combi-lock	09000007
44	Adapter drilling device/combi lock	69000025
45	Tapping device for TITAN 8plus	69000001
46	Pneumatic drive	69000002
47	Tool carrier	09000009
48	HSS bi-metal hole saw	09000020
49	Pilot drill chuck	09000011
50	Pilot drill, HSS	69000029



Versions

Order no.	Product
69000001	Tapping device for TITAN 8plus, max. travel 650 mm, 4 bar, DN 80-300, 3"-12"
09000003	Torque absorber 650 mm
69000275	Tapping device for TITAN 8plus, max. travel 1200 mm, 4 bar, DN 80-300, 3"-12"
69000276	Torque absorber 1200 mm

Delivery

The TITAN 8plus includes an entire shutoff system and the delivery will be customized according to your application.

Stopples device – HSE (House- Service line- Stopples Unit)

Our Stopples devices are used for reliable stopping of pipelines with a nominal diameter of 100 mm in gas, water and district heating lines **up to a working pressure of 6 bar**. Optional they can be equipped with an **pre-pressure measurement**. These device are available in various sizes with **travels from 480 and 700 mm**.

For larger pipe diameter please use our line stopping device **TITAN 8plus**.

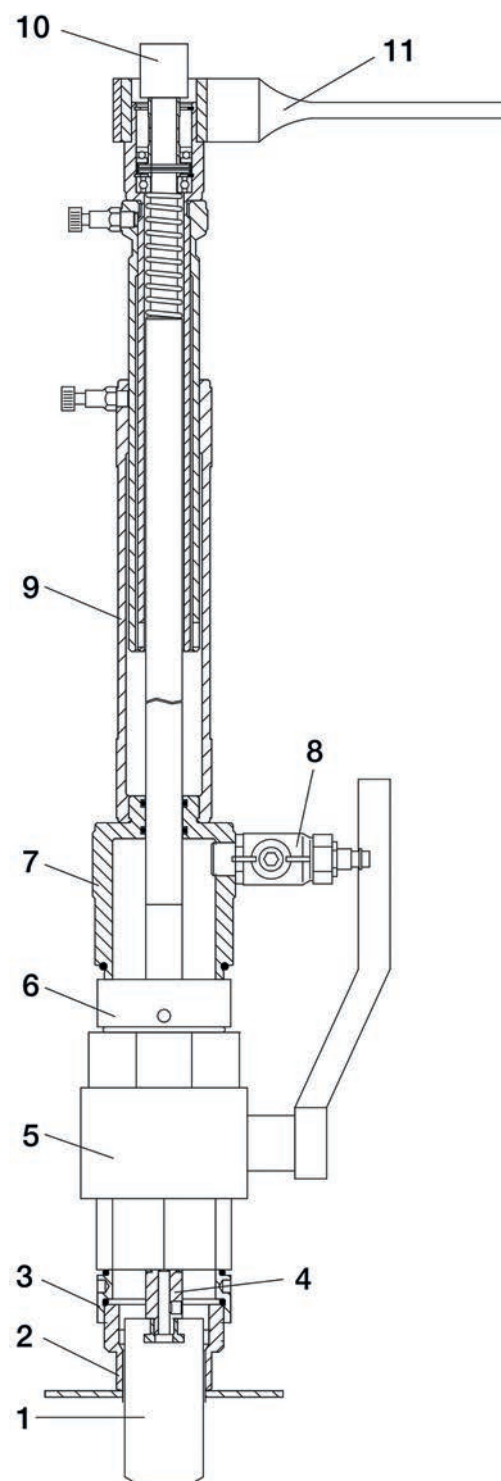

Construction

Pos.	Product	Order no.
1	Stopples, HSE with pre-pressure measurement	02810013
2	Weld-on socket for HSE	00870007
3, 6	Adapter	00800140
4	Tool carrier	20040008
5	Ball valve	00800119
7	Tapping dome	20050018
8	Ball valve	01000093
9	Stopples device	02810020
10	Cap with direction indicator for pre-pressure measurement	02810016
11	Freewheel ratchet to HSE	02810127



Versions

Order no.	Product
02810020	Stopple device, max. travel 480 mm, [U_KAS_Gegendruck]
02810019	Stopple device, max. travel 700 mm, [U_KAS_Gegendruck]
02810316	conversion kit for HSE DN100 DN 100

Delivery

- One drilling or stopple device with integrated drilling rod
- Two pin punches
- One Allen key
- Cap with direction indicator
- Freewheel ratchet

In addition, all devices will be adapted to your application and equipped to your wishes from an extensive range of accessories. We will advise you on the selection and will support you to get your job perfectly done.

Spareparts for Tapping and Stopple devices

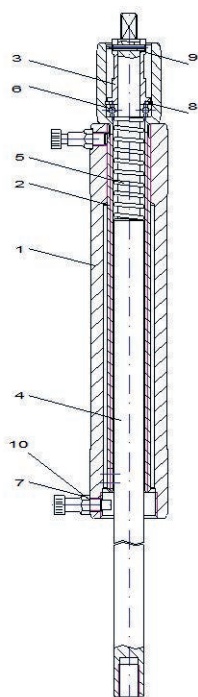

Tapping device type: 2001 (250 mm)

Pos.	Product	Unit	Order no.
	Spindle tube	1 Stück	20040097
	Spindle bolt	1 Stück	02810033
	Spring sleeve	1 Stück	20040089
	Pneumatic drive for S+B drilling device	1 Stück	20040013
	Compression spring	1 Stück	20040092
	Ball-Bearing	1 Stück	20040091
	Index bolt	2 Stück	20040102
	Retaining Ring	1 Stück	10010003
	Spring-type straight pin	1 Stück	20040090
	Washer	1 Stück	20040146

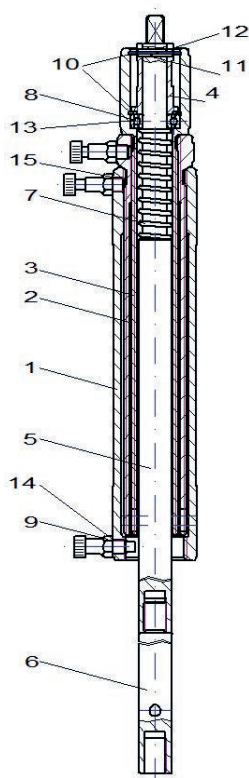

Tapping device MAXI type: 2002 (480 mm)

Pos.	Product	Unit	Order no.
1	Spindle tube	1 Stück	20040098
2	Spindle 2	1 Stück	02810032
3	Spindle bolt	1 Stück	02810033
4	Spring sleeve	1 Stück	02810035
5	Rotating rod	1 Stück	20020013
6	Spindle Extension	1 Stück	20040086
7	Compression spring	1 Stück	20040092
8	Ball-Bearing	1 Stück	20040091
9	Index bolt	3 Stück	20040102
10	Retaining Ring	2 Stück	10010003
11	Spring-type straight pin	1 Stück	20040090
12	Spring-type straight pin ø 3 mm	1 Stück	02810130
13	Axial bearing	1 Stück	02810034
14	Washer	1 Stück	20040146
15	Washer	1 Stück	20040147

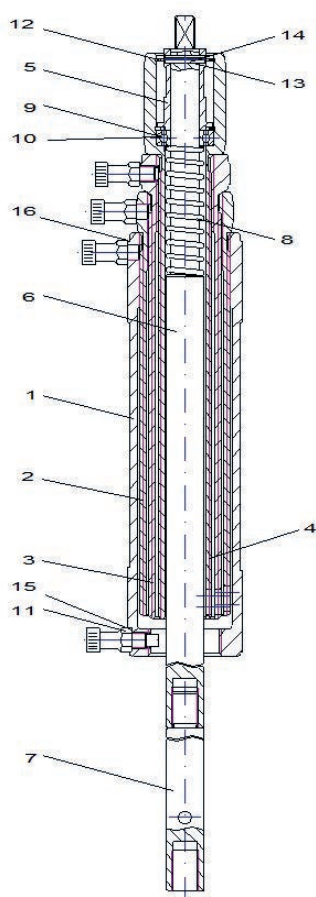

Tapping device MAXI type: 2003 (700 mm)

Pos.	Product	Unit	Order no.
1	Spindle tube	1 Stück	20040140
2	Spindle 1	1 Stück	20040139
3	Spindle 2	1 Stück	02810032
4	Spindle bolt	1 Stück	02810033
5	Spring sleeve	1 Stück	02810035
6	Rotating rod	1 Stück	20020013
7	Drilling rod extension	1 Stück	20040100
8	Compression spring	1 Stück	20040092
9	Ball-Bearing	1 Stück	20040091
10	Axial bearing	1 Stück	02810034
11	Index bolt	4 Stück	20040102
12	Retaining Ring	2 Stück	10010003
13	Spring-type straight pin	1 Stück	20040090
14	Spring-type straight pin ø 3 mm	1 Stück	02810130
15	Washer	1 Stück	20040146
16	Washer	1 Stück	20040147

Tapping device type: 2007 (1000 mm)

Pos.	Product	Unit	Order no.
	Spindle tube	1 Stück	20070004
	Spindle 1	1 Stück	20070005
	Spindle 2	1 Stück	20070006
	Spindle bolt	1 Stück	20070003
	Spring sleeve	1 Stück	02810035
	Rotating rod	1 Stück	20020013
	Drilling rod extension	1 Stück	20040100
	Drilling rod extension	1 Stück	20070007
	Compression spring	1 Stück	20040092
	Ball-Bearing	1 Stück	20040091
	Index bolt	1 Stück	20040102
	Retaining Ring	1 Stück	10010003
	Spring-type straight pin	1 Stück	20040090
	Washer	1 Stück	20040146

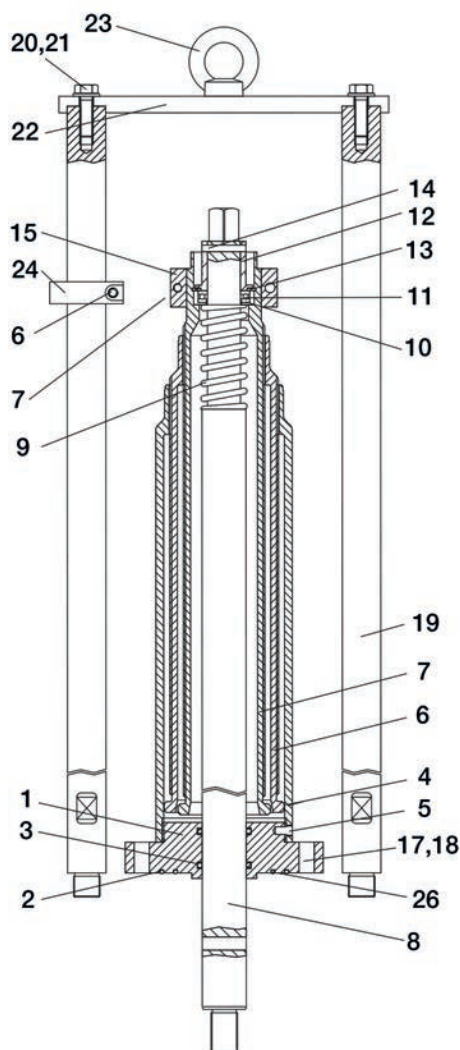

Tapping device type: Titan

Pos.	Product	Unit	Order no.
1	Adapter Titan	1 Stück	69000290
2	O-Ring, DVGW ø 110 x 3,5 mm	1 Stück	20010011
3	O-Ring, DVGW ø 40 x 4,5 mm	2 Stück	69000125
4	Spindle tube	1 Stück	69000101
5	Bolt	1 Stück	69000222
6	Spindle	1 Stück	69000102
7	Spindle	1 Stück	69000100
8	Rotating rod	1 Stück	09000004
9	Spring	1 Stück	69000004
11	Axial bearing	1 Stück	69000005
12	Spring sleeve for hot tapping device TITAN 8plus	1 Stück	69000288
14	Locking pin 6 x 40 mm	2 Stück	69000294
15	Clamping ring	1 Stück	69000291
16	Cyl. screw M8 x 25	2 Stück	00800064
17	Washer M12 (A13), galvanized	8 Stück	20010163
18	Hex. screw M12 x 55, galvanized	8 Stück	69000120
26	O-Ring, DVGW, Ø 85 x 3,5 mm	1 Stück	20010010
22	Traverse	1 Stück	69000229
19	Guide rod, galvanized	3 Stück	69000230
20	Washer M12 (A13), galvanized	3 Stück	20010163
21	Hex. screw M12 x 40, galvanized	3 Stück	01000652
24	Clamping ring, galvanized	1 Stück	69000231
25	Cyl. screw M8 x 25	1 Stück	00800064

Accessories for Tapping and Stopple devices



Tapping dom

Compatible with all drilling equipment and available in **sizes from 1 to 6 Inches**.

Order no.	Product
20050010	Tapping dome, 1"
20050012	Tapping dome, 1 ¼"
20050014	Tapping dome, 1 ½"
20050016	Tapping dome, 2"
20050018	Tapping dome, 2 ½"
20050020	Tapping dome, 3"
20050022	Tapping dome, 4"
20050024	Tapping dome, 5"
20050026	Tapping dome, 6"



Stopple

Compatible with all Stopple equipment and available in **sizes from 1 to 6 Inches**.

Order no.	Product
02810514	Stopple, HSE, 1"
02810005	Stopple, HSE, 1 ¼"
02810525	Stopple, HSE, 1 ½"
02810007	Stopple, HSE, 2"
02810535	Stopple, HSE, 2 ½"
02810540	Stopple, HSE, 3"
02810314	Special locking stubble 4 barGas seal rubber compound approx. 40°shore:Ø 96, 4"



Stopple with pressure measurement

Compatible with all Stopple equipment and available in **sizes from 1 to 6 Inches**.

Order no.	Product
02810515	Stopple, HSE, with pressure measurement, 1"
02810011	Stopple, HSE, with pressure measurement, 1 ¼"
02810526	Stopple, HSE, with pressure measurement, 1 ½"
02810013	Stopple, HSE with pre-pressure measurement, 2"
02810536	Stopple, HSE, with pressure measurement, 2 ½"
02810541	Stopple, HSE, with pressure measurement, 3"
02810411	Stopple, HSE, with pressure measurement, 4"



Stopple for district heating and oil

Compatible with all Stopple equipment and available in **sizes from 1 to 2 ½ Inches**.

Order no.	Product
02810021	Stopple HSE for district heating, 1"
02810023	Stopple HSE for district heating, 1 ¼"
02810025	Stopple HSE for district heating, 1 ½"
02810027	Stopple HSE for district heating, 2"
02810029	Stopple HSE for district heating, 2 ½"
02810347	Stopple HSE for district heating, 3"
02810348	Stopple HSE for district heating, 4"



O-Ring set for tapping dome (NBR)

NBR (Nitrile-Butadiene-Rubber) has a high resistance to oils, greases and hydrocarbons

Order no.	Product
20040151	O-Ring set for tapping dome, NBR, 1"
20040152	O-Ring set for tapping dome, NBR, 1 ¼"
20040153	O-Ring set for tapping dome, NBR, 1 ½"
20040154	O-Ring set for tapping dome, NBR, 2"
20040155	O-Ring set for tapping dome, NBR, 2 ½"
20040156	O-Ring set for tapping dome, NBR, 3"
20040157	O-Ring set for tapping dome, NBR, 4"
20040158	O-Ring set for tapping dome, NBR, 5"
20040159	O-Ring set for tapping dome, NBR, 6"



O-Ring set for tapping dome (VITON)

made of Viton for higher thermal and chemical resistance

Order no.	Product
20040160	O-ring set for drilling dome, Viton, 1"
20040161	O-ring set for drilling dome, Viton, 1 ¼"
20040162	O-ring set for drilling dome, Viton, 1 ½"
20040163	O-ring set for drilling dome, Viton, 2"
20040164	O-ring set for drilling dome, Viton, 2 ½"
20040165	O-ring set for drilling dome, Viton, 3"
20040166	O-ring set for drilling dome, Viton, 4"
20040167	O-ring set for drilling dome, Viton, 5"
20040168	O-ring set for drilling dome, Viton, 6"



Tool carrier

Order no.	Product
20040008	Tool carrier, 1" - 1 ¼"
20040006	Tool carrier, 1 ½" - 6"



Drilling rod extension

Order no.	Product
20040099	Drilling rod extension 100 mm



Tapping drive

Order no.	Product
20040013	Pneumatic drive for S+B drilling device

Technical specifications	
Operating pressure	6,0 bar
Power	0,7 kW
Air consumption	0,85 m³/min
Idlespeed	110 U/min
Speed on max. torque	55 U/min
Max. torque	120 Nm



Maintenance unit

Order no.	Product
30000001	Maintenance unit for pneumatic drive with pressure reducer in a sturdy metal frame



Freewheel crank

Order no.	Product
20040009	Freewheel crank with 13mm square



Freewheel ratchet for HSE

Order no.	Product
02810127	Freewheel ratchet to HSE



Pilot drills

Order no.	Product
20040003	HSS pilot drill
20040001	Pilot drill with barb
20040104	Replacement barbs
20040004	Pilot drill with carbide cutting edges



Bi-metal hole saws

Bi-metal hole saws for steelpipes

Order no.	Product
20060001	Bi-metal hole saw, ø 22
20060056	Bi-metal hole saw, ø 24
20060063	Bi-metal hole saw, ø 25
20060002	Bi-metal hole saw, ø 29
20060057	Bi-metal hole saw, ø 33
20060003	Bi-metal hole saw, ø 38
20060076	Bi-metal hole saw, ø 44
20060004	Bi-metal hole saw, ø 48
20060028	Bi-metal hole saw, ø 51
20060005	Bi-metal hole saw, ø 55
20060045	Bi-metal hole saw, ø 56
20060058	Bi-metal hole saw, ø 65
20060006	Bi-metal hole saw, ø 70
20060065	Bi-metal hole saw, ø 79
20060032	Bi-metal hole saw, ø 89
20060007	Bi-metal hole saw, ø 98
20060008	Bi-metal hole saw, ø 121
20060060	Bi-metal hole saw, ø 127
20060009	Bi-metal hole saw, ø 140



HM hole saws

Hole saws with carbide tipped teeth for steel and castiron pipes

Order no.	Product
20060010	HM hole saw, ø 22
20060066	HM hole saw, ø 24
20060034	HM hole saw, ø 25
20060011	HM hole saw, ø 29
20060012	HM hole saw, ø 38
20060013	HM hole saw, ø 48
20060050	HM hole saw, ø 51
20060014	HM hole saw, ø 54
20060037	HM hole saw, ø 56
20060048	HM hole saw, ø 65
20060015	HM hole saw, ø 70
20060049	HM hole saw, ø 79
20060033	HM hole saw, ø 89
20060016	HM hole saw, ø 98
20060017	HM hole saw, ø 121
20060067	HM hole saw, ø 127
20060018	HM hole saw, ø 140



Hole saws for PE-Pipes

Hole saws for drilling on PE-Pipes

Order no.	Product
20060019	Hole saw for PE-Pipes, ø 22
20060068	Hole saw for PE-Pipes, ø 24
20060020	Hole saw for PE-Pipes, ø 29
20060047	Hole saw for PE-Pipes, ø 32
20060021	Hole saw for PE-Pipes, ø 38
20060022	Hole saw for PE-Pipes, ø 48
20060023	Hole saw for PE-Pipes, ø 55
20060024	Hole saw for PE-Pipes, ø 70
20060046	Hole saw for PE-Pipes, ø 84
20060069	Hole saw for PE-Pipes, ø 89
20060025	Hole saw for PE-Pipes, ø 98
20060026	Hole saw for PE-Pipes, ø 121
20060070	Hole saw for PE-Pipes, ø 127
20060027	Hole saw for PE-Pipes, ø 140

Accessories for TITAN 8plus



Pneumatic drive

Order no.	Product
69000002	Pneumatic drive

Tech. specifications

Operating pressure	6,0 bar
Power	3,7 kW
Air consumption	4 m³/min
Loudness	103,8 db



Combi locks

Order no.	Product
69000369	Kombi-Schleuse, PN 16, DN 80/ 200
69000370	Kombi-Schleuse, PN 16, DN 100/ 200
69000371	Kombi-Schleuse, PN 16, DN 150/ 200
69000270	Kombi-Schleuse, PN 16, DN 200/ 350
69000271	Kombi-Schleuse, PN 16, DN 300/ 350



Adapter drilling device/combi lock

Order no.	Product
69000025	Adapter drilling device/combi lock, DN 200
69000026	Adapter drilling device/combi lock, DN 350



Tool carrier and pilot drills

Order no.	Product
69000372	Zentrierbohreraufnahme, DN 80-150
69000373	Fräseraufnahme, DN 80-150
69000029	Pilot drill, HSS, DN 80-300
69000274	Zentrierbohreraufnahme, DN 200-300
69000321	Fräseraufnahme, DN 200-300



Hole Saws

Order no.	Product
09000013	HSS bi-metal hole saw, ø 80
09000019	HSS bi-metal hole saw, ø 98
09000014	HSS bi-metal hole saw, ø 105
09000020	HSS bi-metal hole saw, ø 148
09000015	HSS bi-metal hole saw, ø 157
09000016	HSS bi-metal hole saw, ø 205
09000017	HSS bi-metal hole saw, ø 258
09000018	HSS bi-metal hole saw, ø 307



Magnet- and Plugging rod

Order no.	Product
09000043	Magnet rod
69000030	Flange for magnet or plugging rod, PN 16, DN 200
69000031	Flange for magnet or plugging rod, PN16, DN 350



Slide valves

Order no.	Product
69000374	Flachschieber, PN 16, DN 80
69000375	Flachschieber, PN 16, DN 100
00800382	Slide valve, PN 16, DN 150
69000023	Gate valve, PN 16, DN 200
69000269	Flachschieber, PN 16, DN 300

Bag-positioning Equipment

The bag-positioning technology from Städtler+Beck serves the gas-free and temporary blocking of gas pipes acc. BGR 500.

In addition, MDA bag-positioning equipment can be used in **water and district heating pipelines or in the chemical industry**. During construction and manufacturing **safety, durability, quality and ease of use** has the highest priority.

The features and advantages of our bag-positioning technic are:

- All MDA are certified by DVGW and ensure the highest safety
- By the use of double-bags, both bags will be set against the flow direction, this redundancy increases the safety and the bag inserting will be facilitated by the space gain in the inserting pipe
- every bag will be supplied separately and can be used as main stopper or stopper for leaking gas, that is why the gas line is always blocked securely
- Pre-pressure measurement and vent of the gap can be performed easily at the devices
- The construction area or excavation can be kept as low as possible, because both bags are positioned in distance from the working area
- Through the gas lock a rule-compliant venting, flushing or re-gassing of the working area is possible
- A turn back or pull off of gas bags during the line stop is not possible

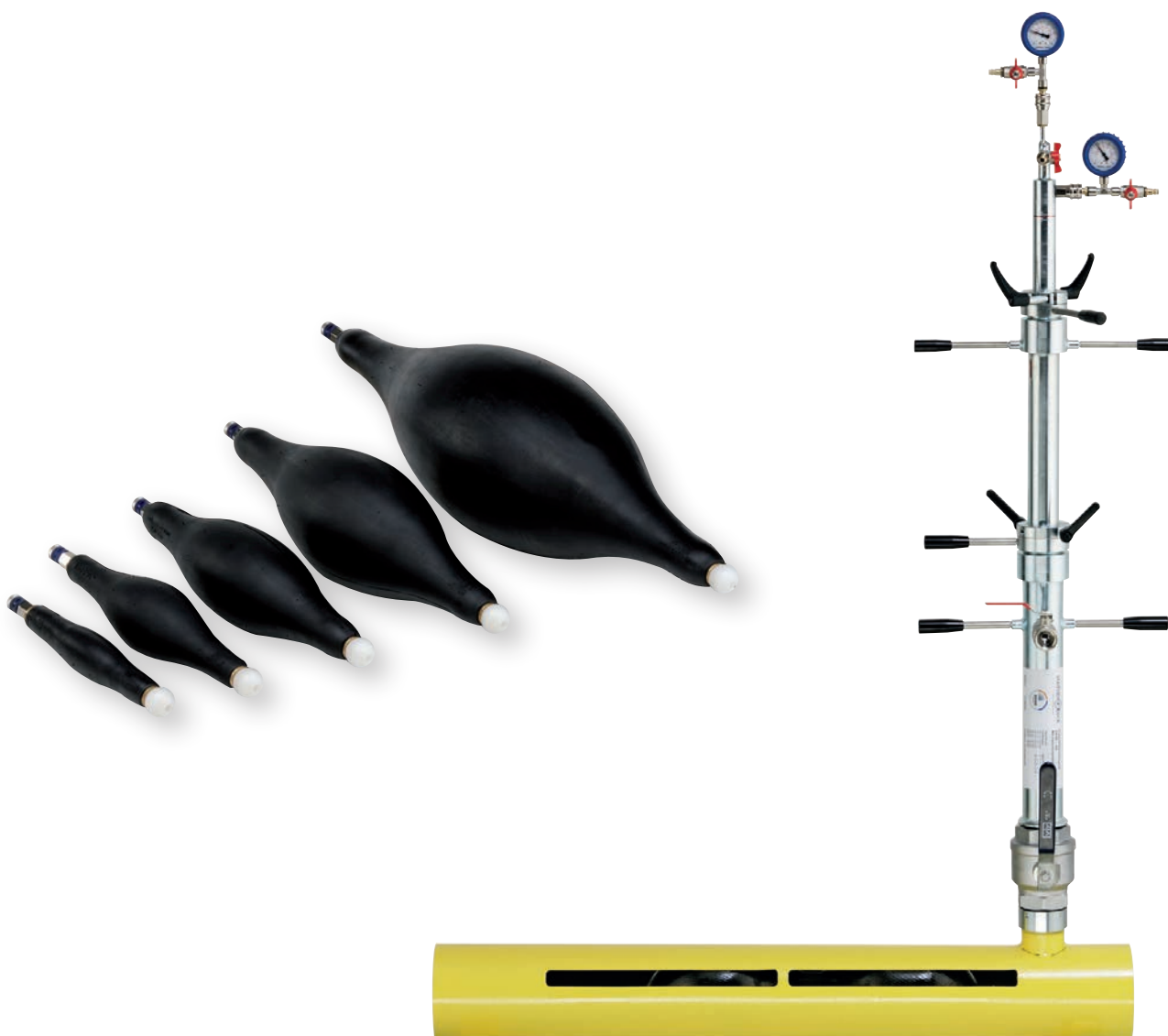

Double Bag-positioning device for DN 80 to 300 with gap-venting

"If gas pipes will be blocked with a nominal diameter greater than DN 150 and/or an operating pressures over 30 mbar, the BGR500 dictates that the use of two gas bags with an gap ventilation is mandatory." The double bag-positioning device and the associated MDA bags or normal gas bags are used for temporary line stopping of gas pipelines and are **all certified by the DVGW**. This device can insert two gas bags in a row in one work routine from **DN 80 to DN 300** in the pipeline.

Advantages of the double bag-positioning technic are:

- You need **only two devices** in contrast to the conventional line stopping with four devices
- The positioning against the gas flow **saves up to one meter of excavation**
- **A turn back or pull off** of gas bags during the line stop **is not possible**
- Every bag-positioning device has separated connections for the bag filling, **gap ventilation and pre-pressure measurement**
- A **rule-complaint proceeding** (re-gassing, inertization and flushing) is possible, without evacuating a gas bag
- Pressure measurement can be done at any time
- The **leaked gas can be removed safely** from the construction site through the gap ventilation



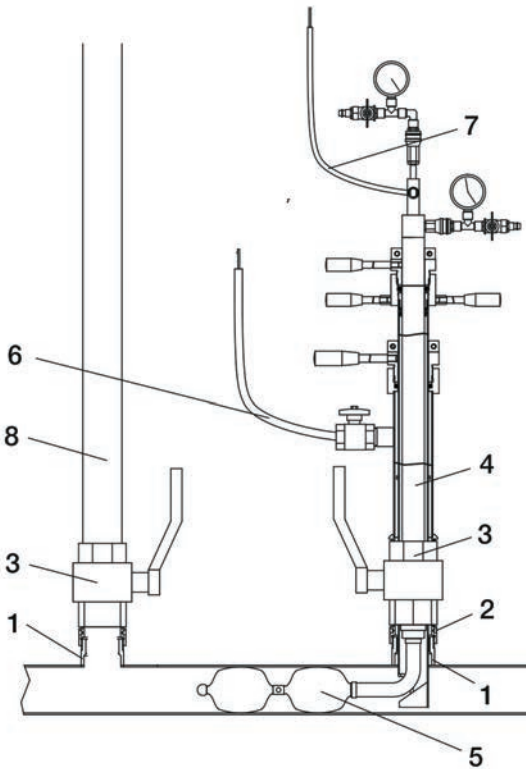

Construction

Pos.	Product	Order no.
1	Weld-on socket	00870127
2	Adapter	00800140
3	Ball valve	00800119
4	Double bag-positioning device DN 80-210 MDA / DN 300 textile bags	00800001
5	MDA double bag with pre-pressure measurement and gap vent	01100039
6	Gassing and flushing hose	00800104
7	10 m degas-hose with coupling type 26/hook	00800007
8	Bypass DN 50, complete	02810071



Versions

Order no.	Product
00800001	Double bag-positioning device DN 80-210 MDA / DN 300 textile bags
00800120	Extension kit for double bag-positioning device DN 200-300 MDA

Delivery

For diameter 80-210 mm:

- Gas lock
- Bag-positioning rods with armatures
- Bag-positioning pipe diam. 80-130 mm
- Bag-positioning pipe diam. 100-160 mm
- Bag-positioning pipe diam. 150-210 mm

For diameter 80-210 mm:

- Gas lock
- Bag-positioning rods with armatures
- Bag-positioning pipe diam. 200-315 mm

In addition, all devices will be adapted to your application and equipped to your wishes from an extensive range of accessories. We will advise you on the selection and will support you to get your job perfectly done.

Spareparts for double bag-positioning devices

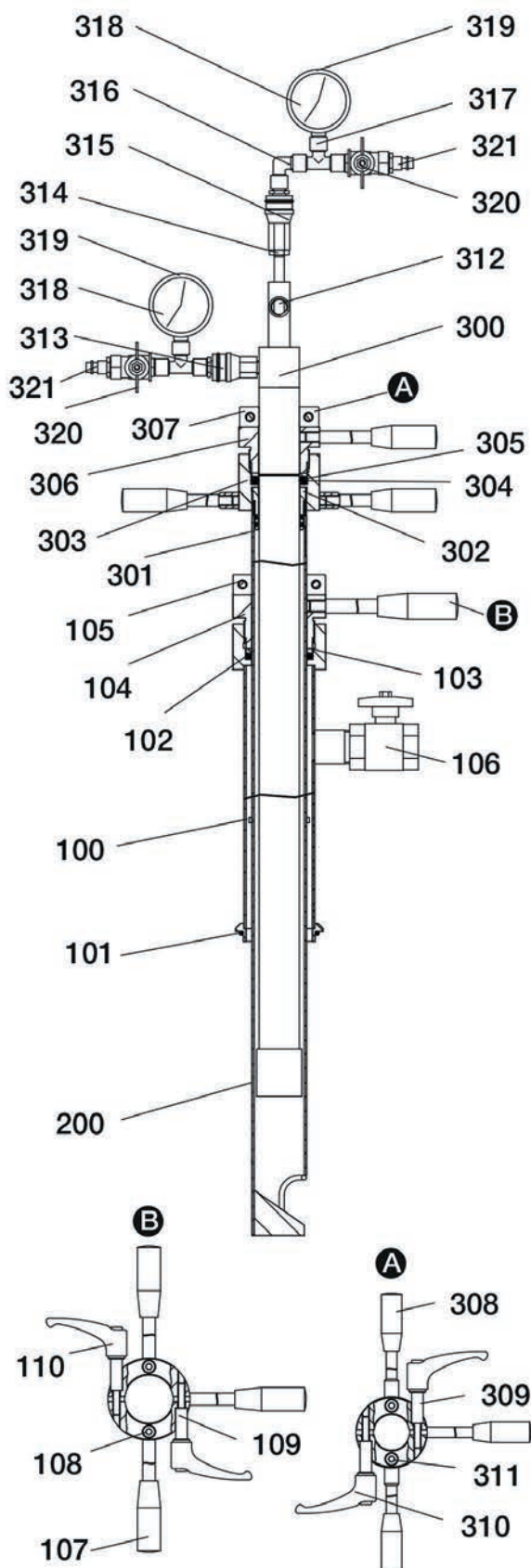

Double bag-positioning device DN 80-210

Pos.	Product	Unit	Order no.
100	Gas lock	1 Stück	00800197
101	O-Ring, \varnothing 70 x 4 mm, DVGW	1 Stück	00800015
102	O-Ring, DVGW, \varnothing 54 x 6,5 mm	1 Stück	20010035
103	Compression ring	1 Stück	00800526
104	Compression ring	1 Stück	00800009
105	Clamping ring	1 Stück	00800010
106	Ball valve	1 Stück	00800013
107	Handle bar M12 x 160	3 Stück	00800016
108	Cyl. screw M8 x 25	2 Stück	00800064
109	Spacer	2 Stück	00800012
110	Clamping lever M8 x 63	1 Stück	00800017
200	Bag-positioning pipe MDA DN 50-80	1 Stück	00800043
200	Bag-positioning pipe MDA DN 80-130/ textile bags DN 80-125	1 Stück	00800003
200	Bag-positioning pipe MDA DN 100-160/ textile bags DN 100-150	1 Stück	00800004
200	Bag-positioning pipe MDA DN 150-210/ textile DN 150-200	1 Stück	00800005
300	Bag-positioning rod	1 Stück	00800057
301	O-Ring, DVGW, \varnothing 38 x 4 mm	2 Stück	00800075
302	Sleeve for bag-positioning rod	1 Stück	00800062
303	Connector for bag-positioning rod	1 Stück	00800059
304	O-Ring, DVGW, \varnothing 40 x 8 mm	1 Stück	00800072
305	Compression ring	1 Stück	00800520
306	Press ring	1 Stück	00800061
307	Clamping ring	1 Stück	00800063
308	Handle bar M10 x 160	3 Stück	00800074
309	Spacer	2 Stück	00800012
310	Clamping lever M8 x 63	2 Stück	00800017
311	Cyl. screw M8 x 25	2 Stück	00800064
312	Ball valve	1 Stück	00800071
313	Coupling, type 26	1 Stück	00800473
314	Reduction	1 Stück	00800076
315	Coupling, type 26 x 1/4" IT	1 Stück	00800474
316-	Fill armature for second bag	1 Stück	00800466
321	Fill armature for first bag	1 Stück	00800467
316	Pipe elbow 1/4"	1 Stück	00800077
317	Tee	2 Stück	00800067
318	Pressure gauge 0-2,5 bar	2 Stück	01000033
319	Protective cap for pressure gauge	2 Stück	00800070
320	Ball valve	2 Stück	00800068
321	Plug, type 26	4 Stück	03000013
322	Plug, type 26	1 Stück	01000267

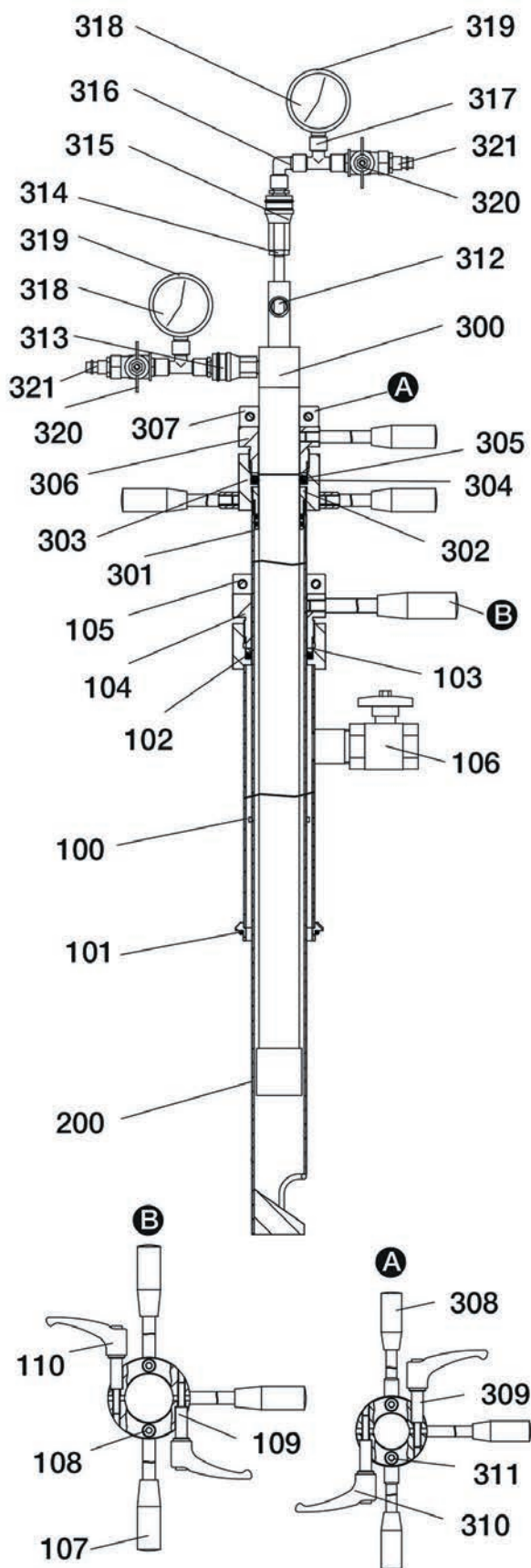

Double bag-positioning device DN 200-300

Pos.	Product	Unit	Order no.
100	Gas Lock	1 Stück	00800403
101	O-Ring DVGW 105 x 6 mm	1 Stück	20010023
102	O-Ring DVGW Ø 85 x 8 mm	1 Stück	20010041
103	Compression ring	1 Stück	00800527
104	Press Ring	1 Stück	00800389
105	Clamping Ring	1 Stück	00800390
106	Ball valve	1 Stück	00800013
107	Handle bar M12 x 160	3 Stück	00800016
108	Cyl. screw M8 x 25	2 Stück	00800064
109	Spacer	2 Stück	00800266
110	Clamping lever M10x80	2 Stück	00800154
200	Bag-positioning tube MDA DN 200-315	1 Stück	00800267
300	Bag-positioning rod	1 Stück	00800396
301	O-Ring, DVGW, Ø 72 x 3,5 mm	2 Stück	20010009
302	Sleeve for bag-positioning rod	1 Stück	00800401
303	Connector for bag-positioning rod	1 Stück	00800399
304	O-Ring, DVGW, Ø 40 x 8 mm	1 Stück	00800072
305	Compression ring	1 Stück	00800520
306	press ring	1 Stück	00800402
307	Clamping ring	1 Stück	00800063
308	Handle bar M10 x 160	3 Stück	00800074
309	Spacer	2 Stück	00800012
310	Clamping lever M8 x 63	2 Stück	00800017
311	Cyl. screw M8 x 25	2 Stück	00800064
312	Ball valve	1 Stück	00800071
313	Coupling, type 26	1 Stück	00800473
314	Reduction	1 Stück	00800076
315	Coupling, type 26 x 1/4" IT	1 Stück	00800474
316	Fill armature for first bag	1 Stück	00800190
321	Fill armature for second bag	1 Stück	00800189
316	Pipe elbow 1/4"	1 Stück	00800077
317	Tee	2 Stück	00800067
318	Pressure gauge 0-2,5 bar	2 Stück	01000033
319	Protective cap for pressure gauge	2 Stück	00800070
320	Ball valve	2 Stück	00800068
321	Plug, type 26	4 Stück	03000013
322	Plug, type 26	1 Stück	01000267

Bag-positioning device DN 300-600 with pre-pressure Measurement

The use of a single-bag positioning device with pressure measurement allows temporary blocking of supply lines without any gas leakage with continuous measurement of the operating line pressure.

A Bypass will be used to secure the supply during the construction. We offer you what you need individually from our extensive range of accessories.

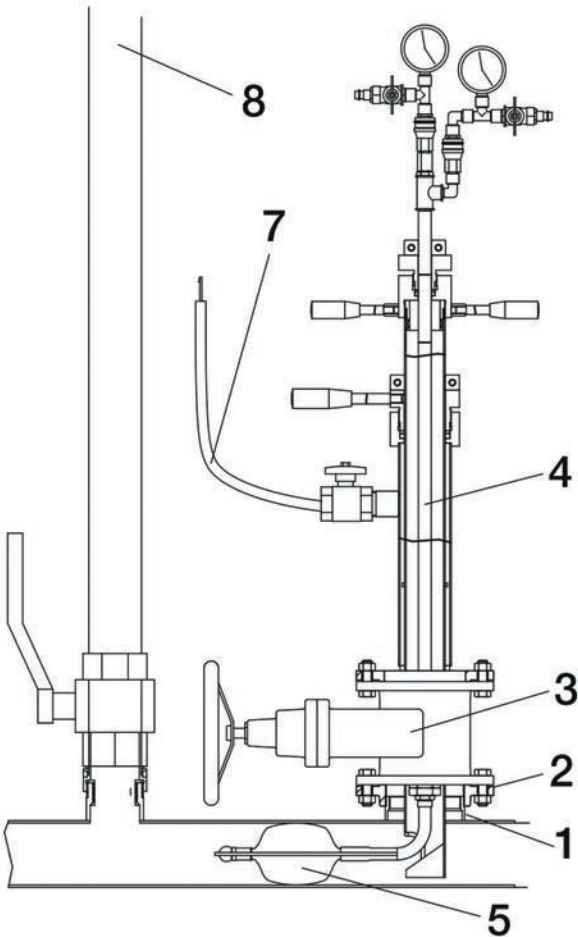

Construction

Pos.	Product	Order no.
1	Weld-on socket	00870029
2	Threaded flange, galvanized	20050056
3	Slide valve	00800382
4	Bag-positioning device DN 300 - DN 600	00800121
5	MDA 1 bar single-bag with pre-pressure measurement	01100122
7	10 m degas-hose with coupling type 26/ hook	00800007
8	Bypass DN80, complete	02810072



Versions

Order no.	Product
00800121	Bag-positioning device DN 300 - DN 600

Delivery

- Gas lock 6"
- Bag-positioning pipe MDA™ 300-500 mm
- Bag-positioning rod with armatures

Spareparts for Bag-positioning device

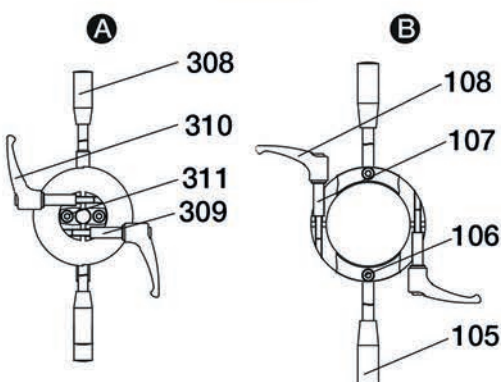
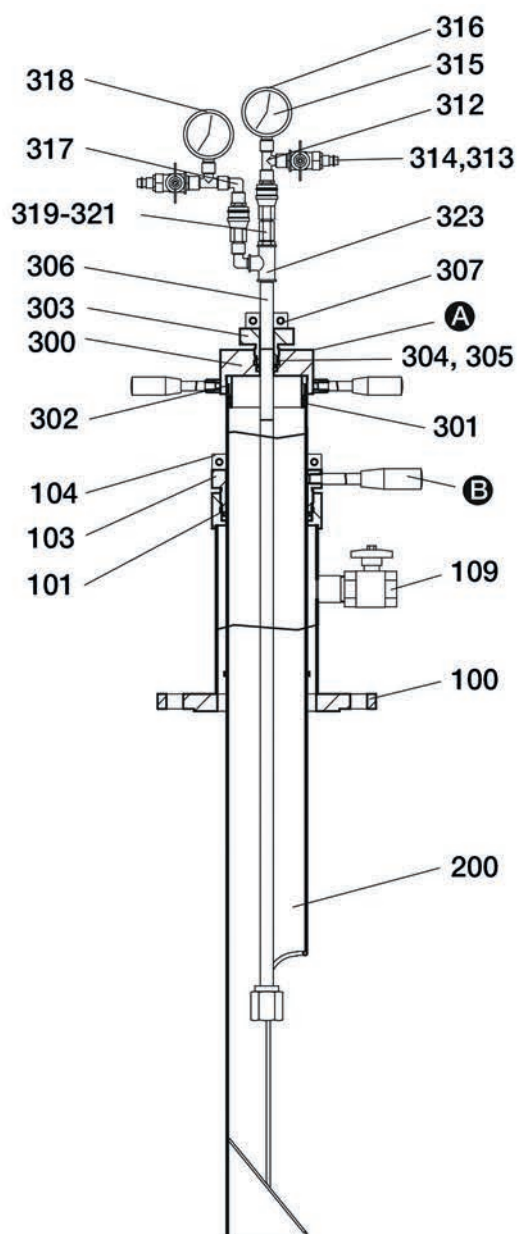

Pos.	Product	Unit	Order no.
100	Gas lock	1 Stück	00800290
101	O-Ring, 125 x 6 mm, DVGW	2 Stück	00800180
102	Compression ring	2 Stück	00800528
103	Press ring	1 Stück	00800271
104	Clamping ring	1 Stück	00800272
105	Handle bar M12 x 160	2 Stück	00800016
106	Cyl. screw M8 x 25	2 Stück	00800064
107	Spacer	2 Stück	00800266
108	Clamping lever M10x80	2 Stück	00800154
109	Ball valve	1 Stück	00800013
200	Bag-positioning pipe	1 Stück	00800273
300	Bag-positioning rod	1 Stück	00800274
301	O-Ring, DVGW ø 110 x 3,5 mm	2 Stück	20010011
302	Sleeve for bag-positioning rod	1 Stück	00800276
303	Connector for bag-positioning rod	1 Stück	00800278
304	O-Ring, ø34 x 6, DVGW	1 Stück	00800179
305	Compression ring	1 Stück	00800529
306	Press ring	1 Stück	00800281
307	Clamping ring	1 Stück	00800283
308	Handle bar M10 x 160	3 Stück	00800074
309	Spacer	2 Stück	00800284
310	Clamping lever M8 x 63	2 Stück	00800017
311	Cyl. screw M8 x 25	1 Stück	00800064
312	Tee	2 Stück	00800067
313	Ball valve	2 Stück	00800068
314	Plug, type 26	4 Stück	03000013
315	Pressure gauge	1 Stück	01000031
316	Protective cap for pressure gauge	1 Stück	00800070
317	Pipe elbow 1/4"	1 Stück	00800077
318	Pressure gauge	1 Stück	00800285
319	Coupling, type 26 x 1/4" IT	2 Stück	00800474
320	O-Ring, DVGW, ø7 x 2 mm	1 Stück	20010036
321	Reduction	1 Stück	02000024
322	Connector	1 Stück	00800277
323	T-Fitting 1" x 1/4" x 1" IT, galvanized	1 Stück	02000023

Accessories for Bag-positioning devices



Anti-Friction fluid for MDA bags

Order no.	Product
00800184	1l anti-friction fluid for MDA™ bags, sponge, 10 pair gloves
00800306	5l anti-friction fluid for MDA bags



Anti-friction coating for water and district heating pipelines

Order no.	Product
01100149	Silicon-grease CHEMPLEX 746



Bag-positioning pipe (type 80)

Order no.	Product
00800514	Bag-positioning pipe for PVC pipes MDA double-bags DN 50-80
00800043	Bag-positioning pipe MDA DN 50-80
00800003	Bag-positioning pipe MDA DN 80-130/ textile bags DN 80-125
00800004	Bag-positioning pipe MDA DN 100-160/ textile bags DN 100-150
00800005	Bag-positioning pipe MDA DN 150-210/ textile DN 150-200
01000364	Bag-positioning pipe for textile bags, DN 250 - 300, DVGW
00800521	Bag-positioning pipe extensionset for double bags MDA DN 150 - 210
00800483	Bag-positioning pipe extensionset for single and double bags MDA DN 200-300 / textile DN 400
00800537	Bag-positioning pipe extensionset for single and double bags MDA DN 200-300 / Stoff DN 500



Pull handle for bag-positioning devices

Order no.	Product
00800542	Pull handle for bag-positioning devices, ø 40 mm, Aluminium
00800562	Adapter for pull handle to TITAN 8plus
00800563	Adapter for pull handle to plugging rod



Grounding Tools

Order no.	Product
00720009	Groundspike with 10 m cable and clamp



Testheads

Order no.	Product
00800198	Testhead for double Bag
00800223	Testhead for single Bags

MDA 1 bar –Multi-Diameter-Gas Bags

Compared with conventional test and line stopping bags have MDA gas bags essential advantages in the application:

- **Excellent gas seal** because of a special rubber compound
- An absolutely **tight fit** in the pipe
- High flexibility and bend mobility due conical design
- **Temperature, oil and chemical resistance**
- MDA- gas bags are designed for an **operation pressure up to 1 bar**
- Perfect compatibility with S+B bag-positioning devices and nearly all other bag-positioning devices at the market
- **proven** through the use of various public utility companies who confirm the **reliability**

Because of their temperature/heat and oil/chemical resistance, MDA bags are particularly suitable for stopping of:

- District heating pipes
- Pipelines in chemical industry (on request)
- Biogas lines

MDA gas bags can be ordered as a single bag with or without pre-pressure measurement or as a double bag with gab venting.

In addition, all devices will be adapted to your application and equipped according to your wishes by an extensive range of accessories. We will advise you on the selection and will support you to get your job perfectly done.





MDA single bags

for single bag-positioning devices without pre-pressure measurement

Order no.	Product
01100106	MDA 1 bar single-bag, DN 50-80 mm
01100003	MDA 1 bar single bag, DN 80-130mm
01100110	MDA 1 bar single-bag, DN 100-160 mm
01100113	MDA 1 bar single-bag, DN 150-210 mm
01100114	MDA 1 bar single-bag, DN 200-315mm
01100116	MDA 1 bar single-bag, DN 300-500 mm



MDA single bags

for single bag-positioning devices with pre-pressure measurement

Order no.	Product
01100117	MDA 1 bar single-bag with pre-pressure measurement, DN 50-80mm
01100118	MDA 1 bar single-bag with pre-pressure measurement, DN 80-130mm
01100119	MDA 1 bar single-bag with pre-pressure measurement, DN 100-160mm
01100120	MDA 1 bar single-bag with pre-pressure measurement, DN 150-210mm
01100121	MDA 1 bar single-bag with pre-pressure measurement, DN 200-315mm
01100122	MDA 1 bar single-bag with pre-pressure measurement, DN 300-500mm



MDA double bags

for double bag-positioning device

Order no.	Product
01100001	MDA double bag with pre-pressure measurement and gap vent, DN 50-80 mm
01100023	MDA double bag with pre-pressure measurement and gap vent, DN 80-130 mm
01100039	MDA double bag with pre-pressure measurement and gap vent, DN 100-160 mm
01100049	MDA double bag with pre-pressure measurement and gap vent, DN 150-210 mm
01100052	MDA double bag with pre-pressure measurement and gap vent, DN 200-315 mm

Pressure table for MDA bags according to DVGW instructions

Diameter	Max. fill pressure	Max. operating pressure
Dm. 50 – 80 mm	2,2 bar	1,0 bar
Dm. 80 – 130 mm	2,2 bar	1,0 bar
Dm. 100 – 160 mm	1,6 bar	0,7 bar
Dm. 150 – 210 mm	1,6 bar	0,7 bar
Dm. 200 – 315 mm	1,2 bar	0,5 bar

Pressure table MDA bags according to manufacturer instructions

Diameter	Max. fill pressure	Max. operating pressure
Dm. 50 – 80 mm	2,2 bar	1,0 bar
Dm. 80 – 130 mm	2,2 bar	1,0 bar
Dm. 100 – 160 mm	2,0 bar	1,0 bar
Dm. 150 – 210 mm	2,0 bar	1,0 bar
Dm. 200 – 315 mm	1,2 bar	0,5 bar
Dm. 300 – 500 mm	1,5 bar	0,5 bar

Gas bag with textile Cover for S+B bag-positioning Devices

Städtler+Beck gas bags with textile cover are the only ones with DVGW certification in Germany.



Single bags

with pre-pressure measurement

Order no.	Product
00900001	Single bag with pre-pressure measurement, DN 80
00900002	Single bag with pre-pressure measurement, DN 100
00900003	Single bag with pre-pressure measurement, DN 125
00900004	Single bag with pre-pressure measurement, DN 150
00900005	Single bag with pre-pressure measurement, DN 200
00900006	Single bag with pre-pressure measurement, DN 250
00900007	Single bag with pre-pressure measurement, DN 300
00900008	Single bag with pre-pressure measurement, DN 350
00900009	Single bag with pre-pressure measurement, DN 400
00900010	Single bag with pre-pressure measurement, DN 450
00900011	Single bag with pre-pressure measurement, DN 500
00900012	Single bag with pre-pressure measurement, DN 550
00900013	Single bag with pre-pressure measurement, DN 600
00900014	Single bag with pre-pressure measurement, DN 650



Single bags

without pre-pressure measurement

Order no.	Product
00910001	Single bag without pre-pressure measurement, DN 80
00910002	Single bag without pre-pressure measurement, DN 100
00910003	Single bag without pre-pressure measurement, DN 125
00910004	Single bag without pre-pressure measurement, DN 150
00910005	Single bag without pre-pressure measurement, DN 200
00910014	Single bag without pre-pressure measurement, DN 225
00910006	Single bag without pre-pressure measurement, DN 250
00910007	Single bag without pre-pressure measurement, DN 300
00910008	Single bag without pre-pressure measurement, DN 350
00910009	Single bag without pre-pressure measurement, DN 400
00910010	Single bag without pre-pressure measurement, DN 450
00910011	Single bag without pre-pressure measurement, DN 500
00910012	Single bag without pre-pressure measurement, DN 550
00910013	Single bag without pre-pressure measurement, DN 600



Double Bags

with gap vent

Order no.	Product
00950001	Double bag with gap vent, DN 80
00950019	Double bag with gap vent, DN 100
00950023	Double bag with gap vent, DN 125
00950025	Double bag with gap vent, DN 150
00950031	Double bag with gap vent, DN 200
00950034	Double bag with gap vent, DN 250
00950038	Double bag with gap vent, DN 300
00950148	Double bag with gap vent, DN 310
00950149	Double bag with gap vent, DN 350
00950150	Double bag with gap vent, DN 400

Pressure table for textile bags according to DVGW instructions

Diameter	Max. fill pressure	Max. operating pressure
DN 80	1,4 bar	350 mbar
DN 100	1,2 bar	250 mbar
DN 125	1,1 bar	200 mbar
DN 150	1,0 bar	190 mbar
DN 200	0,6 bar	150 mbar
DN 250	0,4 bar	90 mbar
DN 300	0,3 bar	50 mbar

Pressure table for textile bags according to manufacturer instructions

Diameter	Max. fill pressure	Max. operating pressure
DN 80	2,1 bar	700 mbar
DN 100	2,0 bar	700 mbar
DN 125	1,8 bar	600 mbar
DN 150	1,5 bar	500 mbar
DN 200	1,2 bar	400 mbar
DN 250	1,0 bar	350 mbar
DN 300	0,8 bar	300 mbar
DN 350	0,6 bar	200 mbar
DN 400	0,5 bar	200 mbar
DN 500	0,4 bar	150 mbar

Gas bags from other manufactures

Single textile bags VEW

for bag-positioning device VEW

Order no.	Product
00920001	single textile bag, VEW, DN 80
00920002	single textile bag, VEW, DN 100
00920003	single textile bag, VEW, DN 125
00920004	single textile bag, VEW, DN 150
00920005	single textile bag, VEW, DN 175
00920006	single textile bag, VEW, DN 200
00920007	single textile bag, VEW, DN 250
00920008	single textile bag, VEW, DN 300
00920009	single textile bag, VEW, DN 350
00920010	single textile bag, VEW, DN 400

Single textile bags Size 1

for single bag-positioning devices

Order no.	Product
00900016	single textile bag with pre-pressure measurement, Size 1, DN 80
00900017	single textile bag with pre-pressure measurement, Size 1, DN 100
00900018	single textile bag with pre-pressure measurement, Size 1, DN 125
00900019	single textile bag with pre-pressure measurement, Size 1, DN 150
00900020	single textile bag with pre-pressure measurement, Size 1, DN 200
00900021	single textile bag with pre-pressure measurement, Size 1, DN 250
00900022	single textile bag with pre-pressure measurement, Size 1, DN 300

Double textile bags

with gap vent, G 212 for J 125

Order no.	Product
00970002	double textile bag with gap vent, G 212 for J 125, DN 80
00970003	double textile bag with gap vent, G 212 for J 125, DN 100
00970004	double textile bag with gap vent, G 212 for J 125, DN 125
00970005	double textile bag with gap vent, G 212 for J 125, DN 150
00970006	double textile bag with gap vent, G 212 for J 125, DN 200
00970007	double textile bag with gap vent, G 212 for J 125, DN 250
00970008	double textile bag with gap vent, G 212 for J 125, DN 300
00970009	double textile bag with gap vent, G 212 for J 125, DN 350
00970010	double textile bag with gap vent, G 212 for J 125, DN 400

Gas locks for Pipe-cameras

These gas lock allows the entering of an in-use gas pipeline without any gas leakage **up to 10 bar operation pressure**. In this process the camera can be pushed continuously and as far as desired by the lock into the pipeline.

A new and patented process allows the necessary gas-free und flexible transport of the camera.

For example, the condition of the gas pipeline can be checked, if a gas bag “burstet” or was damaged in the pipeline.

Also pipe connections, especially on material changes, can be inspected. Or you can look at collecting basins, valves or other installations with the camera lock system.

Water pipelines, which are under pressure, can be checked more economical with the camera lock system. For example, you can watch easily, if a gate valve still closes properly.

First do a camera inspection, before you dredge!

The camera lock system is offered for different camera heads, corresponding adapters make the system compatible with most camera manufactures.

You can use the camera lock system with standard design up to a pressure of 1 bar, usually the maximum pressure load of the camera head limits the use.



Versions

Order no.	Product
80000001	HC gas / water lock for closed pipes, bis 1 bar
80000002	HC gas / water lock for closed pipes, bis 6 bar
80000018	Transport box for gas lock
09990045	Aluminium transport box for camera winder till 540 mm
80000099	Protection cage for the camera head RI4035

Delivery

- Camera gas lock
- Positioning pipe
- Special clamping device



Accessories for Bag-positioning devices

Pressure- and Suction Pump

The pumps are used to fill and evacuate the various flow-stop bags manually.

Other features are:

- High pump volume
- Lightweight and very robust
- Ease of use, two connections with quick-release couplings
- Corrosion resistance, by using materials like stainless steel and aluminum
- Max. pressure 4 bar



Pressure- and suction pump

made of stainless steel with a huge cylinder for more displacement, Plug type 26

Order no.	Product
02700054	Pressure- and suction pump 2014 without hose, max. 4 bar



Delivery

The pressure- and suction pump is made of stainless steel and can be equipped on your requirements from our extensive range of accessories. On request we adjust the delivery by your demands and try to find the best solution for you.

Accessories for pressure- and suction pump



Order no.	Product
02700018	2 m hose with coupling type 26
02700043	5 m hose with coupling type 26
02700032	Extra charge vor 1 m hose extension

Spareparts

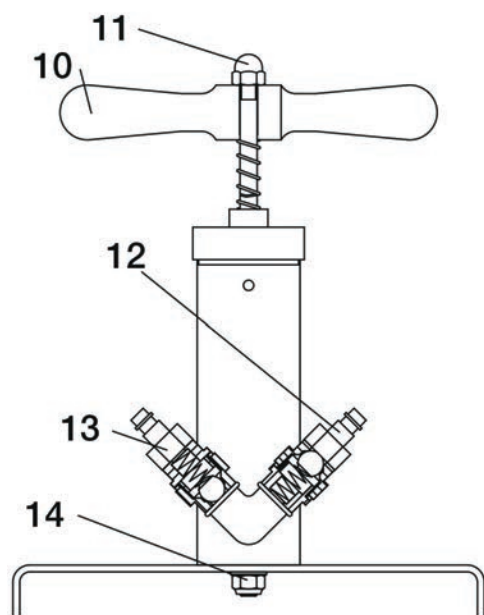

Sparepartlist

Pos.	Product	Unit	Order no.
1	Baseplate	1 Stück	02700051
2	Base	1 Stück	02700052
3	Cylinder	1 Stück	02700050
4	Piston	2 Stück	02700014
5	Washer, ø 45 x 10,5 x 3 mm, galvanized	2 Stück	04100064
6	Self-locking nut M10	1 Stück	02700017
7	Spring	1 Stück	02700004
8	Rod	1 Stück	02700007
9	Cap	1 Stück	02700055
10	Handle bar	1 Stück	02700010
11	Hex. Flanged nut M10	1 Stück	02700011
12	Plug, type 26	2 Stück	01000267
13	Check valve 3/8"	2 Stück	04010004
14	Washer M10 (B10,5), galvanized	2 Stück	20010051

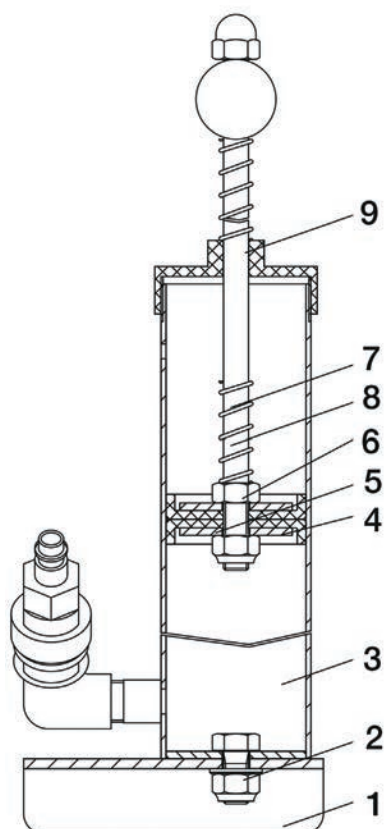

Weld-on Sockets and Plugs



Weld-on socket type 87 (steel)

for tapping- and bag-positioning device

Order no.	Product
00870127	Weld-on socket 2 1/2" ET x 2" IT
00870004	Weld-on socket 4" ET x 3 1/4" IT
00870029	Weld-on socket 6" ET x 5" IT



Weld-on socket type 87 (steel)

for Stopple devices HSE

Order no.	Product
00870008	Weld-on socket for HSE 1" / 2 1/2" ET x 2" IT
00870005	Weld-on socket for HSE 1 1/4" / 2 1/2" ET x 2" IT
00870006	Weld-on socket for HSE 1 1/2" / 2 1/2" ET x 2" IT
00870007	Weld-on socket for HSE 2" / 2 1/2" ET x 2" IT
00870009	Weld-on socket for HSE 2 1/2" / 3" ET x 2 1/2" IT
00870010	Weld-on socket for HSE 3" / 4" ET x 3 1/4" IT



Weld-on plug type 84 (steel)

for all weld-on sockets

Order no.	Product
00840029	Weld-on plug 2" ET
00840031	Weld-on plug 3 1/4" ET
00840066	Weld-on plug 5" ET



Flat Caps type 87 (steel)

for welding sockets

Order no.	Product
00870133	Flat cap, steel, 2 1/2" IG
00870134	Flat cap, steel, 4" IT
00870034	Flat cap, steel, 6" IT



Electrofusion saddles typ 87 (PE)

Order no.	Product
00870086	Electrofusion Saddle for PE pipes, ED 90, 2 1/2" ET x 2" IT
00870087	Electrofusion saddle for PE pipes, ED 110, 2 1/2" ET x 2" IT
00870088	Electrofusion saddle for PE pipes, ED 125, 2 1/2" ET x 2" IT
00870089	Electrofusion saddle for PE pipes, ED 160, 2 1/2" ET x 2" IT
00870090	Electrofusion saddle for PE pipes, ED 180, 2 1/2" ET x 2" IT
00870091	Electrofusion saddle for PE pipes, ED 200, 2 1/2" ET x 2" IT
00870094	Electrofusion saddle for PE pipes, ED 225, 2 1/2" ET x 2" IT
00870092	Electrofusion saddle for PE pipes, ED 250-313, 2 1/2" ET x 2" IT
00870093	Mounting equipment for electrofusion saddle / ED 250-313

Tapping sleeves



Tapping sleeve for PE (type 87)

compatible with double bag-positioning device DN 200-300

Order no.	Product
00870189	Tapping sleeve for PE ED 160, 4" ET x 3 1/4" IT
00870190	Tapping sleeve for PE ED 225, 4" ET x 3 1/4" IT



Tapping sleeve for cast iron (type 87)

compatible with double bag-positioning device DN 200-300

Order no.	Product
00870191	Tapping sleeve for cast iron, DN 150, 4" ET x 3 1/4" IT
00870192	Tapping sleeve for cast iron, DN 200, 4" ET x 3 1/4" IT
00870193	Tapping sleeve for cast iron, DN 250, 4" ET x 3 1/4" IT
00870194	Tapping sleeve for cast iron, DN 300, 4" ET x 3 1/4" IT



Combi-Tapping sleeves

compatible with double bag-positioning device DN 80-300

Order no.	Product
30060032	Combi-tapping sleeve ASSB (type 23), DN 80
30060033	Combi-tapping sleeve ASSB (type 23), DN 100
30060034	Combi-tapping sleeve ASSB (type 23), DN 125 - 150
30060035	Combi-tapping sleeve ASSB (type 23), DN 225 - 250
30060036	Combi-tapping sleeve ASSB (type 23), DN 300
30060037	Tapping sleeve with flat clamp (type 20), for steel pipes, DN 80
30060038	Tapping sleeve with flat clamp (type 20), for steel pipes, DN 100
30060039	Tapping sleeve with flat clamp (type 20), for steel pipes, DN 125
30060040	Tapping sleeve with flat clamp (type 20), for steel pipes, DN 150
30060041	Tapping sleeve with flat clamp (type 20), for steel and cast iron pipes, DN 175
30060042	Tapping sleeve with flat clamp (type 20), for steel and cast iron pipes, DN 200
30060043	Tapping sleeve with flat clamp (type 20), for steel and cast iron pipes, DN 225
30060044	Tapping sleeve with flat clamp (type 20), for steel and cast iron pipes, DN 250
30060045	Tapping sleeve with flat clamp (type 20), for steel and cast iron pipes, DN 300

Fittings, Adapters, Valves



Shut-off devices, Ball valves / Gate valves

for tapping-, bag-positioning and Stopple devices

Order no.	Product
00800119	Ball valve 2 ½" IT x IT
00800108	Ball valve 3" IT x IT
00800110	Ball valve 4" IT x IT
00800112	Gate valve DN 150/6"



Adapter between weld-on socket and ball valve

for tapping-, bag-positioning and stopple device

Order no.	Product
00800140	Adapter 2 ½" IT x ET
00800122	Adapter 3" ET x IT
00800116	Adapter 4" ET x IT



Adapter between ball valve and tapping dome

for Hot tapping and Stopple device

Order no.	Product
00800140	Adapter 2 ½" IT x ET
00800136	Adapter 3" ET x IT
00800118	Adapter 4" ET x IT



Adapter with special threads

for tapping-, bag-positioning and Stopple devices

Order no.	Product
20040203	Adapter M50 x 3 ET LH x 2" IT
01000794	Adapter for Manibs tapping sleeves x 3" ET with bars, O-Rings, Screws
02810334	Adapter for S+B to H+B Stopple device, special vers. 1" HSE Stopple



Threaded flanges

Order no.	Product
20050048	Threaded flange, galvanized, 1"
20050049	Threaded flange, galvanized, 1 1/4"
20050050	Threaded flange, galvanized, 1 1/2"
20050051	Threaded flange, galvanized, 2"
20050052	Threaded flange, galvanized, 2 1/2"
20050053	Threaded flange, galvanized, 3"
20050054	Threaded flange, galvanized, 4"
20050055	Threaded flange, galvanized, 5"
20050056	Threaded flange, galvanized, 6"



Hoses for tapping, bag-positioning and Stopple devices

Order no.	Product
00800115	Connecting components for gassing / flushing hose
00800007	10 m degas-hose with coupling type 26/hook
00800269	10 m Hose with coupling for compressor

Lock systems



Lock system 2 1/2"

Order no.	Product
00840039	Lock with ET 2 1/2" for plugging and magnet rod; compatible with bag-positioning device DN 80-210 (300), HSE 1-2"
00840011	Plugging rod, 480 mm, SW24; compatible with HSE 1-2", lock system 1 1/2"
00850015	Magnet rod, 800 mm; compatible with bag-positioning device DN 80-210(300), HSE 2 1/2", lock system 2 1/2-3"



Lock system 4"

Order no.	Product
00840052	Gas lock with ET 4" for plugging and magnet rod; compatible with bag-positioning device DN 200-300, HSE 3"
00840016	Plugging rod, 480 mm, SW32; compatible with HSE 3", bag-positioning device DN 200-300, lock system 4"
00850016	Magnet rod, 1000 mm; compatible with bag-positioning device DN 200-300, HSE 3", gas lock 4"



Lock system 6"

Order no.	Product
00840056	Gas lock with flange DN 150 for plugging and magnetic rod; compatible with bag-positioning device DN 300-500 (600)
00840022	Plugging rod, 650 mm, SW41; compatible with bag-positioning device DN 300-500(600), lock system 6"
00850028	Magnet rod, 1300 mm; compatible with bag-positioning device DN 300-500(600), lock system 6"



Plugging rods

Order no.	Product
00840063	Plugging rod for FRIATEC-plugs, square 19 mm
01000777	Plugging rod for "Manibs"-plugs and valves with hex. 38 mm
00840080	Plugging rod for system Hütz, SW24



Clamping bracket Quickfix

for PE and steel pipes

Order no.	Product
20010109	Clamping bracket Quickfix PE, ED 32
20010053	Clamping bracket Quickfix PE, ED 50
20010074	Clamping bracket Quickfix PE, ED 63
20010102	Clamping bracket Quickfix PE, ED 75
20010088	Clamping bracket Quickfix PE, ED 90
20010121	Clamping bracket Quickfix PE, ED 110
20010137	Clamping bracket Quickfix PE, ED 160
20010067	Clamping bracket Quickfix, DN 40
20010081	Clamping bracket Quickfix, DN 50
20010095	Clamping bracket Quickfix, DN 80
20010129	Clamping bracket Quickfix, DN 100
20010145	Clamping bracket Quickfix, DN 150



Adapter for bag-positioning device

Order no.	Product
01000790	Adapter for Quickfix to bag-positioning device 3" ET x 2 1/2" IT
01001001	Adapter for Quickfix to bag-positioning device 4" ET x 2 1/2" IT
01001002	Adapter for Quickfix to bag-positioning device 6" ET x 2 1/2" IT

Bypass Sets

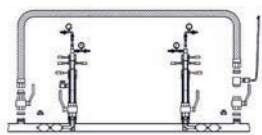

Bypass DN 50

Order no.	Product
00870127	Weld-on socket 2 1/2" ET x 2" IT
00840029	Weld-on plug 2" ET
00800140	Adapter 2 1/2" IT x ET
00800119	Ball valve 2 1/2" IT x IT
02810243	Adapter for bypass DN 50 2 1/2" IT x 2" ET
02810068	Adapter 2 1/2" IT x ET
00800007	10 m degas-hose with coupling type 26/hook
02810067	Bypass, DN 50, 10,00 m

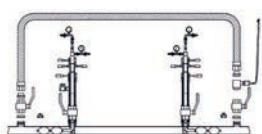

Bypass DN 80

Order no.	Product
00870004	Weld-on socket 4" ET x 3 1/4" IT
00840031	Weld-on plug 3 1/4" ET
00800116	Adapter 4" ET x IT
00800110	Ball valve 4" IT x IT
02810070	Adapter 4" ET x 4" IT
02810069	Adapter for Bypass, DN 80, 4" ET x 3" IT
00800007	10 m degas-hose with coupling type 26/hook
02810073	Bypass, DN 75, 10,00 m



Transportcases

Order no.	Product
00800144	Wooden case for bag-positioning device MAXI DN 80-210
20040012	Steel case for bag-positioning device MAXI and Stopple device
00800291	Steel case for bag-positioning device MAXI DN 200-300
00800114	Steel case for bag-positioning device MAXI DN 300-500

Manual flow-stop bags

Flow-Stop bags for manual release are used for line stopping with controlled gas-leakage and **according to DGUV 100-500 chapter 2.31 flow-stop bags for manual release are indispensable for “unpredictable jobs” with increased danger.**

Städtler+Beck has an extensive range of variants of flow-bags to get every task done with the right product. These bags are available in a range from **DN 40 to DN 2000**. You can choose different covers for the bags to find the correct one according to your requirements. For example,

- Fireproof covers, for stopping pipelines during weldment
- Chemical resistant covers
- High pressure covers

Furthermore all bags are available in different equipment possibilities, for example:

- Inflexible or flexible rods/struts
- Different pressure gauges
- With or without rubber plugs
- Single or double bags
- With all commercial connections
- With or without valves

If you are unable find the right one or you wish a special size, we offer you a fast and uncomplicated solution on your request.



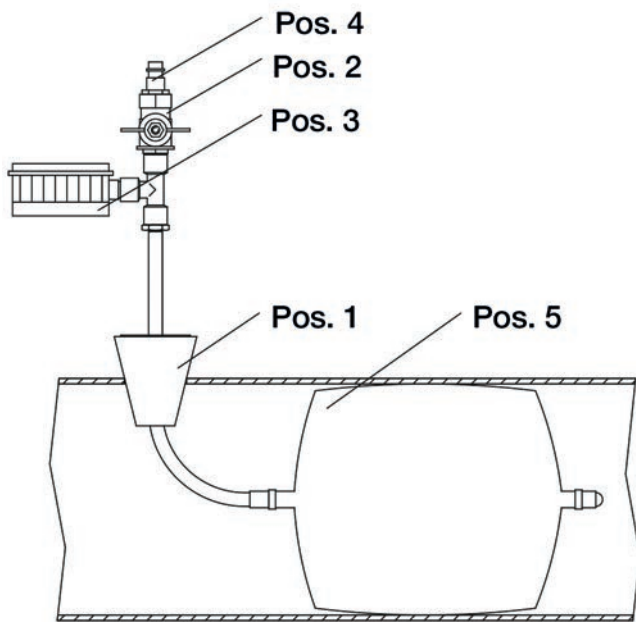

Aufbau

Pos.	Description
Pos. 1	Plug
Pos. 2	Ball valve
Pos. 3	Pressure gauge
Pos. 4	Connector
Pos. 5	Manual bag

Delivery

- Rod/strut
- Bag basic body
- Cover
- Valve

All bags are delivered full assembled and instantly ready to use. On request we adjust the delivery according to your demands and try to find the best solution for you.

Manual bags with conical plug

MDA manual setting bladder

with conical rubber plug, ball valve and gauge

Order no.	Product
01100123	MDA 1 bar, manual setting bladder, DN 50 - 80
01100124	MDA 1 bar, manual setting bladder, DN 80 - 130
01100021	MDA 1 bar, manual setting bladder, DN 100 - 160
01100125	MDA 1 bar, manual setting bladder, DN 150 - 210
01100126	MDA 1 bar, manual setting bladder, DN 200 - 315
01100127	MDA 1 bar, manual setting bladder, DN 300 - 500

MDA manual setting bladder with pre pressure measurement

with conical rubber plug, ball valve and gauge

Order no.	Product
01100128	MDA 1 bar, manual setting bladder, DN 50 - 80
01100129	MDA 1 bar, manual setting bladder, DN 80 - 130
01100130	MDA 1 bar, manual setting bladder, DN 100 - 160
01100131	MDA 1 bar, manual setting bladder, DN 150 - 210
01100132	MDA 1 bar, manual setting bladder, DN 200 - 315
01100030	MDA 1 bar, manual setting bladder, DN 300 - 500



With test head

with test head; consisting of tee, ball valve and gauge

Order no.	Product
01200001	Single bag, with tee, ball valve and gauge, DN 40
01200002	Single bag, with tee, ball valve and gauge, DN 50
01200003	Single bag, with tee, ball valve and gauge, DN 60
01200004	Single bag, with tee, ball valve and gauge, DN 80
01200005	Single bag, with tee, ball valve and gauge, DN 100
01200006	Single bag, with tee, ball valve and gauge, DN 110
01200007	Single bag, with tee, ball valve and gauge, DN 125
01200008	Single bag, with tee, ball valve and gauge, DN 150
01200009	Single bag, with tee, ball valve and gauge, DN 160
01200010	Single bag, with tee, ball valve and gauge, DN 175
01200011	Single bag, with tee, ball valve and gauge, DN 200
01200012	Single bag, with tee, ball valve and gauge, DN 210
01200013	Single bag, with tee, ball valve and gauge, DN 225
01200014	Single bag, with tee, ball valve and gauge, DN 250
01200015	Single bag, with tee, ball valve and gauge, DN 260
01200016	Single bag, with tee, ball valve and gauge, DN 300
01200017	Single bag, with tee, ball valve and gauge, DN 310
01200018	Single bag, with tee, ball valve and gauge, DN 350
01200019	Single bag, with tee, ball valve and gauge, DN 400
01200020	Single bag, with tee, ball valve and gauge, DN 450
01200021	Single bag, with tee, ball valve and gauge, DN 500
01200107	Single bag, with tee, ball valve and gauge, DN 550
01200023	Single bag, with tee, ball valve and gauge, DN 600
01200024	Single bag, with tee, ball valve and gauge, DN 650
01200025	Single bag, with tee, ball valve and gauge, DN 700
01200026	Single bag, with tee, ball valve and gauge, DN 750
01200027	Single bag, with tee, ball valve and gauge, DN 800
01200028	Single bag, with tee, ball valve and gauge, DN 900
01200029	Single bag, with tee, ball valve and gauge, DN 1000
01200030	Single bag, with tee, ball valve and gauge, DN 1100
01200031	Single bag, with tee, ball valve and gauge, DN 1200
01200032	Single bag, with tee, ball valve and gauge, DN 1300
01200033	Single bag, with tee, ball valve and gauge, DN 1400
01200034	Single bag, with tee, ball valve and gauge, DN 1500
01200035	Single bag, with tee, ball valve and gauge, DN 1600

Manual bags with conical plug and pre-pressure measurement



Manual bags with pre-pressure measurement

incl. test head consisting of cross pipe, two ball valves and gauge

Order no.	Product
01400001	Single bag, two ball valves, DN 40
01400002	Single bag, two ball valves, DN 50
01400003	Single bag, two ball valves, DN 60
01400004	Single bag, two ball valves, DN 80
01400005	Single bag, two ball valves, DN 100
01400006	Single bag, two ball valves, DN 110
01400007	Single bag, two ball valves, DN 125
01400008	Single bag, two ball valves, DN 150
01400009	Single bag, two ball valves, DN 160
01400010	Single bag, two ball valves, DN 175
01400011	Single bag, two ball valves, DN 200
01400012	Single bag, two ball valves, DN 210
01400013	Single bag, two ball valves, DN 225
01400014	Single bag, two ball valves, DN 250
01400015	Single bag, two ball valves, DN 260
01400016	Single bag, two ball valves, DN 300
01400017	Single bag, two ball valves, DN 310
01400018	Single bag, two ball valves, DN 350
01400019	Single bag, two ball valves, DN 400
01400020	Single bag, two ball valves, DN 450
01400021	Single bag, two ball valves, DN 500
01400022	Single bag, two ball valves, DN 550
01400023	Single bag, two ball valves, DN 600
01400024	Single bag, two ball valves, DN 650
01400025	Single bag, two ball valves, DN 700
01400026	Single bag, two ball valves, DN 750
01400027	Single bag, two ball valves, DN 800
01400028	Single bag, two ball valves, DN 900
01400029	Single bag, two ball valves, DN 1000
01400030	Single bag, two ball valves, DN 1100
01400031	Single bag, two ball valves, DN 1200
01400032	Single bag, two ball valves, DN 1300
01400033	Single bag, two ball valves, DN 1400
01400034	Single bag, two ball valves, DN 1500
01400035	Single bag, two ball valves, DN 1600
01400036	Single bag, two ball valves, DN 2000

Manual double bags with extra strong Cover



Without gap vent

incl. mech. compressible rubber plug, test head consisting of tee, ball valve and gauge

Order no.	Product
01700001	Double bag, without gap vent, seperate supply, DN 80
01700002	Double bag, without gap vent, seperate supply, DN 100
01700003	Double bag, without gap vent, seperate supply, DN 110
01700004	Double bag, without gap vent, seperate supply, DN 125
01700005	Double bag, without gap vent, seperate supply, DN 150
01700006	Double bag, without gap vent, seperate supply, DN 160
01700007	Double bag, without gap vent, seperate supply, DN 175
01700008	Double bag, without gap vent, seperate supply, DN 200
01700009	Double bag, without gap vent, seperate supply, DN 210
01700010	Double bag, without gap vent, seperate supply, DN 225
01700011	Double bag, without gap vent, seperate supply, DN 250
01700012	Double bag, without gap vent, seperate supply, DN 260
01700013	Double bag, without gap vent, seperate supply, DN 300
01700014	Double bag, without gap vent, seperate supply, DN 310
01700015	Double bag, without gap vent, seperate supply, DN 350
01700016	Double bag, without gap vent, seperate supply, DN 400
01700017	Double bag, without gap vent, seperate supply, DN 450
01700018	Double bag, without gap vent, seperate supply, DN 500
01700019	Double bag, without gap vent, seperate supply, DN 550
01700020	Double bag, without gap vent, seperate supply, DN 600
01700021	Double bag, without gap vent, seperate supply, DN 650
01700022	Double bag, without gap vent, seperate supply, DN 700
01700023	Double bag, without gap vent, seperate supply, DN 750
01700024	Double bag, without gap vent, seperate supply, DN 800

With gap vent

incl. mech. compress. rubber plug, test head; consisting of cross pipe, two ball valves and gauge

Order no.	Product
01710001	Double bag, with gap vent, seperate supply, DN 80
01710002	Double bag, with gap vent, seperate supply, DN 100
01710003	Double bag, with gap vent, seperate supply, DN 110
01710004	Double bag, with gap vent, seperate supply, DN 125
01710005	Double bag, with gap vent, seperate supply, DN 150
01710006	Double bag, with gap vent, seperate supply, DN 160
01710007	Double bag, with gap vent, seperate supply, DN 175
01710008	Double bag, with gap vent, seperate supply, DN 200
01710009	Double bag, with gap vent, seperate supply, DN 210
01710010	Double bag, with gap vent, seperate supply, DN 225
01710011	Double bag, with gap vent, seperate supply, DN 250
01710012	Double bag, with gap vent, seperate supply, DN 260
01710013	Double bag, with gap vent, seperate supply, DN 300
01710014	Double bag, with gap vent, seperate supply, DN 310
01710015	Double bag, with gap vent, seperate supply, DN 350
01710016	Double bag, with gap vent, seperate supply, DN 400

Manual push-bags



with test head

with test head consisting of tee, ball valve, plug type 26, gauge

Order no.	Product
01800001	Single bag, flexible design, 1 m hose, with pressure gauge, DN 40
01800002	Single bag, flexible design, 1 m hose, with pressure gauge, DN 50
01800003	Single bag, flexible design, 1 m hose, with pressure gauge, DN 60
01800004	Single bag, flexible design, 1 m hose, with pressure gauge, DN 80
01800005	Single bag, flexible design, 1 m hose, with pressure gauge, DN 100
01800006	Single bag, flexible design, 1 m hose, with pressure gauge, DN 110
01800007	Single bag, flexible design, 1 m hose, with pressure gauge, DN 125
01800008	Single bag, flexible design, 1 m hose, with pressure gauge, DN 150
01800009	Single bag, flexible design, 1 m hose, with pressure gauge, DN 160
01800010	Single bag, flexible design, 1 m hose, with pressure gauge, DN 175
01800011	Single bag, flexible design, 1 m hose, with pressure gauge, DN 200
01800012	Single bag, flexible design, 1 m hose, with pressure gauge, DN 210
01800013	Single bag, flexible design, 1 m hose, with pressure gauge, DN 225
01800014	Single bag, flexible design, 1 m hose, with pressure gauge, DN 250
01800015	Single bag, flexible design, 1 m hose, with pressure gauge, DN 260
01800016	Single bag, flexible design, 1 m hose, with pressure gauge, DN 300
01800017	Single bag, flexible design, 1 m hose, with pressure gauge, DN 310
01800018	Single bag, flexible design, 1 m hose, with pressure gauge, DN 350
01800019	Single bag, flexible design, 1 m hose, with pressure gauge, DN 400
01800020	Single bag, flexible design, 1 m hose, with pressure gauge, DN 450
01800021	Single bag, flexible design, 1 m hose, with pressure gauge, DN 500
01800022	Single bag, flexible design, 1 m hose, with pressure gauge, DN 550
01800023	Single bag, flexible design, 1 m hose, with pressure gauge, DN 600
01800024	Single bag, flexible design, 1 m hose, with pressure gauge, DN 650
01800025	Single bag, flexible design, 1 m hose, with pressure gauge, DN 700
01800026	Single bag, flexible design, 1 m hose, with pressure gauge, DN 750
01800027	Single bag, flexible design, 1 m hose, with pressure gauge, DN 800
01800028	Single bag, flexible design, 1 m hose, with pressure gauge, DN 900
01800029	Single bag, flexible design, 1 m hose, with pressure gauge, DN 1000
01800030	Single bag, flexible design, 1 m hose, with pressure gauge, DN 1100
01800031	Single bag, flexible design, 1 m hose, with pressure gauge, DN 1200
01800032	Single bag, flexible design, 1 m hose, with pressure gauge, DN 1300
01800033	Single bag, flexible design, 1 m hose, with pressure gauge, DN 1400
01800034	Single bag, flexible design, 1 m hose, with pressure gauge, DN 1500
01800035	Single bag, flexible design, 1 m hose, with pressure gauge, DN 1600

with chloropren cover

with fast locking coupling typ 26 and chloropren cover, oil and chemical resistant

Order no.	Product
01820001	Single bag, flexible design, 1 m hose, with pressure gauge, CR cover, DN 50
01820002	Single bag, flexible design, 1 m hose, with pressure gauge, CR cover, DN 60
01820003	Single bag, flexible design, 1 m hose, with pressure gauge, CR cover, DN 80
01820004	Single bag, flexible design, 1 m hose, with pressure gauge, CR cover, DN 100
01820005	Single bag, flexible design, 1 m hose, with pressure gauge, CR cover, DN 110
01820006	Single bag, flexible design, 1 m hose, with pressure gauge, CR cover, DN 125
01820007	Single bag, flexible design, 1 m hose, with pressure gauge, CR cover, DN 150
01820008	Single bag, flexible design, 1 m hose, with pressure gauge, CR cover, DN 160
01820009	Single bag, flexible design, 1 m hose, with pressure gauge, CR cover, DN 175
01820010	Single bag, flexible design, 1 m hose, with pressure gauge, CR cover, DN 200
01820011	Single bag, flexible design, 1 m hose, with pressure gauge, CR cover, DN 210
01820012	Single bag, flexible design, 1 m hose, with pressure gauge, CR cover, DN 225
01820013	Single bag, flexible design, 1 m hose, with pressure gauge, CR cover, DN 250
01820014	Single bag, flexible design, 1 m hose, with pressure gauge, CR cover, DN 260
01820015	Single bag, flexible design, 1 m hose, with pressure gauge, CR cover, DN 300
01820016	Schubgasabsperrrblase, CR Hülle, DN 310
01820017	Single bag, flexible design, 1 m hose, with pressure gauge, CR cover, DN 350
01820018	Single bag, flexible design, 1 m hose, with pressure gauge, CR cover, DN 400
01820019	Single bag, flexible design, 1 m hose, with pressure gauge, CR cover, DN 450
01820020	Single bag, flexible design, 1 m hose, with pressure gauge, CR cover, DN 500
01820021	Single bag, flexible design, 1 m hose, with pressure gauge, CR cover, DN 550
01820022	Single bag, flexible design, 1 m hose, with pressure gauge, CR cover, DN 600
01820023	Single bag, flexible design, 1 m hose, with pressure gauge, CR cover, DN 650
01820024	Single bag, flexible design, 1 m hose, with pressure gauge, CR cover, DN 700
01820025	Single bag, flexible design, 1 m hose, with pressure gauge, CR cover, DN 750
01820026	Single bag, flexible design, 1 m hose, with pressure gauge, CR cover, DN 800
01820027	Single bag, flexible design, 1 m hose, with pressure gauge, CR cover, DN 900
01820028	Single bag, flexible design, 1 m hose, with pressure gauge, CR cover, DN 1000
01820029	Single bag, flexible design, 1 m hose, with pressure gauge, CR cover, DN 1100
01820030	Single bag, flexible design, 1 m hose, with pressure gauge, CR cover, DN 1200
01820031	Single bag, flexible design, 1 m hose, with pressure gauge, CR cover, DN 1300
01820032	Single bag, flexible design, 1 m hose, with pressure gauge, CR cover, DN 1400
01820033	Single bag, flexible design, 1 m hose, with pressure gauge, CR cover, DN 1500
01820034	Single bag, flexible design, 1 m hose, with pressure gauge, CR cover, DN 1600

Manual bags for forming gas welding



Double bags

Double gas bags for forming gas welding are used to shut-off the working-area and to fill the working-area with forming gas.

Order no.	Product
01850034	Double bag with aluminium coated glas fiber cover, DN 50
01850035	Double bag with aluminium coated glas fiber cover, DN 60
01850036	Double bag with aluminium coated glas fiber cover, DN 80
01850037	Double bag with aluminium coated glas fiber cover, DN 100
01850038	Double bag with aluminium coated glas fiber cover, DN 110
01850039	Double bag with aluminium coated glas fiber cover, DN 125
01850040	Double bag with aluminium coated glas fiber cover, DN 140
01850041	Double bag with aluminium coated glas fiber cover, DN 150
01850042	Double bag with aluminium coated glas fiber cover, DN 160
01850043	Double bag with aluminium coated glas fiber cover, DN 175
01850044	Double bag with aluminium coated glas fiber cover, DN 200
01850045	Double bag with aluminium coated glas fiber cover, DN 210
01850046	Double bag with aluminium coated glas fiber cover, DN 225
01850047	Double bag with aluminium coated glas fiber cover, DN 250
01850048	Double bag with aluminium coated glas fiber cover, DN 260
01850049	Double bag with aluminium coated glas fiber cover, DN 300
01850050	Double bag with aluminium coated glas fiber cover, DN 310
01850051	Double bag with aluminium coated glas fiber cover, DN 350
01850052	Double bag with aluminium coated glas fiber cover, DN 400
01850053	Double bag with aluminium coated glas fiber cover, DN 450
01850054	Double bag with aluminium coated glas fiber cover, DN 500
01850055	Double bag with aluminium coated glas fiber cover, DN 550
01850056	Double bag with aluminium coated glas fiber cover, DN 600
01850057	Double bag with aluminium coated glas fiber cover, DN 650
01850058	Double bag with aluminium coated glas fiber cover, DN 700
01850059	Double bag with aluminium coated glas fiber cover, DN 750
01850060	Double bag with aluminium coated glas fiber cover, DN 800

Zubehör Doppelblasen zum Formiergasschweißen

Order no.	Product
01850061	Surcharge for extension hose, with manometer and ball valve
01850062	Surcharge for extension hose, with manometer and ball valve
01850063	Surcharge for extension hose, with manometer and ball valve
01850065	Surcharge for extension hose, per metre for bladder filling, 1,00



Single bags

Single bladder for forming gas welding - from DN 40 to DN 1100

- with additional cover from aluminium-coated glass fibre (flying sparks).

Order no.	Product
01860001	Single bag with aluminium coated glas fiber cover, DN 40
01860002	Single bag with aluminium coated glas fiber cover, DN 50
01860003	Single bag with aluminium coated glas fiber cover, DN 60
01860004	Single bag with aluminium coated glas fiber cover, DN 80
01860005	Single bag with aluminium coated glas fiber cover, DN 100
01860006	Single bag with aluminium coated glas fiber cover, DN 110
01860007	Single bag with aluminium coated glas fiber cover, DN 125
01860008	Single bag with aluminium coated glas fiber cover, DN 140
01860009	Single bag with aluminium coated glas fiber cover, DN 150
01860010	Single bag with aluminium coated glas fiber cover, DN 160
01860011	Single bag with aluminium coated glas fiber cover, DN 175
01860012	Single bag with aluminium coated glas fiber cover, DN 200
01860013	Single bag with aluminium coated glas fiber cover, DN 210
01860014	Single bag with aluminium coated glas fiber cover, DN 225
01860015	Single bag with aluminium coated glas fiber cover, DN 250
01860016	Single bag with aluminium coated glas fiber cover, DN 260
01860017	Single bag with aluminium coated glas fiber cover, DN 300
01860018	Single bag with aluminium coated glas fiber cover, DN 310
01860019	Single bag with aluminium coated glas fiber cover, DN 350
01860020	Single bag with aluminium coated glas fiber cover, DN 400
01860021	Single bag with aluminium coated glas fiber cover, DN 450
01860022	Single bag with aluminium coated glas fiber cover, DN 500
01860023	Single bag with aluminium coated glas fiber cover, DN 550
01860024	Single bag with aluminium coated glas fiber cover, DN 600
01860025	Single bag with aluminium coated glas fiber cover, DN 650
01860026	Single bag with aluminium coated glas fiber cover, DN 700
01860027	Single bag with aluminium coated glas fiber cover, DN 750
01860028	Single bag with aluminium coated glas fiber cover, DN 800
01860029	Single bag with aluminium coated glas fiber cover, DN 900
01860030	Single bag with aluminium coated glas fiber cover, DN 1000
01860031	Single bag with aluminium coated glas fiber cover, DN 1100

Replacement covers and rubber bladders

Replacement covers for all S+B gas bags

for bags with core-ID: 0090, 0091, 0095, 0120, 0130, 0140, 0145, 0150, 0180, 0185, 0190

Order no.	Product
00950074	MDH plastic cover, DN 40
00950075	MDH plastic cover, DN 50
00950076	MDH plastic cover, DN 60
01200147	MDH plastic cover, DN 75
01200117	MDH plastic cover, DN 100
00950077	MDH plastic cover, DN 110
01200120	MDH plastic cover, DN 125
01200118	MDH plastic cover, DN 150
00950078	MDH plastic cover, DN 160
00950079	MDH plastic cover, DN 175
01200121	MDH plastic cover, DN 200
00950080	MDH plastic cover, DN 210
01200122	MDH plastic cover, DN 250
01850081	MDH plastic cover, DN 260
01200123	MDH plastic cover, DN 300
00950082	MDH plastic cover, DN 310
00950083	MDH plastic cover, DN 350
00950084	MDH plastic cover, DN 400
00950085	MDH plastic cover, DN 450
01200158	MDH plastic cover, DN 500
00950087	MDH plastic cover, DN 550
00950088	MDH plastic cover, DN 600
00950089	MDH plastic cover, DN 700
00950090	MDH plastic cover, DN 750
00950091	MDH plastic cover, DN 800
01200157	MDH plastic cover, DN 900
00950093	MDH plastic cover, DN 1000
00950094	MDH plastic cover, DN 1100
00950095	MDH plastic cover, DN 1200
00950096	MDH plastic cover, DN 1300
00950097	MDH plastic cover, DN 1400
00950098	MDH plastic cover, DN 1500
00950099	MDH plastic cover, DN 1600

Replacement covers for all S+B gas bags

for bags with core-ID: 0160, 0170

Order no.	Product
01030001	HDH plastic cover, DN 40
01030002	HDH plastic cover, DN 50
01030003	HDH plastic cover, DN 60
01030004	HDH plastic cover, DN 80
01030005	HDH plastic cover, DN 100
01030006	HDH plastic cover, DN 110
01030007	HDH plastic cover, DN 125
01030008	HDH plastic cover, DN 150
01030009	HDH plastic cover, DN 160
01030010	HDH plastic cover, Dn 175
01030011	HDH plastic cover, DN 200
01030012	HDH plastic cover, DN 210
01030013	HDH plastic cover, DN 250
01030014	HDH plastic cover, DN 260
01030015	HDH plastic cover, DN 275
01030016	HDH plastic cover, DN 300
01030017	HDH plastic cover, DN 310
01030018	HDH plastic cover, DN 350
01030019	HDH plastic cover, DN 400
01030020	HDH plastic cover, DN 450
01030021	HDH plastic cover, DN 500
01030022	HDH plastic cover, DN 550
01030023	HDH plastic cover, DN 600
01030024	HDH plastic cover, DN 650
01030025	HDH plastic cover, DN 700
01030026	HDH plastic cover, DN 750
01030027	HDH plastic cover, DN 800
01030028	HDH plastic cover, DN 900
01030029	HDH plastic cover, DN 1000
01030030	HDH plastic cover, DN 1100
01030031	HDH plastic cover, DN 1200
01030032	HDH plastic cover, DN 1300
01030033	HDH plastic cover, DN 1400
01030034	HDH plastic cover, DN 1500
01030035	HDH plastic cover, DN 1600

Replacement covers for forming gas bags

Order no.	Product
01040001	FFH cover/ aluminium coated glas fiber cover, DN 50
01040002	FFH cover/ aluminium coated glas fiber cover, DN 60
01040003	FFH cover/ aluminium coated glas fiber cover, DN 80
01040004	FFH cover/ aluminium coated glas fiber cover, DN 100
01040005	FFH cover/ aluminium coated glas fiber cover, DN 110
01040006	FFH cover/ aluminium coated glas fiber cover, DN 125
01040007	FFH cover/ aluminium coated glas fiber cover, DN 140
01040008	FFH cover/ aluminium coated glas fiber cover, DN 150
01040009	FFH cover/ aluminium coated glas fiber cover, DN 160
01040010	FFH cover/ aluminium coated glas fiber cover, DN 175
01040011	FFH cover/ aluminium coated glas fiber cover, DN 200
01040012	FFH cover/ aluminium coated glas fiber cover, DN 210
01040013	FFH cover/ aluminium coated glas fiber cover, DN 250
01040015	FFH cover/ aluminium coated glas fiber cover, DN 300
01040016	FFH cover/ aluminium coated glas fiber cover, DN 310
01040016	FFH cover/ aluminium coated glas fiber cover, DN 310
01040017	FFH cover/ aluminium coated glas fiber cover, DN 350
01040018	FFH cover/ aluminium coated glas fiber cover, DN 400
01040019	FFH cover/ aluminium coated glas fiber cover, DN 450
01040020	FFH cover/ aluminium coated glas fiber cover, DN 500
01040021	FFH cover/ aluminium coated glas fiber cover, DN 550
01040022	FFH cover/ aluminium coated glas fiber cover, DN 600
01040023	FFH cover/ aluminium coated glas fiber cover, DN 650
01040024	FFH cover/ aluminium coated glas fiber cover, DN 700
01040025	FFH cover/ aluminium coated glas fiber cover, DN 750
01040026	FFH cover/ aluminium coated glas fiber cover, DN 800

Replacement bladders made of natural rubber

for bags with core-ID: 0120, 0130, 0140, 0145, 0150, 0180, 0185, 0190, 0960, 0961

Order no.	Product
00950042	Replacement bladder, natural rubber, DN 50
00950043	Replacement bladder, natural rubber, DN 60
00950007	Replacement bladder, natural rubber, DN 80
00950020	Replacement bladder, natural rubber, DN 100
00950044	Replacement bladder, natural rubber, DN 125
00950027	Replacement bladder, natural rubber, DN 150
00950045	Replacement bladder, natural rubber, DN 175
00950032	Replacement bladder, natural rubber, DN 200
00950035	Replacement bladder, natural rubber, DN 250
00950039	Replacement bladder, natural rubber, DN 300
00950046	Replacement bladder, natural rubber, DN 350
00950047	Replacement bladder, natural rubber, DN 400
00950048	Replacement bladder, natural rubber, DN 450
00950049	Replacement bladder, natural rubber, DN 500
00950050	Replacement bladder, natural rubber, DN 600
00950051	Replacement bladder, natural rubber, DN 700
00950052	Replacement bladder, natural rubber, DN 800
00950053	Replacement bladder, natural rubber, DN 900
00950054	Replacement bladder, natural rubber, DN 1000
00950055	Replacement bladder, natural rubber, DN 1100
00950056	Replacement bladder, natural rubber, DN 1200
00950057	Replacement bladder, natural rubber, DN 1300
00950058	Replacement bladder, natural rubber, DN 1400
00950059	Replacement bladder, natural rubber, DN 1500
00950060	Replacement bladder, natural rubber, DN 1600
00950061	Replacement bladder, natural rubber, DN 1700
00950062	Replacement bladder, natural rubber, DN 1800
00950063	Replacement bladder, natural rubber, DN 1900
00950064	Replacement bladder, natural rubber, DN 2000

Replacement bladders for oil and chemical resistant bags

for bags with core-ID: 0120, 0130, 0140, 0145, 0150, 0180, 0185, 0190, 0960, 0961

Order no.	Product
00120062	Replacement bladder, CR (chloroprene), DN 40
00120063	Replacement bladder, CR (chloroprene), DN 50
00120064	Replacement bladder, CR (chloroprene), DN 60
00120065	Replacement bladder, CR (chloroprene), DN 80
00120066	Replacement bladder, CR (chloroprene), DN 100
00120067	Replacement bladder, CR (chloroprene), DN 125
00120068	Replacement bladder, CR (chloroprene), DN 150
00120069	Replacement bladder, CR (chloroprene), DN 175
00120070	Replacement bladder, CR (chloroprene), DN 200
00120071	Replacement bladder, CR (chloroprene), DN 250
00120072	Replacement bladder, CR (chloroprene), DN 300
00120073	Replacement bladder, CR (chloroprene), DN 350
00120074	Replacement bladder, CR (chloroprene), DN 400
00120075	Replacement bladder, CR (chloroprene), DN 450
00120076	Replacement bladder, CR (chloroprene), DN 500
00120077	Replacement bladder, CR (chloroprene), DN 600
00120078	Replacement bladder, CR (chloroprene), DN 700
00120079	Replacement bladder, CR (chloroprene), DN 800
00120080	Replacement bladder, CR (chloroprene), DN 900
00120081	Replacement bladder, CR (chloroprene), DN 1000
00120082	Replacement bladder, CR (chloroprene), DN 1100
00120083	Replacement bladder, CR (chloroprene), DN 1200

House connection equipment (HC)

HC - Glove lock



HC-glove locks are used for gas-free changing of main shut-off units of service lines from 1" to 3" and armatures from in-use pipelines at the house connection lines.



Available models

Order no.	Product
70000021	HC-glove lock for right-handed, 1"
70000018	HC-glove lock for right-handed, 1 1/2"
70000022	HC-glove lock for right-handed, 1 1/4"
70000019	HC-glove lock for right-handed, 2"
70000020	HC-glove lock for right-handed, 2 1/2"
70000023	HC-glove lock for right-handed, 3"

Delivery

- Glove lock
- Screw clamp

Gas lock for main shut-off units



Gas locks are used for safe work on gas line, especially for changing main shut-off units on in-use gas lines.

The gas lock for main shut-off units is equipped with a connection from 1" to 4" external thread, sideways ball valve ¼" and a stuffing box with hex. nut SW32 for the bag-hose



Versions

Order no.	Product
02810037	Gas lock with ball valve, 1" ET
02810038	Gas lock with ball valve, 1 ¼" ET
02810039	Gas lock with ball valve, 1 ½" ET
02810040	Gas lock with ball valve, 2" ET
02810041	Gas lock with ball valve, 2 ½" ET
02810042	Gas lock with ball valve, 3" ET
02810043	Gas lock with ball valve, 4" ET

Delivery

- Gas lock

Accessories

Adapter for gas locks



Order no.	Product
02810062	Adapter 2" IT x 1" ET
02810063	Adapter 2" IT x 1 ¼" ET
02810064	Adapter 2" IT x 1 ½" ET
02810065	Adapter 2" IT x 2 ½" ET
02810066	Adapter 2" IT x 3" ET

HC gas bags



The HC gas bags are multi-dimensional bags that's why it is possible to shut-off the diameter range from 3/4" to 2" pipelines with only two devices. In combination with the HC locks for HC bags it is possible to change a main shut-off unit for house connections without any gas leakage on an operating system according to the requirements of the BGR500.

The version with a short bag allow a gas-free changing of gas meters without shutting-off the entire building or later ventilation.

The HC bags are supported by a thick walled PA-push rod with an included steel-helix as kink protection.

The push rod diameter are 8, 10 and 12 mm. The stock length of all devices are 0,8 m. The maximum length is 10 m. You can choose Schrader or Dunlop valves for the intake of all versions of HC bags.

Delivery

Stock length: 800 mm

Possible connections:

- Dunlop valve
- Schrader valve
- Coupling type 20

Custom versions are possible on request.

Model "Superflex" - ø 8 mm

Order no.	Product
02810089	HC short bag with Dunlop valve, 3/4" - 1 1/4"
02810090	HC short bag with Schrader valve, 3/4" - 1 1/4"
02810085	HC bag "Superflex" with Dunlop valve, 3/4" - 1 1/4"
02810087	HC bag "Superflex" with Schrader valve, 3/4" - 1 1/4"
02810086	HC bag "Superflex" with Dunlop valve, 1 1/2" - 2 1/2"
02810088	HC bag "Superflex" with Schrader valve, 1 1/2" - 2 1/2"

Model "special" - ø 10 mm

Order no.	Product
02810081	HC bag with Dunlop valve, 3/4" - 1 1/4"
02810083	HC bag with Schrader valve, 3/4" - 1 1/4"
02810082	HC bag with Dunlop valve, 1 1/2" - 2 1/2"
02810084	HC bag with Schrader valve, 1 1/2" - 2 1/2"
02810093	HC bag with Schrader valve, 3" - 4"

Model "special" - ø 12 mm

Order no.	Product
02810091	HC bag with Schrader valve, 3"

PA-hose extension

Order no.	Product
02810223	1,00 m PA-hose extension ø 8 mm
02810224	1,00 m PA-hose extension ø 10 mm

Spareparts for HC bags

HC replacement bags

Order no.	Product
02810129	HC replacement short bag, 3/4" - 1 1/4"
02810002	HC replacement bag, 3/4" - 1 1/4"
02810003	HC replacement bag, 1 1/2" - 2 1/2"

Accessories for HC bags

Handpump

Order no.	Product
02810126	Small hand pump 0-6 bar
99980234	Silicone spray



Spezialverschlußstopfen

Order no.	Product
70000046	Spezialverschlußstopfen für Handschuhschleuse 3/4", DN 20
70000024	Spezialverschlußstopfen für Handschuhschleuse 1 ", DN 25
70000047	Spezialverschlußstopfen für Handschuhschleuse 1 1/4", DN 35
70000025	Spezialverschlußstopfen für Handschuhschleuse 1 1/2", DN 40
70000026	Spezialverschlußstopfen für Handschuhschleuse 2", DN 50
70000027	Spezialverschlußstopfen für Handschuhschleuse 2 1/2", DN 65

Pipe plugs

Pipe plugs are used to stop pipe lines temporarily. They are characterized by a **simple operability** and they are **very robust**. It also allows leak test according to DIN EN 1610 **quickly and uncomplicated**. All pipe plugs are corrosion resistant.

They are available in different versions, for example:

- With mechanical or pneumatic actuation
- In special high pressure versions
- With or without passage
- With chemical resistant sealing
- With one or more sealing
- With different tightening screws
- With all commercial connections
- With prop up plate

Individual solutions are available on request.

Please keep in mind, when you are using pipe plugs or a similar pipe stopping device, you have to secure the temporarily shut-off situation rule complaint with a stable support.

Overview for all plugs

Feature	346	347	345mech	345pneu	300mech	300pneu	330	350	360	402	420	441
conical rubber										x	x	x
cylindric rubber	x	x	x	x	x	x	x	x	x	x	x	x
with passage	x	x		x	x	x		x	x	x		
with ball valve				x	x	x		x	x			x
1x sealing	x		x	x					x	x	x	x
2x sealing		x			x	x	x	x				
3x sealing												
with pressure gauge												x



Mechanical pipe plugs

Plugs for pressureless use



with one sealing ring (type 346)

Order no.	Product
03460001	Plug, pressureless use, 1 ring, DN 12
03460002	Plug, pressureless use, 1 ring, DN 19
03460003	Plug, pressureless use, 1 ring, DN 25
03460004	Plug, pressureless use, 1 ring, DN 32
03460005	Plug, pressureless use, 1 ring, DN 40
03460006	Plug, pressureless use, 1 ring, DN 50
03460007	Plug, pressureless use, 1 ring, DN 65
03460008	Plug, pressureless use, 1 ring, DN 75
03460009	Plug, pressureless use, 1 ring, DN 85
03460010	Plug, pressureless use, 1 ring, DN 100
03460011	Plug, pressureless use, 1 ring, DN 114
03460012	Plug, pressureless use, 1 ring, DN 125
03460013	Plug, pressureless use, 1 ring, DN 150
03460014	Plug, pressureless use, 1 ring, DN 175
03460015	Plug, pressureless use, 1 ring, DN 200
03460016	Plug, pressureless use, 1 ring, DN 225
03460017	Plug, pressureless use, 1 ring, DN 250
03460018	Plug, pressureless use, 1 ring, DN 275
03460019	Plug, pressureless use, 1 ring, DN 300
03460020	Plug, pressureless use, 1 ring, DN 350
03460021	Plug, pressureless use, 1 ring, DN 375
03460022	Plug, pressureless use, 1 ring, DN 400
03460023	Plug, pressureless use, 1 ring, DN 430
03460024	Plug, pressureless use, 1 ring, DN 450
03460025	Plug, pressureless use, 1 ring, DN 475
03460026	Plug, pressureless use, 1 ring, DN 500
03460027	Plug, pressureless use, 1 ring, DN 525
03460028	Plug, pressureless use, 1 ring, DN 550
03460029	Plug, pressureless use, 1 ring, DN 580
03460030	Plug, pressureless use, 1 ring, DN 600
03460031	Plug, pressureless use, 1 ring, DN 650
03460032	Plug, pressureless use, 1 ring, DN 675
03460033	Plug, pressureless use, 1 ring, DN 700
03460034	Plug, pressureless use, 1 ring, DN 750
03460035	Plug, pressureless use, 1 ring, DN 800
03460036	Plug, pressureless use, 1 ring, DN 900
03460037	Plug, pressureless use, 1 ring, DN 1000

Pipe plug (type 345)



from DN 12 to DN 75

- High-quality version

Order no.	Product
03450049	Plug, HQ version, DN 12, max. operating pressure 30,0 bar
03450846	Plug, HQ version, DN 13, max. operating pressure 30,0 bar
03450063	Plug, HQ version, DN 14, max. operating pressure 30,0 bar
03450839	Plug, HQ version, DN 16, max. operating pressure 30,0 bar
03450070	Plug, HQ version, DN 20, max. operating pressure 30,0 bar
03450083	Plug, HQ version, DN 25, max. operating pressure 30,0 bar
03450089	Plug, HQ version, DN 30, max. operating pressure 25,0 bar
03450090	Plug, HQ version, DN 35, max. operating pressure 20,0 bar
03450101	Plug, HQ version, DN 40, max. operating pressure 20,0 bar
03451025	Plug, HQ version, DN 45, max. operating pressure 20,0 bar
03450105	Plug, HQ version, DN 50, max. operating pressure 20,0 bar
03451008	Plug, HQ version, DN 55, max. operating pressure 15,0 bar
03450113	Plug, HQ version, DN 60, max. operating pressure 15,0 bar
03450121	Plug, HQ version, DN 65, max. operating pressure 15,0 bar
03450125	Plug, HQ version, DN 70, max. operating pressure 10,0 bar
03450129	Plug, HQ version, DN 75, max. operating pressure 8,0 bar



from DN 80 to DN 600

- High-quality version

Order no.	Product
03450139	Plug, HQ version, DN 80, max. operating pressure 3,6 bar
03450152	Plug, HQ version, DN 90, max. operating pressure 3,3 bar
03450160	Plug, HQ version, DN 100, max. operating pressure 3,0 bar
03450164	Plug, HQ version, DN 110, max. operating pressure 2,8 bar
03450168	Plug, HQ version, DN 125, max. operating pressure 2,7 bar
03450171	Plug, HQ version, DN 130, max. operating pressure 2,6 bar
03450174	Plug, HQ version, DN 140, max. operating pressure 2,5 bar
03450177	Plug, HQ version, DN 150, max. operating pressure 2,4 bar
03450180	Plug, HQ version, DN 160, max. operating pressure 2,2 bar
03450188	Plug, HQ version, DN 175, max. operating pressure 2,1 bar
03450192	Plug, HQ version, DN 190, max. operating pressure 1,9 bar
03450195	Plug, HQ version, DN 200, max. operating pressure 1,8 bar
03450198	Plug, HQ version, DN 210, max. operating pressure 1,7 bar
03450206	Plug, HQ version, DN 225, max. operating pressure 1,6 bar
03450219	Plug, HQ version, DN 235, max. operating pressure 1,6 bar
03450224	Plug, HQ version, DN 250, max. operating pressure 1,5 bar
03450228	Plug, HQ version, DN 260, max. operating pressure 1,3 bar
03450716	Plug, HQ version, DN 275, max. operating pressure 1,2 bar
03450232	Plug, HQ version, DN 300, max. operating pressure 1,2 bar
03450247	Plug, HQ version, DN 310, max. operating pressure 1,0 bar
03450250	Plug, HQ version, DN 350, max. operating pressure 0,9 bar
03450263	Plug, HQ version, DN 400, max. operating pressure 0,6 bar
03450268	Plug, HQ version, DN 450, max. operating pressure 0,5 bar
03450273	Plug, HQ version, DN 500, max. operating pressure 0,5 bar
03450278	Plug, HQ version, DN 600, max. operating pressure 0,5 bar



Surcharge for safety screwing

Order no.	Product
03000764	Surcharge for special lock nut M10 for art. 345 DN 16-40
03000765	Surcharge for special lock nut M12 for art. 345 DN 55
03000766	Surcharge for special lock nut M16 for art. 345 DN 70-100



From DN 25 to DN 600 with passage

- Passage with ball valve

Order no.	Product
03450630	Plug, passage with ball valve ¼", DN 25, 30,0 bar
03450631	Plug, passage with ball valve ¼", DN 30, 25,0 bar
03450632	Plug, passage with ball valve ¼", DN 35, 20,0 bar
03450633	Plug, passage with ball valve ¼", DN 40, 20,0 bar
03450634	Plug, passage with ball valve ¼", DN 50, 20,0 bar
03450635	Plug, passage with ball valve ¼", DN 60, 15,0 bar
03450636	Plug, passage with ball valve ¼", DN 65, 15,0 bar
03450637	Plug, passage with ball valve ¼", DN 70, 10,0 bar
03450638	Plug, passage with ball valve ¼", DN 75, 8,0 bar
03450457	Plug, passage with ball valve 1", DN 80, 3,6 bar
03450472	Plug, passage with ball valve 1", DN 90, 3,3 bar
03450475	Plug, passage with ball valve 1", DN 100, 3,0 bar
03450478	Plug, passage with ball valve 1", DN 110, 2,8 bar
03450481	Plug, passage with ball valve 1", DN 125, 2,7 bar
03450484	Plug, passage with ball valve 1", DN 130, 2,6 bar
03450487	Plug, passage with ball valve 1", DN 140, 2,5 bar
03450490	Plug, passage with ball valve 1", DN 150, 2,4 bar
03450493	Plug, passage with ball valve 1", DN 160, 2,2 bar
03450496	Plug, passage with ball valve 1", DN 175, 2,1 bar
03450499	Plug, passage with ball valve 1", DN 190, 1,9 bar
03450502	Plug, passage with ball valve 1", DN 200, 1,8 bar
03450505	Plug, passage with ball valve 1", DN 210, 1,7 bar
03450508	Plug, passage with ball valve 1", DN 225, 1,7 bar
03450513	Plug, passage with ball valve 1", DN 235, 1,6 bar
03450516	Plug, passage with ball valve 1¼", DN 250, 1,5 bar
03450531	Plug, passage with ball valve 1¼", DN 260, 1,3 bar
03450534	Plug, passage with ball valve 1¼", DN 300, 1,2 bar
03450537	Plug, passage with ball valve 1¼", DN 310, 1,0 bar
03450548	Plug, passage with ball valve 2", DN 350, 0,9 bar
03450553	Plug, passage with ball valve 2", DN 400, 0,6 bar
03450556	Plug, passage with ball valve 2", DN 450, 0,5 bar
03450559	Plug, passage with ball valve 2", DN 500, 0,5 bar
03450562	Plug, passage with ball valve 2", DN 550, 0,5 bar
03450566	Plug, passage with ball valve 2", DN 600, 0,5 bar

Pipe plugs for higher pressure (type 300, 330, 350, 360)

with handle



- two sealing rings
- Passage with ball valve
- plug type 26

Order no.	Product
03000001	Plug with passage, mech., DN 14, max. operating pressure 30,0 bar
03000352	Plug with passage, mech., DN 16, max. operating pressure 30,0 bar
03000014	Plug with passage, mech., DN 20, max. operating pressure 30,0 bar
03000023	Plug with passage, mech., DN 25, max. operating pressure 30,0 bar
03000026	Plug with passage, mech., DN 30, max. operating pressure 25,0 bar
03000036	Plug with passage, mech., DN 35, max. operating pressure 20,0 bar
03000040	Plug with passage, mech., DN 40, max. operating pressure 20,0 bar
03000726	Plug with passage, mech., DN 45, max. operating pressure 20,0 bar
03000044	Plug with passage, mech., DN 50, max. operating pressure 20,0 bar
03000646	Plug with passage, mech., DN 55, max. operating pressure 15 bar
03000048	Plug with passage, mech., DN 60, max. operating pressure 15,0 bar
03000051	Plug with passage, mech., DN 65, max. operating pressure 15,0 bar
03000054	Plug with passage, mech., DN 70, max. operating pressure 10,0 bar
03000057	Plug with passage, mech., DN 75, max. operating pressure 10,0 bar
03000078	Plug with passage, mech., DN 80, max. operating pressure 6,0 bar
03000091	Plug with passage, mech., DN 90, max. operating pressure 5,5 bar
03000094	Plug with passage, mech., DN 100, max. operating pressure 5,0 bar
03000097	Plug with passage, mech., DN 110, max. operating pressure 4,8 bar
03000100	Plug with passage, mech., DN 125, max. operating pressure 4,5 bar
03000103	Plug with passage, mech., DN 130, max. operating pressure 4,2 bar
03000106	Plug with passage, mech., DN 140, max. operating pressure 4,2 bar
03000109	Plug with passage, mech., DN 150, max. operating pressure 4,0 bar
03000112	Plug with passage, mech., DN 160, max. operating pressure 3,8 bar
03000115	Plug with passage, mech., DN 175, max. operating pressure 3,5 bar
03000118	Plug with passage, mech., DN 190, max. operating pressure 3,2 bar
03000135	Plug with passage, mech., DN 200, max. operating pressure 3,0 bar
03000140	Plug with passage, mech., DN 210, max. operating pressure 2,8 bar
03000145	Plug with passage, mech., DN 225, max. operating pressure 2,6 bar
03000148	Plug with passage, mech., DN 235, max. operating pressure 2,5 bar
03000150	Plug with passage, mech., DN 250, max. operating pressure 2,5 bar
03000153	Plug with passage, mech., DN 260, max. operating pressure 2,4 bar
03000156	Plug with passage, mech., DN 275, max. operating pressure 2,0 bar
03000174	Plug with passage, mech., DN 300, max. operating pressure 2,0 bar
03000178	Plug with passage, mech., DN 310, max. operating pressure 2,0 bar
03000195	Plug with passage, mech., DN 350, max. operating pressure 1,5 bar
03000196	Plug with passage, mech., DN 400, max. operating pressure 1,0 bar
03000197	Plug with passage, mech., DN 450, max. operating pressure 0,5 bar
03000198	Plug with passage, mech., DN 500, max. operating pressure 0,5 bar
03000199	Plug with passage, mech., DN 600, max. operating pressure 0,5 bar



Surcharge distance tube to 150 mm

Order no.	Product
03000767	Surcharge for distance tube 150 mm for art. 300 DN 16-25
03000768	Surcharge for distance tube 150 mm for art. 300 DN 35-100



with hex. nut

- two sealing rings

Order no.	Product
03300001	Plug, mech., with hex. nut, DN 14, max. operating pressure 30,0 bar
03300003	Plug, mech., with hex. nut, DN 20, max. operating pressure 30,0 bar
03300005	Plug, mech., with hex. nut, DN 25, max. operating pressure 30,0 bar
03300007	Plug, mech., with hex. nut, DN 30, max. operating pressure 25,0 bar
03300065	Plug, mech., with hex. nut, DN 35, max. operating pressure 20,0 bar
03300009	Plug, mech., with hex. nut, DN 40, max. operating pressure 20,0 bar
03300011	Plug, mech., with hex. nut, DN 50, max. operating pressure 20,0 bar
03300013	Plug, mech., with hex. nut, DN 60, max. operating pressure 15,0 bar
03300015	Plug, mech., with hex. nut, DN 65, max. operating pressure 15,0 bar
03300017	Plug, mech., with hex. nut, DN 70, max. operating pressure 10,0 bar
03300019	Plug, mech., with hex. nut, DN 75, max. operating pressure 8,0 bar
03300021	Plug, mech., with hex. nut, DN 80, max. operating pressure 6,0 bar
03300023	Plug, mech., with hex. nut, DN 90, max. operating pressure 5,5 bar
03300025	Plug, mech., with hex. nut, DN 100, max. operating pressure 5,0 bar
03300027	Plug, mech., with hex. nut, DN 110, max. operating pressure 4,8 bar
03300029	Plug, mech., with hex. nut, DN 125, max. operating pressure 4,5 bar
03300031	Plug, mech., with hex. nut, DN 130, max. operating pressure 4,3 bar
03300033	Plug, mech., with hex. nut, DN 140, max. operating pressure 4,2 bar
03300035	Plug, mech., with hex. nut, DN 150, max. operating pressure 4,0 bar
03300037	Plug, mech., with hex. nut, DN 160, max. operating pressure 3,8 bar
03300039	Plug, mech., with hex. nut, DN 175, max. operating pressure 3,5 bar
03300041	Plug, mech., with hex. nut, DN 190, max. operating pressure 3,2 bar
03300043	Plug, mech., with hex. nut, DN 200, max. operating pressure 3,0 bar
03300045	Plug, mech., with hex. nut, DN 210, max. operating pressure 2,8 bar
03300047	Plug, mech., with hex. nut, DN 225, max. operating pressure 2,6 bar
03300049	Plug, mech., with hex. nut, DN 235, max. operating pressure 2,5 bar
03300051	Plug, mech., with hex. nut, DN 250, max. operating pressure 2,5 bar
03300053	Plug, mech., with hex. nut, DN 260, max. operating pressure 2,4 bar
03300055	Plug, mech., with hex. nut, DN 300, max. operating pressure 2,0 bar
03300057	Plug, mech., with hex. nut, DN 310, max. operating pressure 2,0 bar
03300059	Plug, mech., with hex. nut, DN 350, max. operating pressure 1,5 bar
03300061	Plug, mech., with hex. nut, DN 400, max. operating pressure 1,0 bar
03300063	Plug, mech., with hex. nut, DN 450, max. operating pressure 0,5 bar
03300064	Plug, mech., with hex. nut, DN 500, max. operating pressure 0,5 bar



High pressure version up to 30 bar

- Passage with ball valve
- prop up plate
- two sealing rings
- hex. nut

Order no.	Product
03500001	Plug, with prop up plate, DN 12, max. operating pressure 30,0 bar
03500002	Plug, with prop up plate, DN 14, max. operating pressure 30,0 bar
03500003	Plug, with prop up plate, DN 20, max. operating pressure 30,0 bar
03500004	Plug, with prop up plate, DN 25, max. operating pressure 30,0 bar
03500005	Plug, with prop up plate, DN 30, max. operating pressure 25,0 bar
03500006	Plug, with prop up plate, DN 35, max. operating pressure 20,0 bar
03500007	Plug, with prop up plate, DN 40, max. operating pressure 20,0 bar
03500008	Plug, with prop up plate, DN 50, max. operating pressure 20,0 bar
03500009	Plug, with prop up plate, DN 60, max. operating pressure 16,0 bar
03500010	Plug, with prop up plate, DN 65, max. operating pressure 16,0 bar
03500011	Plug, with prop up plate, DN 70, max. operating pressure 16,0 bar
03500012	Plug, with prop up plate, DN 75, max. operating pressure 16,0 bar
03500013	Plug, with prop up plate, DN 80, max. operating pressure 16,0 bar
03500014	Plug, with prop up plate, DN 90, max. operating pressure 16,0 bar
03500015	Plug, with prop up plate, DN 100, max. operating pressure 16,0 bar
03500016	Plug, with prop up plate, DN 110, max. operating pressure 15,5 bar
03500017	Plug, with prop up plate, DN 125, max. operating pressure 15,0 bar
03500018	Plug, with prop up plate, DN 140, max. operating pressure 14,0 bar
03500019	Plug, with prop up plate, DN 150, max. operating pressure 13,0 bar
03500020	Plug, with prop up plate, DN 160, max. operating pressure 12,5 bar
03500021	Plug, with prop up plate, DN 175, max. operating pressure 12,0 bar
03500022	Plug, with prop up plate, DN 190, max. operating pressure 12,0 bar
03500023	Plug, with prop up plate, DN 200, max. operating pressure 11,5 bar
03500024	Plug, with prop up plate, DN 210, max. operating pressure 11,2 bar
03500025	Plug, with prop up plate, DN 225, max. operating pressure 11,0 bar
03500026	Plug, with prop up plate, DN 235, max. operating pressure 10,0 bar
03500027	Plug, with prop up plate, DN 250, max. operating pressure 10,0 bar
03500028	Plug, with prop up plate, DN 260, max. operating pressure 9,5 bar
03500124	Plug, with prop up plate, DN 275, max. operating pressure 9,0 bar
03500029	Plug, with prop up plate, DN 300, max. operating pressure 9,0 bar
03500030	Plug, with prop up plate, DN 310, max. operating pressure 8,5 bar
03500031	Plug, with prop up plate, DN 350, max. operating pressure 7,0 bar
03500032	Plug, with prop up plate, DN 400, max. operating pressure 6,0 bar
03500033	Plug, with prop up plate, DN 450, max. operating pressure 5,0 bar bar
03500034	Plug, with prop up plate, DN 500, max. operating pressure 4,5 bar



High pressure version up to 100 bar

- High-quality version
- Very stable design
- Passage with ball valve
- prop up plate
- hex. nut

Order no.	Product
03600001	Plug, with prop up plate, DN 12, max. operating pressure 100,0 bar
03600002	Plug, with prop up plate, DN 14, max. operating pressure 100,0 bar
03600003	Plug, with prop up plate, DN 20, max. operating pressure 100,0 bar
03600004	Plug, with prop up plate, DN 25, max. operating pressure 100,0 bar
03600005	Plug, with prop up plate, DN 30, max. operating pressure 100,0 bar
03600006	Plug, with prop up plate, DN 35, max. operating pressure 100,0 bar
03600007	Plug, with prop up plate, DN 40, max. operating pressure 100,0 bar
03600008	Plug, with prop up plate, DN 50, max. operating pressure 100,0 bar
03600009	Plug, with prop up plate, DN 60, max. operating pressure 100,0 bar
03600010	Plug, with prop up plate, DN 65, max. operating pressure 100,0 bar
03600011	Plug, with prop up plate, DN 70, max. operating pressure 100,0 bar
03600012	Plug, with prop up plate, DN 75, max. operating pressure 100,0 bar
03600013	Plug, with prop up plate, DN 80, max. operating pressure 100,0 bar
03600014	Plug, with prop up plate, DN 90, max. operating pressure 100,0 bar
03600015	Plug, with prop up plate, DN 100, max. operating pressure 100,0 bar
03600016	Plug, with prop up plate, DN 110, max. operating pressure 95,0 bar
03600017	Plug, with prop up plate, DN 125, max. operating pressure 92,5 bar
03600018	Plug, with prop up plate, DN 140, max. operating pressure 90,0 bar
03600019	Plug, with prop up plate, DN 150, max. operating pressure 90,0 bar
03600020	Plug, with prop up plate, DN 160, max. operating pressure 88,0 bar
03600021	Plug, with prop up plate, DN 175, max. operating pressure 85,0 bar
03600022	Plug, with prop up plate, DN 190, max. operating pressure 80,0 bar
03600023	Plug, with prop up plate, DN 200, max. operating pressure 80,0 bar
03600024	Plug, with prop up plate, DN 210, max. operating pressure 77,5 bar
03600025	Plug, with prop up plate, DN 225, max. operating pressure 75,0 bar
03600026	Plug, with prop up plate, DN 250, max. operating pressure 70,0 bar
03600027	Plug, with prop up plate, DN 260, max. operating pressure 65,0 bar
03600028	Plug, with prop up plate, DN 275, max. operating pressure 60,0 bar
03600029	Plug, with prop up plate, DN 300, max. operating pressure 60,0 bar
03600030	Plug, with prop up plate, DN 310, max. operating pressure 57,0 bar

03600031	Plug, with prop up plate, DN 350, max. operating pressure 50,0 bar
03600032	Plug, with prop up plate, DN 400, max. operating pressure 35,0 bar
03600033	Plug, with prop up plate, DN 450, max. operating pressure 30,0 bar
03600034	Plug, with prop up plate, DN 500, max. operating pressure 30,0 bar
03600035	Plug, with prop up plate, DN 600, max. operating pressure 25,0 bar
03600036	Plug, with prop up plate, DN 700, max. operating pressure 20,0 bar
03600037	Plug, with prop up plate, DN 800, max. operating pressure 18,0 bar
03600038	Plug, with prop up plate, DN 900, max. operating pressure 17,0 bar
03600039	Plug, with prop up plate, DN 1000, max. operating pressure 16,0 bar
03600041	Plug, with prop up plate, DN 1100, max. operating pressure 13,0 bar
03600040	Plug, with prop up plate, DN 1200, max. operating pressure 10,0 bar
03600043	Plug, with prop up plate, DN 1300, max. operating pressure 9,0 bar
03600042	Plug, with prop up plate, DN 1400, max. operating pressure 8,0 bar
03600045	Plug, with prop up plate, DN 1500, max. operating pressure 7,0 bar
03600044	Plug, with prop up plate, DN 1600, max. operating pressure 6,0 bar
03600046	Plug, with prop up plate, DN 1700, max. operating pressure 5,0 bar
03600048	Plug, with prop up plate, DN 1800, max. operating pressure 3,5 bar
03600047	Plug, with prop up plate, DN 1900, max. operating pressure 3,0 bar
03600049	Plug, with prop up plate, DN 2000, max. operating pressure 3,0 bar
03600050	Plug, with prop up plate, DN 2200, max. operating pressure 2,0 bar

Replacement sealings for mechanical pipe plugs

- **Natural rubber (NR)**, this material is limited acid and alkali-resistant, but not resistant to oils, lubricants and fuels **Perbunan (NBR)**, this material is resistant to oils, lubricants and fuels, also it is resistant to normal aggressive acids and alkalis

Replacement rubber rings made of natural rubber

Order no.	Product
03450001	Repl. rubber ring, natural rubber, DN 80
03450002	Repl. rubber ring, natural rubber, DN 90
03450003	Repl. rubber ring, natural rubber, DN 100
03450004	Repl. rubber ring, natural rubber, DN 110
03450005	Repl. rubber ring, natural rubber, DN 125
03450006	Repl. rubber ring, natural rubber, DN 130
03450007	Repl. rubber ring, natural rubber, DN 140
03450008	Repl. rubber ring, natural rubber, DN 150
03450009	Repl. rubber ring, natural rubber, DN 160
03450009	Repl. rubber ring, natural rubber, DN 160
03450010	Repl. rubber ring, natural rubber, DN 175
03450011	Repl. rubber ring, natural rubber, DN 190
03450012	Repl. rubber ring, natural rubber, DN 200
03450013	Repl. rubber ring, natural rubber, DN 210
03450223	Repl. rubber ring, natural rubber, DN 225
03450014	Repl. rubber ring, natural rubber, DN 235
03450015	Repl. rubber ring, natural rubber, DN 250
03450016	Repl. rubber ring, natural rubber, DN 260
03450017	Repl. rubber ring, natural rubber, DN 275
03450018	Repl. rubber ring, natural rubber, DN 300
03450019	Repl. rubber ring, natural rubber, DN 310
03450020	Repl. rubber ring, natural rubber, DN 350
03450021	Repl. rubber ring, natural rubber, DN 400
03450022	Repl. rubber ring, natural rubber, DN 450
03450023	Repl. rubber ring, natural rubber, DN 500
03450767	Repl. rubber ring, natural rubber, DN 550
03450024	Repl. rubber ring, natural rubber, DN 600

Replacement rubber rings made of Perbunan

Order no.	Product
03450025	Repl. rubber ring, Perbunan, DN 80
03450026	Repl. rubber ring, Perbunan, DN 90
03450027	Repl. rubber ring, Perbunan, DN 100
03450028	Repl. rubber ring, Perbunan, DN 110
03450029	Repl. rubber ring, Perbunan, DN 125
03450030	Repl. rubber ring, Perbunan, DN 130
03450031	Repl. rubber ring, Perbunan, DN 140
03450032	Repl. rubber ring, Perbunan, DN 150
03450033	Repl. rubber ring, Perbunan, DN 160
03450034	Repl. rubber ring, Perbunan, DN 175
03450035	Repl. rubber ring, Perbunan, DN 190
03450036	Repl. rubber ring, Perbunan, DN 200
03450037	Repl. rubber ring, Perbunan, DN 210
03450919	Repl. rubber ring, Perbunan, DN 225
03450038	Repl. rubber ring, Perbunan, DN 235
03450039	Repl. rubber ring, Perbunan, DN 250
03450040	Repl. rubber ring, Perbunan, DN 260
03450041	Repl. rubber ring, Perbunan, DN 275
03450042	Repl. rubber ring, Perbunan, DN 300
03450043	Repl. rubber ring, Perbunan, DN 310
03450044	Repl. rubber ring, Perbunan, DN 350
03450045	Repl. rubber ring, Perbunan, DN 400
03450046	Repl. rubber ring, Perbunan, DN 450
03450047	Repl. rubber ring, Perbunan, DN 500
03450048	Repl. rubber ring, Perbunan, DN 600

Replacement rubber ring for plug type 360

Order no.	Product
03600081	Repl. rubber ring for plug type 360, DN 12
03600082	Repl. rubber ring for plug type 360, DN 14
03600376	Repl. rubber ring for plug type 360, DN 16
03600051	Repl. rubber ring for plug type 360, DN 20
03600052	Repl. rubber ring for plug type 360, DN 25
03600053	Repl. rubber ring for plug type 360, DN 30
03600054	Repl. rubber ring for plug type 360, DN 35
03600055	Repl. rubber ring for plug type 360, DN 40
03600056	Repl. rubber ring for plug type 360, DN 50
03600057	Repl. rubber ring for plug type 360, DN 60
03600058	Repl. rubber ring for plug type 360, DN 65
03600059	Repl. rubber ring for plug type 360, DN 70
03600316	Repl. rubber ring for plug type 360, DN 75
03600196	Repl. rubber ring for plug type 360, DN 80
03600201	Repl. rubber ring for plug type 360, DN 90
03600205	Repl. rubber ring for plug type 360, DN 100
03600208	Repl. rubber ring for plug type 360, DN 110
03600216	Repl. rubber ring for plug type 360, DN 125
03600225	Repl. rubber ring for plug type 360, DN 140
03600228	Repl. rubber ring for plug type 360, DN 150
03600231	Repl. rubber ring for plug type 360, DN 160
03600234	Repl. rubber ring for plug type 360, DN 175
03600241	Repl. rubber ring for plug type 360, DN 190
03600249	Repl. rubber ring for plug type 360, DN 200
03600252	Repl. rubber ring for plug type 360, DN 210
03600255	Repl. rubber ring for plug type 360, DN 225
03600258	Repl. rubber ring for plug type 360, DN 250
03600261	Repl. rubber ring for plug type 360, DN 260
03600264	Repl. rubber ring for plug type 360, DN 275
03600267	Repl. rubber ring for plug type 360, DN 300
03600270	Repl. rubber ring for plug type 360, DN 310
03600274	Repl. rubber ring for plug type 360, DN 350
03600074	Repl. rubber ring for plug type 360, DN 375
03600279	Repl. rubber ring for plug type 360, DN 400
03600283	Repl. rubber ring for plug type 360, DN 450
03600286	Repl. rubber ring for plug type 360, DN 500
03600077	Repl. rubber ring for plug type 360, DN 600
03600392	Repl. rubber ring for plug type 360, DN 700
03600322	Repl. rubber ring for plug type 360, DN 750
03600079	Repl. rubber ring for plug type 360, DN 800

Pipe plugs - pneumatical

Pneumatic pipe plugs up to 0,5 bar

We offer the pneumatic pipe plugs also in the form of an egg profile, as well as custom-made according to customer requirements.



One-piece

- Passage with ball valve
- Two sealings
- Max. operation pressure 0,5 bar

Order no.	Product
03000200	Pneumatic plug with 2 sealings, 1 part, DN 300
03000201	Pneumatic plug with 2 sealings, 1 part, DN 310
03000202	Pneumatic plug with 2 sealings, 1 part, DN 350
03000203	Pneumatic plug with 2 sealings, 1 part, DN 400
03000204	Pneumatic plug with 2 sealings, 1 part, DN 450
03000205	Pneumatic plug with 2 sealings, 1 part, DN 500
03000206	Pneumatic plug with 2 sealings, 1 part, DN 550
03000207	Pneumatic plug with 2 sealings, 1 part, DN 600
03000208	Pneumatic plug with 2 sealings, 1 part, DN 650
03000209	Pneumatic plug with 2 sealings, 1 part, DN 700
03000210	Pneumatic plug with 2 sealings, 1 part, DN 800
03000211	Pneumatic plug with 2 sealings, 1 part, DN 900
03000212	Pneumatic plug with 2 sealings, 1 part, DN 1000
03000213	Pneumatic plug with 2 sealings, 1 part, DN 1100
03000214	Pneumatic plug with 2 sealings, 1 part, DN 1200
03000215	Pneumatic plug with 2 sealings, 1 part, DN 1300
03000216	Pneumatic plug with 2 sealings, 1 part, DN 1400
03000217	Pneumatic plug with 2 sealings, 1 part, DN 1500
03000218	Pneumatic plug with 2 sealings, 1 part, DN 1600
03000219	Pneumatic plug with 2 sealings, 1 part, DN 1700
03000220	Pneumatic plug with 2 sealings, 1 part, DN 1800
03000230	Pneumatic plug with 2 sealings, 1 part, DN 1900
03000221	Pneumatic plug with 2 sealings, 1 part, DN 2000
03000231	Pneumatic plug with 2 sealings, 1 part, DN 2100
03000222	Pneumatic plug with 2 sealings, 1 part, DN 2200
03000232	Pneumatic plug with 2 sealings, 1 part, DN 2300
03000223	Pneumatic plug with 2 sealings, 1 part, DN 2400
03000224	Pneumatic plug with 2 sealings, 1 part, DN 2500
03000225	Pneumatic plug with 2 sealings, 1 part, DN 2600
03000226	Pneumatic plug with 2 sealings, 1 part, DN 2700
03000227	Pneumatic plug with 2 sealings, 1 part, DN 2800
03000228	Pneumatic plug with 2 sealings, 1 part, DN 2900
03000229	Pneumatic plug with 2 sealings, 1 part, DN 3000



Two-pieces

- Passage with ball valve
- Two sealings
- Max. operation pressure 0,5 bar

Order no.	Product
03000233	Pneumatic plug with 2 sealings, 2 parts, DN 650
03000234	Pneumatic plug with 2 sealings, 2 parts, DN 700
03000235	Pneumatic plug with 2 sealings, 2 parts, DN 800
03000236	Pneumatic plug with 2 sealings, 2 parts, DN 900
03000237	Pneumatic plug with 2 sealings, 2 parts, DN 1000
03000238	Pneumatic plug with 2 sealings, 2 parts, DN 1100
03000239	Pneumatic plug with 2 sealings, 2 parts, DN 1200

Three-pieces

- Passage with ball valve
- Two sealings
- Max. operation pressure 0,5 bar

Order no.	Product
03000259	Pneumatic plug with 2 sealings, 3 parts, DN 1300
03000260	Pneumatic plug with 2 sealings, 3 parts, DN 1400
03000261	Pneumatic plug with 2 sealings, 3 parts, DN 1500
03000262	Pneumatic plug with 2 sealings, 3 parts, DN 1600
03000263	Pneumatic plug with 2 sealings, 3 parts, DN 1700
03000264	Pneumatic plug with 2 sealings, 3 parts, DN 1800

Four-pieces

- Passage with ball valve
- Two sealings
- Max. operation pressure 0,5 bar

Order no.	Product
03000277	Pneumatic plug with 2 sealings, 4 parts, DN 1900
03000278	Pneumatic plug with 2 sealings, 4 parts, DN 2000
03000279	Pneumatic plug with 2 sealings, 4 parts, DN 2100
03000280	Pneumatic plug with 2 sealings, 4 parts, DN 2200
03000281	Pneumatic plug with 2 sealings, 4 parts, DN 2300
03000282	Pneumatic plug with 2 sealings, 4 parts, DN 2400

Five-pieces

- Passage with ball valve
- Two sealings
- Max. operation pressure 0,5 bar

Order no.	Product
03000289	Pneumatic plug with 2 sealings, 5 parts, DN 2500
03000290	Pneumatic plug with 2 sealings, 5 parts, DN 2600
03000291	Pneumatic plug with 2 sealings, 5 parts, DN 2700
03000292	Pneumatic plug with 2 sealings, 5 parts, DN 2800
03000293	Pneumatic plug with 2 sealings, 5 parts, DN 2900
03000294	Pneumatic plug with 2 sealings, 5 parts, DN 3000

Accessories for pneumatic pipe plugs

Extra charge list

Order no.	Product
03000344	Extra charge for equipment as fill-/test element, DN 200 - DN 400
03000345	Extra charge for equipment as fill-/test element, DN 400 - DN 1900
03000346	Extra charge for equipment as fill-/test element, DN 2000 - DN 3000
03000347	Extra charge for equipment as venting element, DN 200 - DN 400
03000348	Extra charge for equipment as venting element, DN 400 - DN 1900
03000349	Extra charge for equipment as venting element, DN 2000 - DN 3000

Pipe plug configurator

DN: _____

ø pipe inside: _____

back pressure: _____

	without Passage / Bypass
	with Passage / Bypass

execution:

	ball valve
	gauges
	couplings type 26
	Geka couplings
	Compressor couplings

DN: _____

ø pipe inside: _____

back pressure: _____

	without Passage / Bypass
	with Passage / Bypass

execution:

	Kugelhahn
	gauges
	couplings type 26
	Geka couplings
	Compressor couplings

Your contact details

company: _____

street address: _____

ZIP/city: _____

contact person: _____

phone/fax: _____

e-mail: _____

Please reply this form by fax +49 (0) 6232. 3189-20 or by e-mail **vertrieb@subgas.de**

date _____ signature _____

You can download our **current price list** on **www.subgas.de**

Accessories

Repair patches



Our special repair patches with "Iso Keram"-sealingplate on the inner side are used for welding on all steel pipes, when leaks at pipes are discovered and have to be repaired.

To fix the repair patch on the pipe, we recommend our patch-tensioner with potential equalization which fits to all patch sizes.



Versions

Order no.	Product
50000001	Repair patch, DN 50 / 60,3 mm
50000003	Repair patch, DN 60 / 76,1 mm
50000005	Repair patch, DN 80 / 88,9 mm
50000007	Repair patch, DN 100 / 108,0 mm
50000009	Repair patch, DN 100 / 114,3 mm
50000070	Repair patch, DN 125 / 139,7 mm
50000011	Repair patch, DN 150 / 159,0 mm
50000013	Repair patch, DN 150 / 168,3 mm
50000016	Repair patch, DN 200 / 219,1 mm
50000018	Repair patch, DN 250 / 273,0 mm
50000020	Repair patch, DN 300 / 323,9 mm
50000022	Repair patch, DN 300 / 355,6 mm

Delivery

The repair patches come with a one-sided thermal-fabric coating.

Accessories for repair patches



Fixture for repair patches

The fixture presses the repair patch on the pipe and fixes it for welding.

The fixture has a potential equalization and fits to all sizes of patches from DN 50 to DN 300, caused by the free adjustable tensioning chain and the large travel of the spindle.

Order no.	Product
50000044	Fixture for repair patch with potential equalization

Jumper cable

Before you divide or connect a gas pipe made of metal, mount or dismount pipe parts, armatures, gas meters or gas pressure regulators in order to connect all electrical conductive parts with an jumper cable to secure that no flammable gas can ignite by dangerous contact voltages and electrical flashovers.

Our jumper cables are made of isolated flexible stranded copper wires with a profile sizes of 25 mm².

The contact resistance must be kept as low as possible at the contact points between the bridging device and e. g. the gas pipe line.



for blank contact points

Order no.	Product
00700001	Jumper cable, 2,50 m, ø 13,5 - 89 mm
00700002	Jumper cable, 2,50 m, ø 89 - 219 mm
00700003	Jumper cable, 2,50 m, ø 219 - 324 mm
00700004	Jumper cable, 5,00 m, ø 13,5 - 89 mm
00700005	Jumper cable, 5,00 m, ø 89 - 219 mm
00700006	Jumper cable, 5,00 m, ø 219 - 324 mm
00700007	Jumper cable, 10,00 m, ø 13,5 - 89 mm
00700008	Jumper cable, 10,00 m, ø 89 - 219 mm
00700009	Jumper cable, 10,00 m, ø 219 - 324 mm



for insulated contact points

Order no.	Product
00710003	Jumper cable, 2,50 m, ø 60 - 400 mm
00710013	Jumper cable, 2,50 m, ø 60 - 250 mm
00710014	Jumper cable, 2,50 m, ø 60 - 300 mm
00710004	Jumper cable, 5,00 m, ø 60 - 250 mm
00710005	Jumper cable, 5,00 m, ø 60 - 300 mm
00710006	Jumper cable, 5,00 m, ø 60 - 400 mm
00710007	Jumper cable, 10,00 m, ø 60 - 300 mm
00710008	Jumper cable, 10,00 m, ø 60 - 400 mm
00710017	Jumper cable, 15,00 m, ø 60 - 300 mm
00710018	Jumper cable, 15,00 m, ø 60 - 400 mm
00710019	Jumper cable, 15,00 m, ø 60 - 600 mm

Pipe joint tester

Pipe joint tester are used to check the leakage of pipes and channels and further all interfaces of pipe systems. The testing of entire sections or complete systems needs a high quantity of materials and manpower. To reduce the effort it is useful to check each interface itself. This saves time as you don't need huge shut-off units and you don't have to fill large testing areas. Furthermore, you get an exact and immediate result about the leakage on every interface.

The company "Städtler+Beck" manufactures such joint testing devices and has experience in designing and planning of these equipment and its application for over 40 years. Our product range covers standardly **all common materials and forms** and further, we can customize a suitable device for your individual purpose.

On request, we accompany your entire project, add consulting expertise and/or supervise the construction site.

We are constantly developing our equipment and can offer you the following:

Different devices:

- **Multi-size - joint tester** for testing of different pipe dimensions or for ecor
- Joint tester **for use in non-accessible and accessible sewers**
- **High-pressure versions** for pressure **up to 15 bar**
- **Customized devices**, we manufacture your joint tester according to your profiles, with or without dry weather flow channel

Our devices can compensate a certain sleeve offset and manufacturing tolerances. The lift of the pneumatic hollow section profiles make this possible. Please note, this lift is limited and depends on the device. The maximal lift is measured from the minimal manufacturing size and parallel to the circumference

- MPG MINI 20 mm
- MPG MAXI 20 mm
- MPG Powerline 10 mm
- MUPP UNO/DUO 35 mm
- KOMUP UNO/DUO 35 mm



Further advantages and particularities are:

- Optional **testing with air or water**
- **The use of mobile camera systems** for visual inspection and documentation
- **exactly positioning** by the view to the testing area
- **Compatibility** to all crawler system
- Integrated **self-monitoring** (MUPP/KOMUP DUO series) by extra reference test areas
- Collapsible constructions for **easy handling and transport**
- Uninterrupted hollow section profiles for absolute tightness and function of the devices in the KOMUP series
- Compatible measuring technique of one's own house
- **Rental** of different devices on request



Customized joint tester

We manufacture your pipe joint tester according to your draft, for example circle-, egg-, deltoid-, box-shaped-profiles, with or without dry weather flow channel.

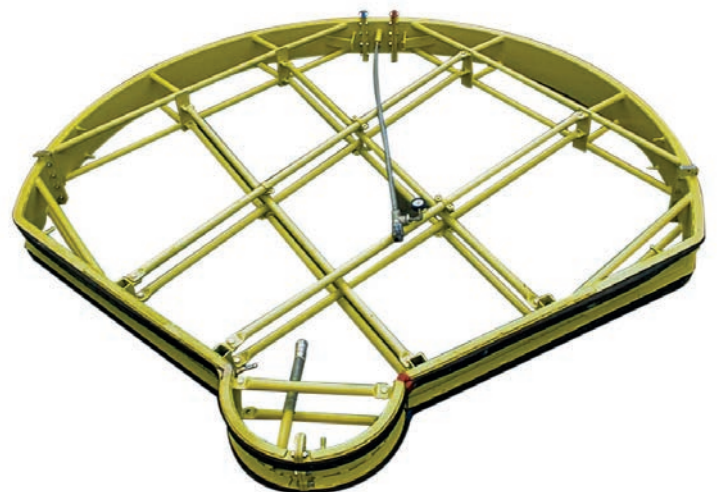

MPG - Pipe joint tester

Pipe joint tester MINI

The pneumatic joint tester MINI is used for tightness-tests of pipe connections with smaller diameters from **DN 200 to DN 600 with air or water according to EN 1610 and other testing standards.**

The device is made of a welded steel construction with two hollow section rubber profiles/sealings (**fill pressure up to 6 bar**) and a wide testing chamber. Para-special-rubber sleeves are used additionally for better tightness. The head plates are demountable for an **easier change of the hollow section rubber profiles.**

Our devices can compensate a certain sleeve offset and manufacturing tolerances. The lift of the pneumatic hollow section profiles make this possible. Please note, this lift is limited and depends on the device. The devices of the MPG MINI series can lift 20 mm, measured from the minimal manufacturing size and parallel to the circumference.

Delivery

- One joint tester with two hollow section rubber profiles
- Delivered with quick-release couplings type 26 for filling
- One fixedly mounted undercarriage with six wheels

Additionally orderable are various adapters, connecting hoses, pumps and gauges. You can upgrade your device and adapt it to your requirements on our extensive range of accessories. We will advise you on the selection and will support you to get the best solution for your job.

Pipe joint tester MAXI

The pneumatic joint tester MAXI is used for tightness-tests of pipe connections with larger diameters from **DN 600 to DN 3400 with air or water according to EN 1610 and other testing standards.**

The device is made of a welded steel construction with two hollow section rubber profiles/sealings (**fill pressure up to 6 bar**) and a wide testing chamber. The devices are made in multiple parts for an easier transport or assembling on the construction site.

The joint tester are available in circle or egg-shape, but **custom-profiles like deltoid or box profiles are also available** on request. Gladly we advise you on your project and provide you with our experience and our products.

Our devices can compensate a certain sleeve offset and manufacturing tolerances. The lift of the pneumatic sealings make this possible. Please note, this lift is limited and depends on the device. The devices of the MPG MAXI series can lift 20 mm, measured from the minimal manufacturing size and parallel to the circumference.



Delivery

- One joint tester with two hollow section rubber profiles
- GEKA-coupling for filling of the testing area
- Quick-release coupling type 26 for filling of the hollow section rubber profiles
- One mountable undercarriage with four wheels

Additionally orderable are various adapters, connecting hoses, pumps and gauges. You can upgrade your device and adapt it to your requirements on our extensive range of accessories. We will advise you on the selection and will support you to get the best solution for your job.



MPG MAXI - one part

Order no.	Product
09300025	MPG MAXI, pneumatic, 1 part, DN 600
09300001	MPG MAXI, pneumatic, 1 part, DN 700
09300002	MPG MAXI, pneumatic, 1 part, DN 800
09300003	MPG MAXI, pneumatic, 1 part, DN 900
09300004	MPG MAXI, pneumatic, 1 part, DN 1000
09300005	MPG MAXI, pneumatic, 1 part, DN 1100
09300006	MPG MAXI, pneumatic, 1 part, DN 1200
09300007	MPG MAXI, pneumatic, 1 part, DN 1300
09300008	MPG MAXI, pneumatic, 1 part, DN 1400
09300009	MPG MAXI, pneumatic, 1 part, DN 1500
09300010	MPG MAXI, pneumatic, 1 part, DN 1600
09300011	MPG MAXI, pneumatic, 1 part, DN 1700
09300012	MPG MAXI, pneumatic, 1 part, DN 1800
09300013	MPG MAXI, pneumatic, 1 part, DN 1900
09300014	MPG MAXI, pneumatic, 1 part, DN 2000
09300015	MPG MAXI, pneumatic, 1 part, DN 2100
09300016	MPG MAXI, pneumatic, 1 part, DN 2200
09300017	MPG MAXI, pneumatic, 1 part, DN 2300
09300018	MPG MAXI, pneumatic, 1 part, DN 2400
09300019	MPG MAXI, pneumatic, 1 part, DN 2500
09300020	MPG MAXI, pneumatic, 1 part, DN 2600
09300021	MPG MAXI, pneumatic, 1 part, DN 2800
09300022	MPG MAXI, pneumatic, 1 part, DN 3000
09300023	MPG MAXI, pneumatic, 1 part, DN 3200
09300024	MPG MAXI, pneumatic, 1 part, DN 3400

Surcharge pipe joint tester multipart

Order no.	Product
09300584	Surcharge for partition into 3 parts in connection with art. 930 or 935
09300585	Surcharge for each additional partition in connection with art. 09300584

Replacement Sealings made of natural rubber



- from DN 200 to DN 3400 with vulcanized Schrader valve

Order no.	Product
03450292	Repl. sealing, natural rubber with Schrader valve, DN 250
03450297	Repl. sealing, natural rubber with Schrader valve, DN 300
03450302	Repl. sealing, natural rubber with Schrader valve, DN 350
03450306	Repl. sealing, natural rubber with Schrader valve, DN 400
03450310	Repl. sealing, natural rubber with Schrader valve, DN 450
03450314	Repl. sealing, natural rubber with Schrader valve, DN 500
03450318	Repl. sealing, natural rubber with Schrader valve, DN 550
03450322	Repl. sealing, natural rubber with Schrader valve, DN 600
03450326	Repl. sealing, natural rubber with Schrader valve, DN 650
03450330	Repl. sealing, natural rubber with Schrader valve, DN 700
03450342	Repl. sealing, natural rubber with Schrader valve, DN 750
03450346	Repl. sealing, natural rubber with Schrader valve, DN 800
03450350	Repl. sealing, natural rubber with Schrader valve, DN 900
03450354	Repl. sealing, natural rubber with Schrader valve, DN 1000
03450358	Repl. sealing, natural rubber with Schrader valve, DN 1100
03450362	Repl. sealing, natural rubber with Schrader valve, DN 1200
03450366	Repl. sealing, natural rubber with Schrader valve, DN 1300
03450371	Repl. sealing, natural rubber with Schrader valve, DN 1400
03450375	Repl. sealing, natural rubber with Schrader valve, DN 1500
03450379	Repl. sealing, natural rubber with Schrader valve, DN 1600
03450384	Repl. sealing, natural rubber with Schrader valve, DN 1700
03450383	Repl. sealing, natural rubber with Schrader valve, DN 1800
0345654	Repl. sealing, natural rubber with Schrader valve, DN 1900
03450388	Repl. sealing, natural rubber with Schrader valve, DN 2000
0345655	Repl. sealing, natural rubber with Schrader valve, DN 2100
03450392	Repl. sealing, natural rubber with Schrader valve, DN 2200
0345656	Repl. sealing, natural rubber with Schrader valve, DN 2300
03450396	Repl. sealing, natural rubber with Schrader valve, DN 2400
0345657	Repl. sealing, natural rubber with Schrader valve, DN 2500
0345658	Repl. sealing, natural rubber with Schrader valve, DN 2600
0345659	Repl. sealing, natural rubber with Schrader valve, DN 2800
0345660	Repl. sealing, natural rubber with Schrader valve, DN 3000
0345661	Repl. sealing, natural rubber with Schrader valve, DN 3200
0345662	Repl. sealing, natural rubber with Schrader valve, DN 3400

KOMUP - Compact pipe joint tester

The pneumatic joint tester of the KOMUP series are used for tightness-tests of pipe connections with diameters from **DN 600 to DN 2600** **with air or water according to EN 1610** and many other standards.

The special feature of this device is the small transport volume. Due to a folding mechanism these device is **space-saving** collapsible and **fit through every DIN-manhole from DN 625**.

Furthermore, every KOMUP device can on request delivered with a **self-monitoring feature**. This series is called KOMUP DUO and consists of two extra hollow section profiles/sealings. These profiles generate additional testing areas which generate the possibility to check the device tightness at the pipe. This guaranties **100% reliable test results**.

Besides our devices consist of further advantages, for example:

- Suitable for every **pipe material**
- Suitable for every type of test
- **100 % tightness due to a closed rubber profile**, the one parted profile covers the whole surface of the joint tester and reliably seals up the complete device
- **Easy and quick device assembling** into the pipe
- Better handling and reduced shipping costs because of **minimized weight**
- **Sleeve offset can be crossed**

Our devices can compensate a certain sleeve offset and manufacturing tolerances. The lift of the pneumatic hollow section profiles makes this possible. Please note, this lift is limited and depends on the device. The devices of the KOMUP UNO/DUO series can lift 35 mm, measured from the minimal manufacturing size and parallel to the circumference.



Delivery

- Default delivered with quick-release couplings type 26 for filling of the hollow section rubber profiles
- Double or quadruple hollow section rubber profiles
- One mountable undercarriage with four wheels, variable adjustable



Versions

Order no.	Product
09310133	KOMUP, 1 part, DN 600
09310043	KOMUP, 1 part, DN 700
09310044	KOMUP, 1 part, DN 800
09310045	KOMUP, 1 part, DN 900
09310046	KOMUP, 1 part, DN 1000
09310047	KOMUP, 1 part, DN 1100
09310048	KOMUP, 2 parts, DN 1200
09310049	KOMUP, 2 parts, DN 1300
09310050	KOMUP, 2 parts, DN 1400
09310051	KOMUP, 2 parts, DN 1500
09310052	KOMUP, 2 parts, DN 1600
09310053	KOMUP, 2 parts, DN 1700
09310054	KOMUP, 2 parts, DN 1800
09310055	KOMUP, 2 parts, DN 1900
09310056	KOMUP, 2 parts, DN 2000
09310057	KOMUP, 2 parts, DN 2100
09310058	KOMUP, 2 parts, DN 2200
09310059	KOMUP, 2 parts, DN 2300
09310060	KOMUP, 2 parts, DN 2400
09310061	KOMUP, 2 parts, DN 2500
09310062	KOMUP, 2 parts, DN 2600

Spareparts

Replacement Sealings made of natural rubber for KOMUP

Default delivered with vulcanized Schrader valve.

Order no.	Product
09310001	Repl. sealing for KOMUP, DN 600
09310003	Repl. sealing for KOMUP, DN 700
09310005	Repl. sealing for KOMUP, DN 800
09310007	Repl. sealing for KOMUP, DN 900
09310009	Repl. sealing for KOMUP, DN 1000
09310011	Repl. sealing for KOMUP, DN 1100
09310013	Repl. sealing for KOMUP, DN 1200
09310015	Repl. sealing for KOMUP, DN 1300
09310017	Repl. sealing for KOMUP, DN 1400
09310019	Repl. sealing for KOMUP, DN 1500
09310021	Repl. sealing for KOMUP, DN 1600
09310023	Repl. sealing for KOMUP, DN 1700
09310025	Repl. sealing for KOMUP, DN 1800
09310027	Repl. sealing for KOMUP, DN 1900
09310029	Repl. sealing for KOMUP, DN 2000
09310031	Repl. sealing for KOMUP, DN 2100
09310033	Repl. sealing for KOMUP, DN 2200
09310035	Repl. sealing for KOMUP, DN 2300
09310037	Repl. sealing for KOMUP, DN 2400
09310039	Repl. sealing for KOMUP, DN 2500
09310041	Repl. sealing for KOMUP, DN 2600

Joint tester Powerline

The pneumatic joint tester of the Powerline series are used for tightness-tests with water of pipe connections with larger diameters from **DN 600 to DN 3400**. You can do tests with this very stable devices **up to a pressure of 15 bar**.

The device is made of an **especially stable welded steel construction** with two hollow section rubber profiles/sealings (**fill pressure up to 6 bar**) and a wide testing chamber. The devices can be constructed in multiple parts for an easier transport or assembling at the construction site.

Joint tester are available in circle or egg-shape, but **custom-profiles like deltoid or box profiles are also available** on request. Gladly we advise you on your project and provide you with our experience and our products.

Our devices can compensate a certain sleeve offset and manufacturing tolerances. The lift of the pneumatic sealing rings make this possible. Please note, this lift is limited and depends on the device. The devices of the MPG Powerline series can lift 10 mm, measured from the minimal manufacturing size and parallel to the circumference.



Delivery

- One joint tester with two hollow section rubber profiles
- Delivered with a GEKA-coupling for filling of the testing area
- Quick-release coupling type 26 for filling of the hollow section rubber profiles
- One mountable undercarriage with four wheels

Additionally orderable are various adapters, connecting hoses, pumps and gauges. You can upgrade your device and adapt it to your requirements on our extensive range of accessories. We will advise you on the selection and will support you to get the best solution for your job.

MPG Powerline - one part

Order no.	Product
09350001	MPG Powerline, pneumatic, 1 part, DN 700
09350002	MPG Powerline, pneumatic, 1 part, DN 800
09350003	MPG Powerline, pneumatic, 1 part, DN 900
09350004	MPG Powerline, pneumatic, 1 part, DN 1000
09350005	MPG Powerline, pneumatic, 1 part, DN 1100
09350006	MPG Powerline, pneumatic, 1 part, DN 1200
09350007	MPG Powerline, pneumatic, 1 part, DN 1300
09350008	MPG Powerline, pneumatic, 1 part, DN 1400
09350009	MPG Powerline, pneumatic, 1 part, DN 1500
09350010	MPG Powerline, pneumatic, 1 part, DN 1600
09350011	MPG Powerline, pneumatic, 1 part, DN 1700
09350012	MPG Powerline, pneumatic, 1 part, DN 1800
09350013	MPG Powerline, pneumatic, 1 part, DN 1900
09350014	MPG Powerline, pneumatic, 1 part, DN 2000
09350015	MPG Powerline, pneumatic, 1 part, DN 2100
09350016	MPG Powerline, pneumatic, 1 part, DN 2200

Surcharge pipe joint tester multipart

Order no.	Product
09300584	Surcharge for partition into 3 parts in connection with art. 930 or 935
09300585	Surcharge for each additional partition in connection with art. 09300584

MUPP UNO/DUO - Pipe joint tester with integrated Plexiglas-test chamber

The pneumatic pipe joint tester of the MUPP series are used for tightness-tests of pipe connections with diameters from **DN 200 to DN 600 with air or optional water according to EN 1610**. All MUPP UNO/DUO test devices are equipped with a **robot attachment** to put them into non-accessible sewer or other channels.

Default delivery is the transparent test chamber which can be equipped with a camera. Because of this you can exactly position the device and can record the test area.

Furthermore, every MUPP device can on request be delivered with a **self-monitoring feature**. This series is called MUPP DUO and consists of two extra hollow section profiles/sealings. These profiles generate additional testing areas which generate the possibility to check the device tightness at the pipe. This guarantees **100% reliable test results**.

Our devices can compensate a certain sleeve offset and manufacturing tolerances. The lift of the pneumatic hollow section profiles make this possible. Please note, this lift is limited and depends on the device. The devices of the MUPP UNO/DUO series can lift 35 mm, measured from the minimal manufacturing size and parallel to the circumference.



First self-monitored pipe joint tester

Delivery

- Delivered with quick-release coupling type 26
- Two or four hollow section profiles
- Integrated undercarriage with two wheels
- Robot attachment
- One camera mount

Additionally orderable are various adapters, connecting hoses, pumps and gauges. You can upgrade your device and adapt it to your requirements on our extensive range of accessories. We will advise you on the selection and will support you to get the best solution for your job.

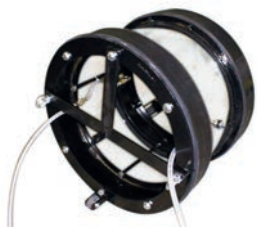

MUPP UNO

Order no.	Product
09300095	MUPP UNO, pneumatic, 1 part, DN 200
09300096	MUPP UNO, pneumatic, 1 part, DN 250
09300097	MUPP UNO, pneumatic, 1 part, DN 300
09300098	MUPP UNO, pneumatic, 1 part, DN 350
09300099	MUPP UNO, pneumatic, 1 part, DN 400
09300100	MUPP UNO, pneumatic, 1 part, DN 450
09300101	MUPP UNO, pneumatic, 1 part, DN 500
09300102	MUPP UNO, pneumatic, 1 part, DN 550
09300103	MUPP UNO, pneumatic, 1 part, DN 600



MUPP DUO

Order no.	Product
09300104	MUPP DUO, pneumatic, 1 part, DN 200
09300105	MUPP DUO, pneumatic, 1 part, DN 250
09300106	MUPP DUO, pneumatic, 1 part, DN 300
09300107	MUPP DUO, pneumatic, 1 part, DN 350
09300108	MUPP DUO, pneumatic, 1 part, DN 400
09300109	MUPP DUO, pneumatic, 1 part, DN 450
09300110	MUPP DUO, pneumatic, 1 part, DN 500
09300111	MUPP DUO, pneumatic, 1 part, DN 550
09300112	MUPP DUO, pneumatic, 1 part, DN 600

Spareparts

Replacement sealings for MUPP UNO

default delivery with Schrader valve

Order no.	Product
09300113	Repl. sealing for MUPP UNO, natural rubber with Schrader valve, DN 200
09300114	Repl. sealing for MUPP UNO, natural rubber with Schrader valve, DN 250
09300115	Repl. sealing for MUPP UNO, natural rubber with Schrader valve, DN 300
09300116	Repl. sealing for MUPP UNO, natural rubber with Schrader valve, DN 350
09300117	Repl. sealing for MUPP UNO, natural rubber with Schrader valve, DN 400
09300120	Repl. sealing for MUPP UNO, natural rubber with Schrader valve, DN 450
09300118	Repl. sealing for MUPP UNO, natural rubber with Schrader valve, DN 500
09300121	Repl. sealing for MUPP UNO, natural rubber with Schrader valve, DN 550
09300119	Repl. sealing for MUPP UNO, natural rubber with Schrader valve, DN 600

Replacement sealings for MUPP DUO

default delivery with Schrader valve

Order no.	Product
09300122	Repl. sealing for MUPP DUO, natural rubber with Schrader valve, DN 200
09300123	Repl. sealing for MUPP DUO, natural rubber with Schrader valve, DN 250
09300124	Repl. sealing for MUPP DUO, natural rubber with Schrader valve, DN 300
09300125	Repl. sealing for MUPP DUO, natural rubber with Schrader valve, DN 350
09300126	Repl. sealing for MUPP DUO, natural rubber with Schrader valve, DN 400
09300127	Repl. sealing for MUPP DUO, natural rubber with Schrader valve, DN 450
09300128	Repl. sealing for MUPP DUO, natural rubber with Schrader valve, DN 500
09300130	Repl. sealing for MUPP DUO, natural rubber with Schrader valve, DN 550
09300129	Repl. sealing for MUPP DUO, natural rubber with Schrader valve, DN 600

Plexiglasrohr MUPP

gebohrt mit U-Dichtung

Order no.	Product
09300368	Plexiglasrohr, DN 200, Ø150 x Ø140 x 180 mm, gebohrt mit U-Dichtung
09300226	Plexiglasrohr, DN 250, Ø185 x Ø175 x 180 mm, gebohrt mit U-Dichtung
09300370	Plexiglasrohr, DN 300/350, Ø200 x Ø190 x 200 mm, gebohrt mit U-Dichtung
09300371	Plexiglasrohr, DN 400/450 Ø300 x Ø290 x 200 mm, gebohrt mit U-Dichtung
09300222	Plexiglasrohr, DN 500/550, Ø400 x Ø390 x 200 mm, gebohrt mit U-Dichtung
09300209	Plexiglasrohr, DN 600, Ø500 x Ø490 x 200 mm, gebohrt mit U-Dichtung

Multi-size pipe joint tester with integrated Plexiglas-test chamber



One device for several diameter

The pneumatic joint tester of the MB series are used for tightness-tests of pipe connections with diameters from **DN 100 to DN 800 with air or water according to EN 1610** and many other standards. The used hollow section profiles/sealings can be pressurized **up to 2,5 bar**. All multi-size joint tester can be equipped with a **robot attachment** to put them into non-accessible sewer or other channels.

The special feature of this tester is to cover several nominal diameter with only one device. The multi-size pipe joint tester have hollow section profiles/sealings which can implement a large lift. So it is possible to cover a range of diameter of 200 mm (depending on the reference diameter) with one device.

Default delivery is the transparent test chamber which can equipped with a camera. Because of this you can exactly position the device and can record the test area.

Delivery

- Two or four hollow section profiles/sealings
- Integrated undercarriage with two wheels
- Robot attachment
- One camera mount



Versions

Order no.	Product
09340005	MB - Multi-size joint tester, DN 100 - 160
09340001	MB - Multi-size joint tester, DN 150 - 200
09340002	MB - Multi-size joint tester, DN 160 - 230
09340003	MB - Multi-size joint tester, DN 250 - 300
09340004	MB - Multi-size joint tester, DN 300 - 400
09340008	MB - Multi-size joint tester, DN 400 - 500
09340006	MB - Multi-size joint tester, DN 500 - 600
09340007	MB - Multi-size joint tester, DN 600 - 800

Spareparts

Plexiglas

drilled with u-shaped sealing

Order no.	Product
09340134	Repl. Plexiglas for MB - multi-size joint tester, DN 145 - 230
09340098	Repl. Plexiglas for MB - multi-size joint tester, DN 160 - 230 / DN 200 - 250
09340160	Repl. Plexiglas for MB - multi-size joint tester, DN 250 - 300
90000001	Repl. Plexiglas for MB - multi-size joint tester, DN 300 - 400
09340070	Repl. Plexiglas for MB - multi-size joint tester, DN 400 - 500
09340168	Repl. Plexiglas for MB - multi-size joint tester, DN 500 - 600
09340082	Repl. Plexiglas for MB - multi-size joint tester, DN 600 - 800

Replacement sealings

Order no.	Product
09340185	Repl. sealing for MB - multi-size joint tester, DN 200 - 250
09340018	Repl. sealing for MB - multi-size joint tester, DN 300 - 400
09340181	Repl. sealing for MB - multi-size joint tester, DN 400 - 500
09340119	Repl. sealing for MB - multi-size joint tester, DN 500 - 600
09340121	Repl. sealing for MB - multi-size joint tester, DN 600 - 1000
09340120	Repl. sealing for MB - multi-size joint tester, DN 600 - 800

Customized joint tester

We manufacture your pipe joint tester according to your draft, for example circle-, egg-, deltoid-, box-shaped- profile, with or without dry weather flow channel.



Manhole-pipe joint tester

This pneumatic plug has been specially modified for leakage tests of manholes with a nominal diameter of DN 625. It seals up through the with air pressurized hollow section profiles/sealings (**up to 6 bar**). This plugs can be ordered with one or two sealings.

The vertical positioning is realized over a central mounted spindle which can be set **exactly and variable**.



Versions

Order no.	Product
09360002	Manhole joint tester with 1 sealing, DN 625
09360001	Manhole joint tester with 2 sealings, DN 625

Delivery

- Pneumatic plug
- Spindle with butterfly handle and traverse
- C-Storz coupling for filling
- GEKA-Water-Coupling for testing

In addition, all devices will be adapted to your application and equipped to your wishes from an extensive range of accessories. We will advise you on the selection and will support you to get your job perfectly done.

Service-line/house-connection (HC) test equipment

Leakage test set for HC- service line systems

With our leakage test set you do have everything what you need for **leakage tests according to DIN 4033, EN 1610 and other type of tests** or a leakage search. This system is constructed for different ranges of pipe diameter and orderable in three different sizes covering **DN 90 to DN 300**.

Because of the variable **multi-size test bag s** save a lot of time and space. You can place and transport a whole test system **easily and compact** in one transportation case.

The push bag is **very robust** and consequently **especially durable**. Furthermore, this is delivered with a safety-quick-release coupling to allow a **fast change** and guarantee a secure grip to the push hose or to prevent an unintentional release during the push through in the pipe. The push rod consists of a stable PA-pipe with an internal steel helix, which prevents kinking of the push hose.



Delivery

- 10 m push hose
- Fill and safety armatures for the test bag
- Fill and safety armatures for the flow-stop bag
- Two-piston foot pump
- Flow-stop bag
- Float
- Adapter for foot pump
- Transportcase



Versions

Order no.	Product
09920002	Leakage test set for HC- service-line systems, complete, DN 90-150
09920027	Leakage test set for HC- service-line systems, complete, DN 150-200
09920028	Leakage test set for HC- service-line systems, complete, DN 200-300

Accessories



Test hoses

Order no.	Product
09920109	2,50 m Test hose, PA, safety coupling type 21
09920065	5,00 m Test hose, PA, safety coupling type 21
09920006	10,00 m Test hose, PA, safety coupling type 21
09920105	15,00 m Test hose, PA, safety coupling type 21
09920066	20,00 m Test hose, PA, safety coupling type 21
09920067	30,00 m Test hose, PA, safety coupling type 21

Spareparts



Test-bag with all connections

Order no.	Product
09920003	Test-bag with all connections, DN 90 - 150
09920015	Test-bag with all connections, DN 150 - 200
09920016	Test-bag with all connections, DN 200 - 300



Push-bags with safety coupling

Order no.	Product
09920005	Push-bag with safety-coupling type 21, DN 90 - 160
09920013	Push-bag with safety-coupling type 21, DN 150 - 200
09920014	Push-bag with safety-coupling type 21, DN 200 - 300

Various parts



Order no.	Product
09920048	Glandnut for stuffing box
09920011	Gland for stuffing box
09920012	Locknut for stuffing box
09920053	O-Ring, DVGW ø 13 x 3 mm
09920019	MS-ring for stuffing box
09920069	Testhead 1 bar for watertest
09920007	Fill- and safety armature for leakage test set, DN 90-150
09920008	Fill- and safety armature for leakage test set, DN 90-150

MDA double-bag test system for inspection and pipe-cleaning openings

The MDA double-bag test system is used for leakage tests on service-lines/house connections from **DN 50 to DN 300**.

the special advantage of this system is usability on places which are difficult to access, for example inspection and pipe cleaning openings. In contrast to all other systems which fail in this situation the MDA™ double-bag test system is characterized by **high flexibility and easy bag-positioning**.

Further features of this system are:

- The **test with air**
- **Variable adaption** to the service line, caused by uncomplicated plug connections of the flow-stop bags



Versions

Order no.	Product
09920029	HC-MDA double-bag test system, DN 50-80
09920030	HC-MDA double-bag test system, DN 80-130
09920031	HC-MDA double-bag test system, DN 100-160
09920032	HC-MDA double-bag test system, DN 150-210
09920033	HC-MDA double-bag test system, DN 200-315

Delivery

- MDA test-bag with all connectors, 1,5 m fill hose and pull-eye
- 15 m push hose in the following lengths with safety coupling and plug type 26:
- Fill armature for the test bag, flow-stop bag and the testing area
- MDA flow-stop bag with safety-coupling type 26

Spareparts



MDA flow-stop bag

with safety coupling type 26

Order no.	Product
09920038	MDA single-bag for sewage, DN 50 - 80 mm
09920039	MDA single-bag for sewage, DN 80 - 130 mm
09920040	MDA single-bag for sewage, DN 100 - 160 mm
09920041	MDA single-bag for sewage, DN 150 - 210 mm
09920068	MDA single-bag for sewage, DN 200 - 315



PA-hoses with steel helix

with safety coupling type 26

Order no.	Product
09920034	5,00 m Push hose ø16 mm with safety-coupling
09920035	2,00 m Push hose ø16 mm with safety-coupling
09920036	1,00 m Push hose ø16 mm with safety-coupling
09920037	0,50 m Push hose ø16 mm with safety-coupling

MDA 1 bar - pipe joint test-bags/ double-bags

Order no.	Product
01100058	MDA 1 bar - pipe joint test-bag/ double-bag, DN 50 - 80
01100059	MDA 1 bar - pipe joint test-bag/ double-bag, DN 80 - 130
01100060	MDA 1 bar - pipe joint test-bag/ double-bag, DN 100 - 160
01100061	MDA 1 bar - pipe joint test-bag/ double-bag, DN 150 - 210
01100062	MDA 1 bar - pipe joint test-bag/ double-bag, DN 200 - 315
01100182	Surcharge hose extension for each additional meter



Transportcases

made of aluminium padded with foam inside

Order no.	Product
09920001	Transportcase, DN 90-150
02810211	Transportcase, DN 150-200 and DN 200-300

Sewer bags

The production and sale of flow-stop bags, flow-stop bags with passage, test and bypass bags is one of the core competences of the company Städtler+Beck. Our standard program includes the product spectrum of our partner, the company Sava from Slovenia.

Our product portfolio is complemented by our own productline which includes our manufacturing experience of many years. Special and custom developments remain the basis of our successful corporate philosophy.

All products fulfill highest quality and safety standards. These include the processing of high-quality natural and synthetic rubber compound, the reinforcement of the bags with a Rayon Kevlar fabric and the use of corrosion-resistant components such as fill couplings and eyelets.



MDA 1 bar - flow-stop bags from DN 80 to DN 300

Compared to conventional test and flow-stop bags has MDA - flow-stop bags significant advantages in the application:

- **Excellent sealing** by an innovative special rubber compound
- Absolut **tight fit** of the bags in the pressurized state
- **Extreme resistance**
- High flexibility and perfect bending characteristics by a conical (rugby) form
- Versions for district heating and chemical lines are available on request

A long series of tests with various public suppliers and customers underlines the high reliability of the new MDA-bag generation.



MDA 1 bar - flow-stop bags

with quick-release coupling type 26



Order no.	Product
01100147	MDA 1 bar - flow-stop bag, DN 50 - 80
01100153	MDA 1 bar - flow-stop bag, DN 80 - 130
01100148	MDA 1 bar - flow-stop bag, DN 100 - 160
01100051	MDA 1 bar - flow-stop bag, DN 150 - 210
01100164	MDA 1 bar - flow-stop bag, DN 200 - 315

MDA 1 bar - push-bags

with ball valve, gauge and 1,5 m push hose



Order no.	Product
01100266	push-bag, 3/4 - 1 1/4"
01100267	push-bag, 1 1/2 - 2 1/2"
01100063	MDA 1 bar - push-bag, DN 50-80 mm
01100064	MDA 1 bar - push-bag, DN 80-130 mm
01100065	MDA 1 bar - push-bag, DN 100-160 mm
01100066	MDA 1 bar - push-bag, DN 150-210 mm
01100067	MDA 1 bar - push-bag, DN 200-315 mm
01100068	MDA 1 bar - push-bag, DN 315-500 mm



MDA 1 bar - test-bags

with quick-release coupling type 26

Order no.	Product
01100053	MDA 1 bar - test-bag with passage, DN 50 - 80
01100054	MDA 1 bar - test-bag with passage, DN 80 - 130
01100055	MDA 1 bar - test-bag with passage, DN 100 - 160
01100056	MDA 1 bar - test-bag with passage, DN 150 - 210
01100057	MDA 1 bar - test-bag with passage, DN 200 - 315



MDA 1 bar - push test-bags

with ball valve, gauge, 1,5 m push hose and quick-release coupling type 26

Order no.	Product
01100069	MDA 1 bar - push test-bag, DN 50-80 mm
01100070	MDA 1 bar - push test-bag, DN 80-130 mm
01100071	MDA 1 bar - push test-bag, DN 100-160 mm
01100072	MDA 1 bar - push test-bag, DN 150-210 mm
01100073	MDA 1 bar - push test-bag, DN 200-315 mm
01100074	MDA 1 bar - push test-bag, DN 315-500 mm

MD-Multi-dimensional – flow-stop bags

Sewer bags are used for temporary flow-stopping of all round and egg-shaped profiles, pipes and openings. MD- flow-stop bags are made of high-quality rubber with fabric insert and correspond to the highest quality and safety standards.



Flow-stop bags



MD- flow-stop bags up to 2,5 bar - short series

Order no.	Product
09620118	MD- flow-stop bag, DN 20-33 mm
09620120	MD- flow-stop bag, DN 33-40 mm
09620122	MD- flow-stop bag, DN 46-52 mm
09620124	MD- flow-stop bag, DN 46-77 mm
09620126	MD- flow-stop bag, DN 71-77 mm
09620128	MD- flow-stop bag, DN 71-102 mm
09620130	MD- flow-stop bag, DN 86-102 mm
09620132	MD- flow-stop bag, DN 86-153 mm
09620134	MD- flow-stop bag, DN 143-153 mm
09620136	MD- flow-stop bag, DN 143-204 mm
09620138	MD- flow-stop bag, DN 175-204 mm
09620140	MD- flow-stop bag, DN 219-254 mm
09620142	MD- flow-stop bag, DN 275-305 mm
09630202	Conversion kit Schrader valve to quick-release coupling type 26



MD- flow-stop bags up to 2,5 bar

Order no.	Product
09620149	MD- flow-stop bag, DN 40 - 70
09620151	MD- flow-stop bag, DN 70 - 150
09620153	MD- flow-stop bag, DN 100 - 200
09620147	MD- flow-stop bag, DN 150 - 200
09620155	MD- flow-stop bag, DN 150 - 300
09620157	MD- flow-stop bag, DN 200 - 400
09620159	MD- flow-stop bag, DN 300 - 525
09620161	MD- flow-stop bag, DN 350 - 600
09620163	MD- flow-stop bag, DN 375 - 750
09620165	MD- flow-stop bag, DN 500 - 800
09620167	MD- flow-stop bag, DN 500 - 1000
09620169	MD- flow-stop bag, DN 600 - 1200
09620171	MD- flow-stop bag, DN 750 - 1500
09620173	MD- flow-stop bag, DN 800 - 1800



MD- flow-stop bags up to 2,5 bar, made of a special rubber compound, short design

high oil and chemical resistance

Order no.	Product
09620001	MD- flow-stop bag, 2.5 bar, oil resistant, DN 20-33 mm
09620003	MD- flow-stop bag, 2.5 bar, oil resistant, DN 33-40 mm
09620061	MD- flow-stop bag, 2,5 bar, oil-resistant, DN 40-70 mm
09620005	MD- flow-stop bag, 2.5 bar, oil resistant, DN 46-52 mm
09620087	MD- flow-stop bag, 2,5 bar, oil-resistant, DN 46-77 mm
09620007	MD- flow-stop bag, 2.5 bar, oil resistant, DN 71 - 77 mm
09620089	MD- flow-stop bag, 2,5 bar, oil-resistant, DN 71-102 mm
09620063	MD- flow-stop bag, 2,5 bar, oil-resistant, DN 70-150 mm
09620009	MD- flow-stop bag, 2.5 bar, oil-resistant, DN 86-102 mm
09620011	MD- flow-stop bag, 2.5 bar, oil-resistant, DN 86-153 mm
09620013	MD- flow-stop bag, 2.5 bar, oil-resistant, DN 143-153 mm
09620015	MD- flow-stop bag, 2.5 bar, oil-resistant, DN 143-204 mm
09620307	MD- flow-stop bag, 2.5 bar, oil resistant, Dm. 175-204 mm
09620017	MD- flow-stop bag, 2.5 bar, oil-resistant, DN 219-254 mm
09620019	MD- flow-stop bag, 2.5 bar, oil-resistant, DN 275-305 mm
09630202	Conversion kit Schrader valve to quick-release coupling type 26



MD- flow-stop bags made of a special compound

high oil and chemical resistance

Order no.	Product
09620051	MD- flow-stop bag, 2,5 bar, oil-resistant, DN 100 - 200
09620053	MD- flow-stop bag, 2,5 bar, oil-resistant, DN 150 - 300
09620055	MD- flow-stop bag, 2,5 bar, oil-resistant, DN 200 - 400
09620065	MD- flow-stop bag, 2,5 bar, oil-resistant, DN 300 - 525
09620057	MD- flow-stop bag, 2,5 bar, oil-resistant, DN 350 - 600
09620067	MD- flow-stop bag, 2,5 bar, oil-resistant, DN 375 - 750
09620069	MD- flow-stop bag, 2,5 bar, oil-resistant, DN 500 - 800
09620081	MD- flow-stop bag, 2,5 bar, oil-resistant, DN 500 - 1000
09620083	MD- flow-stop bag, 2,5 bar, oil-resistant, DN 600 - 1200



MD- flow-stop bags up to 1,5 bar, egg/pillow-shaped

Order no.	Product
09630021	MD- flow-stop bag, egg-shaped, DN 200/300 to DN 250/375
09630023	MD- flow-stop bag, egg-shaped, DN 300/400 to DN 350/525
09630025	MD- flow-stop bag, pillow-shaped, DN 400/600 to DN 600/900
09630027	MD- flow-stop bag, pillow-shaped, DN 700/1050 to DN 800/1200
09630029	MD- flow-stop bag, pillow-shaped, DN 900/1350 to DN 1000/1500
09630043	MD- flow-stop bag with passage, pillow-shaped, DN 1200/1800 - 1400/2100



MD- high pressure flow-stop bags up to 6 bar

Order no.	Product
09620071	MD- high pressure flow-stop bag, 6,0 bar, DN 100 - 150
09620073	MD- high pressure flow-stop bag, 6,0 bar, DN 150 - 200
09620075	MD- high pressure flow-stop bag, 6,0 bar, DN 200 - 300
09620077	MD- high pressure flow-stop bag, 6,0 bar, DN 350 - 500
09620079	MD- high pressure flow-stop bag, 6,0 bar, DN 500 - 600



MD- high pressure flow-stop bags 12 bar

Order no.	Product
09620097	MD- high pressure flow-stop bag, 12,0 bar, DN 100 - 125
09620099	MD- high pressure flow-stop bag, 12,0 bar, DN 150
09620101	MD- high pressure flow-stop bag, 12,0 bar, DN 200 - 250
09620103	MD- high pressure flow-stop bag, 12,0 bar, DN 300 - 350
09620105	MD- high pressure flow-stop bag, 12,0 bar, DN 400
09620107	MD- high pressure flow-stop bag, 12,0 bar, DN 500



MD- flow-stop bags up to 2,5 bar with eyelets on both sides

Order no.	Product
09620021	MD- flow-stop bag, DN 100 - 200
09620023	MD- flow-stop bag, DN 150 - 300
09620025	MD- flow-stop bag, DN 200 - 400
09620027	MD- flow-stop bag, DN 300 - 525
09620029	MD- flow-stop bag, DN 350 - 600
09620031	MD- flow-stop bag, DN 375 - 750
09620033	MD- flow-stop bag, DN 500 - 800
09620035	MD- flow-stop bag, DN 500 - 1000
09620047	MD- flow-stop bag, DN 600 - 1200
09620049	MD- flow-stop bag, DN 750 - 1500



MD- flow-stop bags for large/egg-shaped profiles

Order no.	Product
09620037	MD- flow-stop bag, 1,0 bar, large profile/egg-shaped,DN 600 - 1000
09620039	MD- flow-stop bag, 1,0 bar, large profile/egg-shaped,DN 800 - 1200
09620041	MD- flow-stop bag, 1,0 bar, large profile/egg-shaped,DN 1200 - 1600
09620043	MD- flow-stop bag, 1,0 bar, large profile/egg-shaped,DN 1600 - 2000
09620045	MD- flow-stop bag, 1,0 bar, large profile/egg-shaped,DN 1900 - 2200
09620059	MD- flow-stop bag, 1,0 bar, large profile/egg-shaped,,DN 2400 - 2500



Jumbo flow-stop bag

Order no.	Product
09670030	Jumbo flow-stop bag, DN 400 - DN 1000
09670031	Jumbo flow-stop bag, DN 600 - DN 1500
09670032	Jumbo Absperrblase, DN 700 - DN 2000
09670033	Jumbo flow-stop bag, DN 900 - DN 2400

Passage and Bypass flow-stop bags



MD- passage/test/bypass flow-stop bags up to 2,5 bar - short design

Order no.	Product
09630121	MD- flow-stop bag, with passage 1/8", length 110 mm, DN 46-52 mm
09630123	MD- flow-stop bag, with passage 1/2", length 115 mm, DN 71-77 mm
09630125	MD- flow-stop bag, with passage 1/2", length 130 mm, DN 71-102 mm
09630127	MD- flow-stop bag, with passage 1/2", length 175 mm, DN 86-102 mm
09630129	MD- flow-stop bag, with passage 1/2", length 195 mm, DN 86-153 mm
09630131	MD- flow-stop bag, with passage 1", length 220 mm, DN 143-153 mm
09630133	MD- flow-stop bag, with passage 1", length 250 mm, DN 143-204 mm
09630193	MD Absperlblase, mit Durchgang 2", Länge 285 mm, DN 175-204
09630194	MD Absperlblase, mit Durchgang 2", Länge 345 mm
09630135	MD- flow-stop bag, with passage 2", length 395 mm, DN 275-305 mm
09630202	Conversion kit Schrader valve to quick-release coupling type 26
09630236	Connector bypass for short design, Ø 46-52 mm, 1/8"
09630237	Connector bypass for short design, Ø 71-153 mm, 1/2"
09630238	Connector bypass for short design, Ø 143-204 mm, 1"
09630239	Connector bypass for short design, Ø 175-305 mm, 2"



MD- passage/test/bypass flow-stop bags up to 2,5 bar

Order no.	Product
09630137	MD- flow-stop bag, with passage 1/2", DN 70 - 150
09630229	MD- flow-stop bag, with passage 1", DN 150 - 200
09630139	MD- flow-stop bag, with passage 1", DN 100 - 200
09630141	MD- flow-stop bag, with passage 1", DN 150 - 300
09630143	MD- flow-stop bag, with passage 2", DN 200 - 400
09630145	MD- flow-stop bag, with passage 2", DN 300 - 525
09630147	MD- flow-stop bag, with passage 2", DN 350 - 600
09630149	MD- flow-stop bag, with passage 2", DN 375 - 750
09630151	MD- flow-stop bag, with passage 2", DN 500 - 800
09630153	MD- flow-stop bag, with passage 2", DN 500 - 1000
09630155	MD- flow-stop bag, with passage 4", DN 600 - 1200
09630157	MD- flow-stop bag, with passage 4", DN 750 - 1500
09630159	MD- flow-stop bag, with passage 4", DN 800 - 1800

MD-flow-stop bags with passage up to 2,5 bar

with larger passage



Order no.	Product
09630088	MD-flow-stop bag with 2" passage, DN 100-150
09630090	MD-flow-stop bag with 3" passage incl. alu-flange 2", DN 150-250
09630019	MD-flow-stop bag with 2" passage incl. alu-flange 2", DN 150-300
09630092	MD-flow-stop bag with 4" passage incl. alu-flange 2", DN 200-300
09630106	MD-flow-stop bag with 4" passage incl. alu-flange 2", DN 200-400
09630082	MD-flow-stop bag with 4" passage, DN 200-400
09630094	MD-flow-stop bag with 6" passage incl. alu-flange 4", DN 300-525
09630107	MD-flow-stop bag with 6" passage incl. alu-flange 6", DN 300-525
09630108	MD-flow-stop bag with 6" passage incl. alu-flange 4", DN 350-600
09630084	MD-flow-stop bag with 6" passage incl. alu-flange 6", DN 350-600
09630109	MD-flow-stop bag with 8" passage incl. alu-flange 4", DN 500-1000
09630110	MD-flow-stop bag with 8" passage incl. alu-flange 6", DN 500-1000
09630086	MD-flow-stop bag with 8" passage incl. alu-flange 8", DN 500-1000
09630096	MD-flow-stop bag with 6" passage, DN 600-1200
09630098	MD-flow-stop bag with 8" passage, DN 600-1200
09630100	MD-flow-stop bag with 6" passage, DN 750-1500
09630102	MD-flow-stop bag with 8" passage, DN 750-1500
09630111	MD-flow-stop bag with 6" passage incl. alu-flange 6", DN 800-1800
09630104	MD-flow-stop bag with 8" passage, DN 800-1800

MD- flow-stop bags up to 2,5 bar, short design and made of a special rubber compound

high oil and chemical resistance



Order no.	Product
09630223	MD- flow-stop bag with passage, oil-resistant, DN 46 - 52
09630001	MD- flow-stop bag with passage, oil-resistant, DN 71 - 77
09630003	MD- flow-stop bag with passage, oil-resistant, DN 71 - 102
09630005	MD- flow-stop bag with passage, oil-resistant, DN 86 - 102
09630007	MD- flow-stop bag with passage, oil-resistant, DN 86 - 153
09630009	MD- flow-stop bag with passage, oil-resistant, DN 143 - 153
09630011	MD- flow-stop bag with passage, oil-resistant, DN 143 - 204
09630013	MD- flow-stop bag with passage, oil-resistant, DN 175 - 204
09630015	MD- flow-stop bag with passage, oil-resistant, DN 219 - 254
09630017	MD- flow-stop bag with passage, oil-resistant, DN 275 - 305
09630202	Conversion kit Schrader valve to quick-release coupling type 26
09630236	Connector bypass for short design, Ø 46-52 mm, 1/8"
09630237	Connector bypass for short design, Ø 71-153 mm, 1/2"
09630238	Connector bypass for short design, Ø 143-204 mm, 1"
09630239	Connector bypass for short design, Ø 175-305 mm, 2"

MD- passage/test/bypass bags up to 2,5 bar, made of a special rubber compound

high oil and chemical resistance



Order no.	Product
09630052	MD- flow-stop bag with passage, oil-resistant, DN 100 - 200
09630054	MD- flow-stop bag with passage, oil-resistant, DN 150 - 300
09630056	MD- flow-stop bag with passage, oil-resistant, DN 200 - 400
09630058	MD- flow-stop bag with passage, oil-resistant, DN 300 - 525
09630062	MD- flow-stop bag with passage, oil-resistant, DN 350 - 600
09630064	MD- flow-stop bag with passage, oil-resistant, DN 375 - 750
09630060	MD- flow-stop bag with passage, oil-resistant, DN 500 - 800
09630076	MD- flow-stop bag with passage, oil resistant, DN 500 - 1000
09630078	MD- flow-stop bag with passage, oil resistant, DN 600 - 1200

MD- passage/test/bypass bags up to 1,5 bar for egg-shaped profiles

Order no.	Product
09630031	MD- flow-stop bag with passage, pillow-shaped, DN 200/300 - 250/375
09630033	MD- flow-stop bag with passage, pillow-shaped, DN 300/450 - 350/525
09630035	MD- flow-stop bag with passage, pillow-shaped, DN 400/600 - 500/750
09630037	MD- flow-stop bag with passage, pillow-shaped, DN 700/1050 - 800/1200
09630039	MD- flow-stop bag with passage, pillow-shaped, DN 900/1350 - 1000/1500
09630041	MD- flow-stop bag, pillow-shaped, DN 1200/1800 to DN 1400/2100

MD- passage/test/bypass bags for large/egg-shaped profiles up to 1,0 bar

Large profile/egg-shaped test bladder (pillow-shaped) 0.5 bar to 1.0 bar - from DN 600 to DN 2200

- Penetration 2", manhole passable

Order no.	Product
09630066	MD- flow-stop bag for large/egg-shaped profiles with passage 2", DN 600 - 1000
09630068	MD- flow-stop bag for large/egg-shaped profiles with passage 2", DN 800 - 1200
09630070	MD- flow-stop bag for large/egg-shaped profiles with passage 2", DN 1200 - 1600
09630072	MD- flow-stop bag for large/egg-shaped profiles with passage 2", DN 1600 - 2000
09630074	MD- flow-stop bag for large/egg-shaped profiles with passage 2", DN 1900 - 2200
09630219	MD- flow-stop bag for large/egg-shaped profiles with passage 2", DN 2400 - 2500

Accessories for MD- passage/test/bypass bags

Couplings, hoses, valves



Order no.	Product
09640008	1" Bypass hose, D-Storz couplings on both sides, 10,00 m
09640013	2" Bypass hose, C-Storz couplings on both sides, 10,00 m
09630045	D-Storz blind coupling
09630046	C-Storz blind coupling
09630232	1" Shut-off armature with ball valve, D-Storz coupling
09630233	2" Shut-off armature with ball valve, D-Storz coupling
00800191	10 m fill-hose with plug and coupling type 26

Adapter



Order no.	Product
09630207	Adapter C-Storz coupling to GEKA-Water-Coupling
09300195	Adapter GEKA-Water-Coupling to quick-release coupling type 26
01000006	C-Storz coupling to B-Storz coupling

Pump



Order no.	Product
01000005	Double piston foot pump with gauge

Fill and safety armatures, attachment leach



Order no.	Product
09620179	Fill and safety armature, 1,0 bar
09620175	Fill and safety armature, 1,5 bar
09620176	Fill and safety armature, 2,5 bar
09620177	Fill and safety armature, 6,0 bar
09620178	Fill and safety armature, 12,0 bar
09620180	8,00 m Safety and attachment leach for MD- flow-stop bags

Expansionsets as bag test set

Order no.	Product
09640001	Expansionsets as bag test set for leakage test with water
09640002	Expansionsets as bag test set for leakage test with air
09640003	Expansionsets as bag test set for leakage test with water and air

S+B MD-Multi-dimensional – flow-stop bags

Sewer bags are used for temporary flow-stopping of all round and egg-shaped profiles, pipes and openings. MD- flow-stop bags are made of high-quality rubber with fabric insert and correspond to the highest quality and safety standards.

S+B MD- flow-stop bags

S+B MD- flow-stop bags up to 1,5 bar



Order no.	Product
00000060	S+B RV, DN 80 - 200
00000063	S+B RV, DN 160 - 400
00000066	S+B RV, DN 20 - 35
00000068	S+B RV, DN 30 - 75
00000070	S+B RV, DN 350 - 600
00000073	S+B RV, DN 500 - 1000

S+B MD- flow-stop bags up to 1,5 bar, made of a special rubber compound high oil and chemical resistance



Order no.	Product
00000001	S+B RV, CR, DN 80 - 200
00000003	S+B RV, CR, DN 160 - 400
00000005	S+B RV, CR, DN 350 - 600
00000007	S+B RV, CR, DN 500 - 1000

S+B MD- flow-stop bags up to 1,5 bar, short design



Order no.	Product
00000076	S+B RV, DN 80 - 150
00000078	S+B RV, DN 160 - 250
00000009	S+B RV, DN 400 - 500

S+B test and bypass flow-stop bags



S+B MD- test/bypass flow-stop bag up to 2,5 bar - short design

Order no.	Product
00000080	S+B RAG, DN 100 - 200
00000081	S+B RAG, DN 200 - 400
00000082	S+B RAG, DN 350 - 500
00000083	S+B RAG, DN 500 - 750
00000087	S+B RAG, DN 600 - 1200
00000084	S+B RAG, DN 750 - 1000
00000085	S+B RAG, DN 1100 - 1300
00000086	S+B RAG, DN 1300 - 1500

S+B MD- flow-stop bags up to 4,0 bar

Order no.	Product
00000053	S+B RAGH, DN 100 - 200, 4,0 bar
00000054	S+B RAGH, DN 200 - 400, 4,0 bar
00000055	S+B RAGH, DN 350 - 500, 4,0 bar
00000056	S+B RAGH, DN 500 - 750, 4,0 bar
00000057	S+B RAGH, DN 750 - 1000, 4,0 bar
00000058	S+B RAGH, DN 1100 - 1300, 4,0 bar
00000059	S+B RAGH, DN 1300 - 1500, 4,0 bar

S+B MD- test/bypass flow-stop bags up to 2,5 bar



Order no.	Product
00000088	S+B RPG, DN 100 - 200
00000089	S+B RPG, DN 170 - 500
00000090	S+B RPG, DN 500 - 1000

Accessories

Replacement sealing for S+B RAG,

Order no.	Product
00000015	Replacement sealing for S+B RAG, DN 100 - 200
00000017	Replacement sealing for S+B RAG, DN 200 - 400
00000019	Replacement sealing for S+B RAG, DN 350 - 500
00000021	Replacement sealing for S+B RAG, DN 500 - 750
00000029	Replacement sealing for S+B RAG, DN 600 - 1000
00000023	Replacement sealing for S+B RAG, DN 750 - 1000
00000025	Replacement sealing for S+B RAG, DN 1100 - 1300
00000027	Replacement sealing for S+B RAG, DN 1300 - 1500

Replacement sealing for S+B RPG

Order no.	Product
00000037	Replacement sealing for S+B RAGH, DN 100-200
00000039	Replacement sealing for S+B RAGH, DN 200-400
00000041	Replacement sealing for S+B RAGH, DN 350-500
00000043	Replacement sealing for S+B RAGH, DN 500-750
00000045	Replacement sealing for S+B RAGH, DN 750-1000
00000047	Replacement sealing for S+B RAGH, DN 1100-1300
00000049	Replacement sealing for S+B RAGH, DN 1300-1500
00000051	Replacement sealing for S+B RAGH, DN 600- 1000

Replacement sealings for S+B RPG

Order no.	Product
00000031	Replacement sealing for S+B RPG DN 100-200
00000033	Replacement sealing for S+B RPG DN 170-500
00000035	Replacement sealing for S+B RPG DN 500-1000

Accessories

Pipe-cleaning equipment

Pipe cleaning balls

Our pipe-cleaning balls (grinded foam ball, type HM, medium porous skin) are wear-resistant and reliable in operations like filling, discharging, separating and drying of all kinds of pipes. They can be used for cleaning and removing of foreign bodies, soaking/wiping up water or separating different media during the pipeline operation.

The diameter of the balls should be selected 10-20% larger as the internal diameter of the pipe (by medium strength in hardness).

Our pipe-cleaning balls are water-resistant due their material characteristics.

The cleaning balls are orderable in two grades of hardness, RG200 medium strength and RG300 hard.

Custom versions are available on request.



RG200 medium strength

Order no.	Product
09850001	Pipe-cleaning ball, water-resistant, medium strength, ø 10
09850002	Pipe-cleaning ball, water-resistant, medium strength, ø 15
09850003	Pipe-cleaning ball, water-resistant, medium strength, ø 20
09850004	Pipe-cleaning ball, water-resistant, medium strength, ø 25
09850005	Pipe-cleaning ball, water-resistant, medium strength, ø 30
09850006	Pipe-cleaning ball, water-resistant, medium strength, ø 35
09850007	Pipe-cleaning ball, water-resistant, medium strength, ø 40
09850008	Pipe-cleaning ball, water-resistant, medium strength, ø 45
09850009	Pipe-cleaning ball, water-resistant, medium strength, ø 50
09850010	Pipe-cleaning ball, water-resistant, medium strength, ø 55
09850011	Pipe-cleaning ball, water-resistant, medium strength, ø 60
09850012	Pipe-cleaning ball, water-resistant, medium strength, ø 65
09850013	Pipe-cleaning ball, water-resistant, medium strength, ø 70
09850014	Pipe-cleaning ball, water-resistant, medium strength, ø 75
09850015	Pipe-cleaning ball, water-resistant, medium strength, ø 80
09850016	Pipe-cleaning ball, water-resistant, medium strength, ø 90
09850017	Pipe-cleaning ball, water-resistant, medium strength, ø 100
09850018	Pipe-cleaning ball, water-resistant, medium strength, ø 110
09850019	Pipe-cleaning ball, water-resistant, medium strength, ø 120
09850020	Pipe-cleaning ball, water-resistant, medium strength, ø 135
09850045	Pipe-cleaning ball, water-resistant, medium strength, ø 140
09850021	Pipe-cleaning ball, water-resistant, medium strength, ø 150
09850022	Pipe-cleaning ball, water-resistant, medium strength, ø 160
09850023	Pipe-cleaning ball, water-resistant, medium strength, ø 170
09850046	Pipe-cleaning ball, water-resistant, medium strength, ø 180
09850037	Pipe-cleaning ball, water-resistant, medium strength, ø 185
09850035	Pipe-cleaning ball, water-resistant, medium strength, ø 190
09850025	Pipe-cleaning ball, water-resistant, medium strength, ø 200
09850026	Pipe-cleaning ball, water-resistant, medium strength, ø 210
09850027	Pipe-cleaning ball, water-resistant, medium strength, ø 220

09850028	Pipe-cleaning ball, water-resistant, medium strength, ø 235
09850029	Pipe-cleaning ball, water-resistant, medium strength, ø 270
09850030	Pipe-cleaning ball, water-resistant, medium strength, ø 325
09850031	Pipe-cleaning ball, water-resistant, medium strength, ø 370
09850032	Pipe-cleaning ball, water-resistant, medium strength, ø 420
09850036	Pipe-cleaning ball, water-resistant, medium strength, ø 470
09850033	Pipe-cleaning ball, water-resistant, medium strength, ø 520

RG300 hard



Order no.	Product
09860002	Pipe-cleaning ball, water-resistant, hard, ø 25
09860003	Pipe-cleaning ball, water-resistant, hard, ø 30
09860004	Pipe-cleaning ball, water-resistant, hard, ø 35
09860005	Pipe-cleaning ball, water-resistant, hard, ø 40
09860006	Pipe-cleaning ball, water-resistant, hard, ø 45
09860007	Pipe-cleaning ball, water-resistant, hard, ø 50
09860008	Pipe-cleaning ball, water-resistant, hard, ø 55
09860009	Pipe-cleaning ball, water-resistant, hard, ø 60
09860010	Pipe-cleaning ball, water-resistant, hard, ø 65
09860011	Pipe-cleaning ball, water-resistant, hard, ø 70
09860012	Pipe-cleaning ball, water-resistant, hard, ø 75
09860013	Pipe-cleaning ball, water-resistant, hard, ø 80
09860014	Pipe-cleaning ball, water-resistant, hard, ø 90
09860015	Pipe-cleaning ball, water-resistant, hard, ø 95
09860016	Pipe-cleaning ball, water-resistant, hard, ø 100
09860017	Pipe-cleaning ball, water-resistant, hard, ø 110
09860018	Pipe-cleaning ball, water-resistant, hard, ø 120
09860019	Pipe-cleaning ball, water-resistant, hard, ø 125
09860020	Pipe-cleaning ball, water-resistant, hard, ø 130
09860021	Pipe-cleaning ball, water-resistant, hard, ø 140
09860022	Pipe-cleaning ball, water-resistant, hard, ø 150
09860023	Pipe-cleaning ball, water-resistant, hard, ø 160
09860024	Pipe-cleaning ball, water-resistant, hard, ø 170
09860025	Pipe-cleaning ball, water-resistant, hard, ø 190
09860026	Pipe-cleaning ball, water-resistant, hard, ø 200
09860027	Pipe-cleaning ball, water-resistant, hard, ø 250
09860028	Pipe-cleaning ball, water-resistant, hard, ø 290

GAS

- + Hot tapping and bag-positioning devices
- + Flow-stop bags
- + Service line-locksystems
- + Stopple technology – 8 bar

SEWAGE

- + Project consultation
- + Product training and seminars
- + Pipe joint tester
- + Test and stop-off bags
- + Service-line test equipment
- + Measurement technology for leakage tests



Städtler + Beck
Hot Tapping and Line Stopping
Technology

Gas | Sewage

Städtler + Beck GmbH

Alter Postweg 1
D-67346 Speyer

phone: +49 (0) 6232. 3189-0
fax: +49 (0) 6232. 3189-20

e-mail: vertrieb@subgas.de
technik@subgas.de

web: www.subgas.de